

!!! Phased-out product !!! The preferred successor is 3RQ2000-2BW00. Coupling relays in industrial enclosure 2 change-over contacts Wide voltage range 24 V to 240 V AC/DC Spring-type terminal



Figure similar

Product brand name	SIRIUS
Product designation	Coupling relay in industrial enclosure
Product type designation	3RS18

General technical data	
Protection class IP	IP20
Switching behavior	monostable
Reference code acc. to DIN 40719 extended according to IEC 204-2 acc. to IEC 750	K
Reference code acc. to DIN EN 81346-2	K
Reference code acc. to DIN EN 61346-2	K
Control supply voltage 1 at AC	
• at 50 Hz	24 ... 240 V
• at 60 Hz	24 ... 240 V
Control supply voltage 1	
• at DC	24 ... 240 V
Design of the relay operating mechanism	poled
Product component Plug-in socket	No





Auxiliary circuit	
Number of NC contacts for auxiliary contacts	0
Number of NO contacts for auxiliary contacts	0
Number of CO contacts	
• for auxiliary contacts	2

Main circuit	
Type of voltage	AC/DC

Outputs	
Ampacity of the output relay at AC-15	
• at 250 V at 50/60 Hz	3 A
Ampacity of the output relay at DC-13	
• at 24 V	1 A
• at 125 V	0.2 A

Connections/ Terminals	
Type of electrical connection	spring-loaded terminals

Installation/ mounting/ dimensions	
Mounting type	screw and snap-on mounting onto 35 mm standard mounting rail
Height	94 mm
Width	22.5 mm
Depth	91 mm

Certificates/ approvals		
General Product Approval	Declaration of Conformity	Test Certificates
 CCC	 UL	
	 EG-Konf.	Miscellaneous
		Miscellaneous

other

[Confirmation](#)

Further information
Information- and Downloadcenter (Catalogs, Brochures,...) www.siemens.com/sirius/catalogs
Industry Mall (Online ordering system) https://mall.industry.siemens.com/mall/en/en/Catalog/product?mlfb=3RS1800-2BW00
Cax online generator http://support.automation.siemens.com/WW/CAXorder/default.aspx?lang=en&mlfb=3RS1800-2BW00

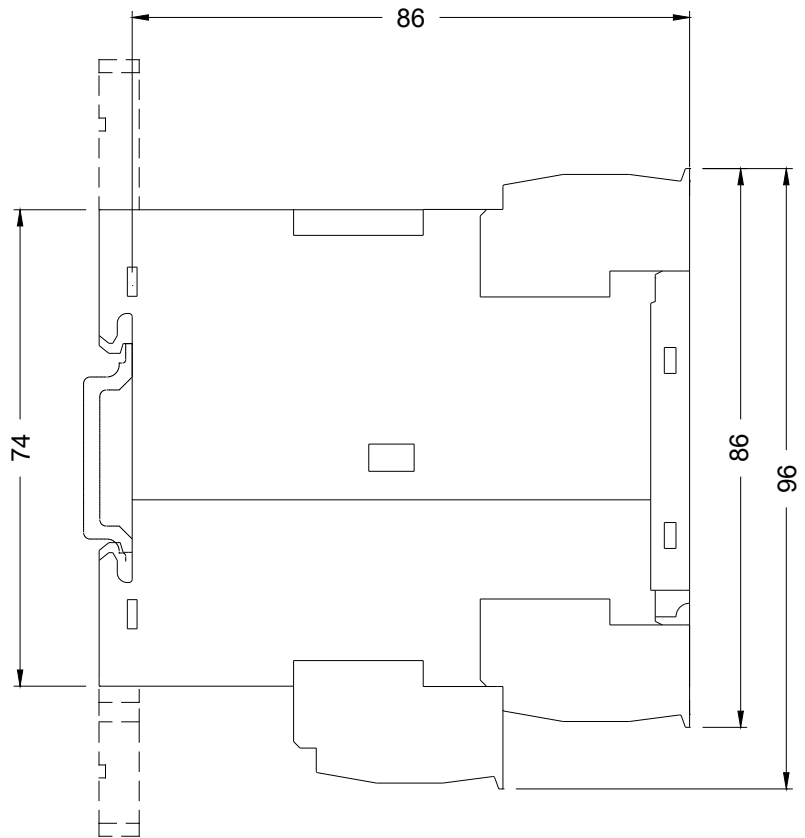
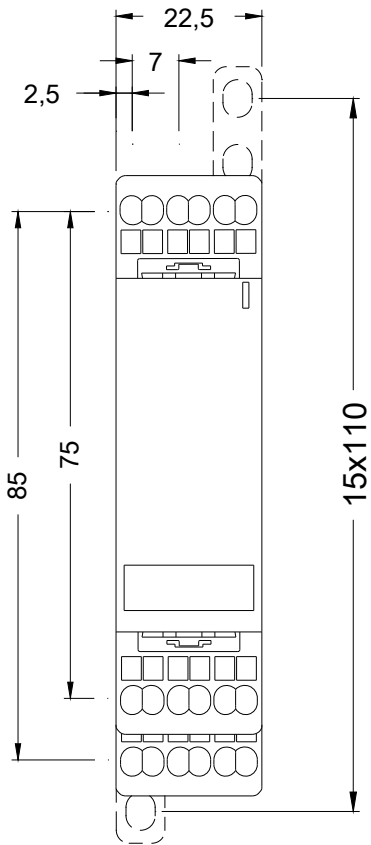

last modified:

09/04/2019