

sygonix®

GB Operating instructions

Remote Wall Switch, white color

Item no. 1761747

Up-to-date Operating Instructions

Download the latest operating instructions at www.conrad.com/downloads or scan the QR code shown. Follow the instructions on the website.



Explanation of Symbols



The symbol with the lightning in the triangle is used if there is a risk to your health, e.g. due to an electric shock.



The symbol with the exclamation mark in the triangle is used to indicate important information in these operating instructions. Always read this information carefully.



The arrow symbol indicates special information and advice on operation.



This product must only be used in dry, enclosed indoor areas. It must not become damp or wet, as this may result in a fatal electric shock!

Delivery Content

- Remote wall switch
- Battery 12 V/23 A
- Operating instructions



Intended Use

This 2-channel wireless wall switch is designed to turn on and off two appropriate receivers (e.g. wireless power socket, wireless outdoor socket, wireless inbuilt switch etc.). In addition, this 2-channel wireless wall switch has a dimming function (for example, to control a wireless plug-in dimmer, wireless inbuilt dimmer etc.).

For each control channel, a maximum of 10 receivers can be programmed.

The wireless wall switch is powered by a 12 V battery (type: 23A).

It is intended for indoor use only. Do not use it outdoors. Contact with moisture, e.g. in bathrooms, must be avoided under all circumstances.

For safety and approval purposes, you must not rebuild and/or modify this product. If you use the product for purposes other than those described above, the product may be damaged. In addition, improper use can result in short circuits, fires, electric shocks or other hazards. Read the instructions carefully and store them in a safe place. Make this product available to third parties only together with its operating instructions.

This product complies with the statutory national and European requirements. All company names and product names are trademarks of their respective owners. All rights reserved.

Safety Instructions



Read the operating instructions carefully and especially observe the safety information. If you do not follow the safety instructions and information on proper handling in this manual, we assume no liability for any resulting personal injury or damage to property. Such cases will invalidate the warranty/guarantee.



a) General

- The device is not a toy. Keep it out of the reach of children and pets.
- Do not leave packaging material lying around carelessly. This may become dangerous playing material for children.
- Protect the product from extreme temperatures, direct sunlight, strong jolts, high humidity, moisture, flammable gases, vapours and solvents.
- Do not place the product under any mechanical stress.
- If it is no longer possible to operate the product safely, take it out of operation and protect it from any accidental use. Safe operation can no longer be guaranteed if the product:
 - is visibly damaged,
 - is no longer working properly,
 - has been stored for extended periods in poor ambient conditions or
 - has been subjected to any serious transport-related stresses.
- Please handle the product carefully. Jolts, impacts or a fall even from a low height can damage the product.
- Check the product for damage before each use! If you notice any damage, do not use the product any longer! There is a risk of a life-threatening electric shock!
- Ensure that the insulation for the entire product is neither damaged nor destroyed. Never disassemble the product! There are no serviceable parts inside.
- Do not use this product in hospitals or medical institutions. Although the product emits only relatively weak radio signals, these may lead to the malfunction of life-support systems. The same may also be the case in other areas.

- Keep the product away from strong magnetic fields generated by machines, electric motors or loudspeakers.
- Consult an expert when in doubt about operation, safety or connection of the device.
- Maintenance, modifications and repairs are to be performed exclusively by an expert or at a qualified shop.
- If you have questions which remain unanswered by these operating instructions, contact our technical support service or other technical personnel.

b) Connected devices

- Also observe the safety and operating instructions of any other devices which are connected to the product.

c) Batteries

- Correct polarity must be observed while inserting the battery.
- The batteries should be removed from the device if it is not used for a long period of time to avoid damage through leaking. Leaking or damaged batteries might cause acid burns when in contact with skin, therefore use suitable protective gloves to handle corrupted batteries.
- Batteries must be kept out of reach of children. Do not leave batteries lying around, as there is risk, that children or pets swallow them.
- All batteries should be replaced at the same time. Mixing old and new batteries in the device can lead to battery leakage and device damage.
- Batteries must not be dismantled, short-circuited or thrown into fire. Never recharge nonrechargeable batteries. There is a risk of explosion!

Installation and Connection



The wireless wall switch is only intended for use in dry indoor locations.

- Carefully lift the front cover of the wireless wall switch (e.g. with a screw driver) and remove it (see picture on the right).
- Remove the mounting plate. The mounting plate for the wireless wall switch is fixed to the electronic part of the wireless wall switch with 4 clamps (see picture on the right).
- The mounting plate has two mounting holes (see the picture on the right). Remove the mounting plate and mark the mounting holes on the wall.
- Drill the holes.
- Attach the mounting plate to the wall, using suitable mounting material.
- Attach the electronic part of the wireless wall switch to the mounting plate.
- Insert a 12V-battery (type: 23A) in the battery compartment of the wireless wall switch, paying attention to the correct polarity.
- Attach the front plate to the wireless wall switch.

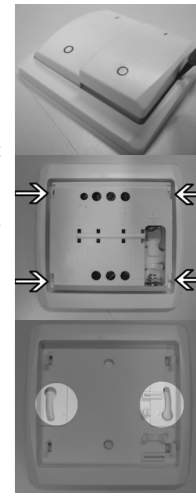

Programming a receiver for the wireless wall switch

→ For each control channel, a maximum of 10 receivers can be programmed.

- Set the receiver to the programming mode. Please follow these operating instructions when so doing.
- Press the desired "I" button on the wireless wall switch to which the receiver is to be programmed. The programming has been completed successfully.

Deleting programmed receivers from the wireless wall switch

- Press the buttons "I" and "O" on the wireless wall switch to which the receiver is programmed. The LED on the receiver starts flashing.
- Now press the button "O" on the wireless wall switch. The LED on the receiver goes out. The receiver has now been deleted from the wireless wall switch.

The wireless wall switch's dimmer function

- Turn on the dimmer, by briefly pressing the "I" button on the wireless wall switch once.
- Press the "I" button on the wall switch again. The dimmer function is activated.
- Press the "I" button on the wall switch again. The dimmer function is deactivated.

Start-up, Function Test

Commission the receiver in the correct way (follow the receiver's operating instructions).

By pressing the appropriate "I" or "O" button on the wireless wall switch, the receiver is turned on or off.

Transmission range

- The transmission range of the radio signals between the wireless wall switch and an appropriate receiver is up to 70 m under optimal conditions.

→ **This value, however, is the so-called "open space range" (range the transmitter and receiver are visible to each other, without interfering influences).**

In practical operation, however, there are walls, ceilings of rooms etc. between the transmitter and the receiver, which reduce the range accordingly.

Due to the different influences on the radio transmission, no specific range can be guaranteed.

However, trouble-free operation is usually possible in a detached house.

The range can sometimes be limited considerably by:

- Walls, reinforced concrete ceilings
- Coated/metallised insulated glass
- Proximity to metal & conducting objects (e.g. radiators)
- Proximity to human bodies

- Broadband interferences, e.g. in residential areas (DECT telephones, mobile phones, radio-controlled headphones, radio-controlled speakers, radio-controlled weather stations, baby phones etc.)
- Proximity to electric motors, transformers, power-supply units, computers
- The proximity to improperly shielded or uncovered operating computers or other electric appliances

Care and Cleaning



The product does not require any maintenance and should never be opened or disassembled for any reason.

- Only clean the product with a soft, clean, dry cloth.
- Never use aggressive cleaning agents or chemical solutions since these might damage the surface of the casing or impair the operation.

Declaration of Conformity (DOC)

Conrad Electronic SE, Klaus-Conrad-Straße 1, D-92240 Hirschau hereby declares that this product conforms to the 2014/53/EU directive.



Click on the following link to read the full text of the EU declaration of conformity: www.conrad.com/downloads

Select a language by clicking on a flag symbol and enter the product order number in the search box. You can then download the EU declaration of conformity in PDF format.

Disposal

a) Product



Electronic devices are recyclable waste and must not be disposed of in the household waste. At the end of its service life, dispose of the product in accordance with applicable regulatory guidelines.

Remove any inserted batteries and dispose of them separately from the product.

b) Batteries



You as the end user are required by law (Battery Ordinance) to return all used batteries. Disposing of them in the household waste is prohibited.

Contaminated batteries are labeled with this symbol to indicate that disposal in the domestic waste is forbidden. The designations for the heavy metals involved are: Cd = Cadmium, Hg = Mercury, Pb = Lead (name on batteries, e.g. below the trash icon on the left).

Used batteries can be returned to collection points in your municipality, our stores or wherever batteries are sold.

You thus fulfill your statutory obligations and contribute to the protection of the environment.

Technical Data

Power supply1x 12V battery, type "23A"

Transmission frequency.....433.05 - 434.79 MHz

Transmission power.....4.98 dBm

Transmission rangeUp to 70 m
(in open area, see chapter "Transmission range")

Internal LED.....Lights up briefly on the use of the buttons

Programmable receivera maximum of 10 for each control channel

Operating temperature0 to +35 °C

Dimensions (W x H x D)approx. 80 x 80 x 20 mm

Weightapprox. 48 g (excl. batteries)

This is a publication by Conrad Electronic SE, Klaus-Conrad-Str. 1, D-92240 Hirschau (www.conrad.com). All rights including translation reserved. Reproduction by any method, e.g. photocopy, microfilming, or the capture in electronic data processing systems require the prior written approval by the editor. Reprinting, also in part, is prohibited. This publication represent the technical status at the time of printing.

Copyright 2019 by Conrad Electronic SE. *1761747_V2_0819_02_mxs_m_en