

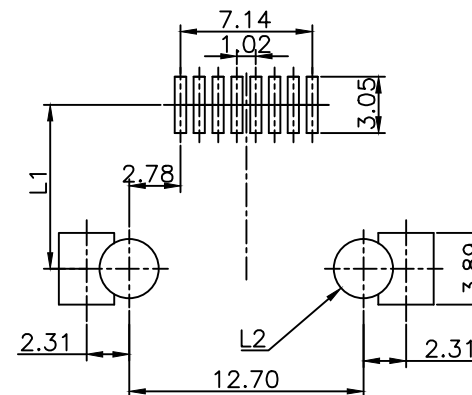

THIS IS A RoHS COMPLIANT COMPONENT/PRODUCT.

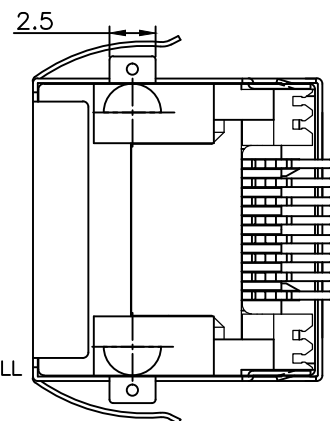
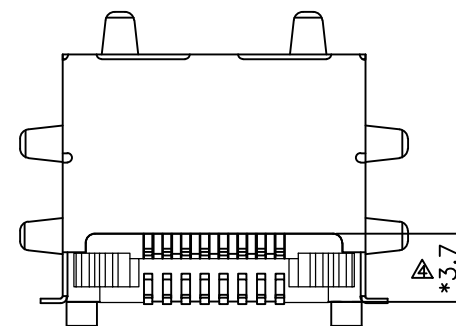
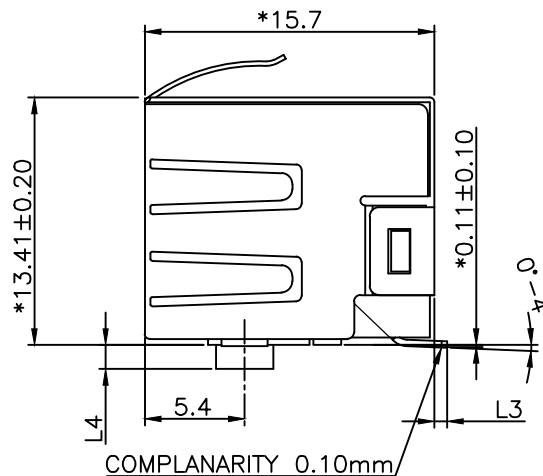
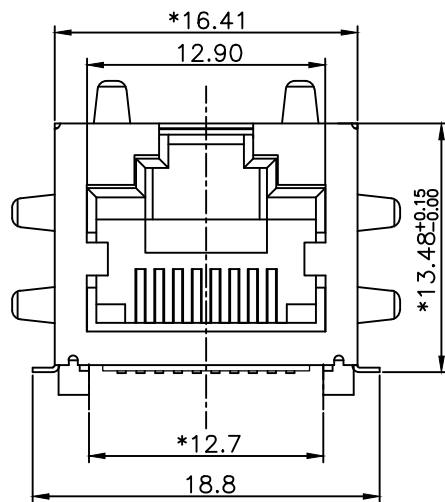

**NOTES:**

**ELECTRICAL:**

1. VOLTAGE RATING : 125 VAC.
2. CURRENT RATING : 1.5 AMP.
3. CONTACT RESISTANCE : 30 MILLIOHMS MAX.
4. INSULATION RESISTANCE: 1000 MEGOHMS MIN. @ 500 VDC.
5. DIELECTRIC STRENGTH : 1000 VAC 60Hz, 1MIN.

7. OPERATING: 750 CYCLES MIN.

**MECHANICAL:**

1. HOUSING MATERIAL : GLASS FILLED HIGH TEMP. UL94V-0.
2. INSERT MATERIAL : GLASS FILLED HIGH TEMP. UL94V-0.
3. SHIELD MATERIAL : COPPER ALLOY NICKEL PLATING FOR ALL. PLATING NICKEL 50u"MIN. FOR ALL.
4. CONTACT MATERIAL : PHOSPHOR BRONZE t=0.35 mm. UNDER PLATING:NICKEL PLATING 50~80u".OVERALL
5. PLATING : 6u" GOLD PLATING OVER NICKEL.
6. PCB RETENTION PRE-SOLDER : 1 LB MIN.
7. PCB RETENTION POST-SOLDER: 10 LBS MIN.

**ENVIRONMENTAL:**

1. STORAGE : -40°C TO +85°C.
2. OPERATION: -40°C TO +85°C.
3. IR REFLOW SOLDERING TEMPERATURE: 255°C TO 265°C (5~10 SECONDS)

MATES WITH MODULAR PLUG CONFORMING TO TIA-1096-A.

**ORDERING INFORMATION:**

PART NUMBER	PRODUCT CODE	CONFIGURATION
210I-0120-01	RJJS-88-I21-EJH-096	WITHOUT TABS. L1=8.89 L2=0.32 L3=0.6 L4=1.3
210I-0120-02	RJJS-88-SMT-WF	TOP AND SIDE TABS. L1=8.89 L2=0.32 L3=0.6 L4=1.3
210I-0120-03	RJJS-88-I23-EJH-096	WITHOUT TABS. L1=9.98 L2=0.325 L3=0.9 L4=1.78
210I-0120-04	RJJS-88-I24-EJH-096	TOP AND SIDE TABS. PEG DIP TYPE, L1=9.98 L2=0.32 L3=0.9 L4=1.78
210I-0120-06	RJJS-88-I25-EJH-096	TOP AND SIDE TABS. L1=8.89 L2=0.32 L3=0.6 L4=1.3
210I-0120-05	RJJS-88-SMT-WF1	TOP AND SIDE TABS, PEG DIP TYPE, BACK PEG 3.43 L1=9.98 L2=0.32 L3=0.6 L4=1.3

**UL** UL RECOGNIZED - FILE #E465899

△ X1		ADD NEW P/N	MORGAN	080114
△ X1		ADD NEW P/N	JACK	073114
△ X3		MODIFY DRAWING	JACK	061113
△ X2		ADD NEW P/N	JACK	060313
△ X0	0009000	REV. 9 TO REV. A	DORIS	053113

MARK	ECN-NO.	REVISION RECORD	DRAWN	DATE
		UNLESS OTHERWISE SPECIFIED TOLERANCE	SCALE	CHECKED
		Dimension Range Tolerance	3/1	
		X.X ±0.20 UNIT	mm	APPROVED
		X.XX ±0.15		
		X.XXX ±0.10	SIZE	A3
		ANGLE ±5°		SHEET 1/2
Material/Plated/Notes		NAME		
SEE NOTE		1X1 RJ45 W/O LED SMT JACK,STP		
Tooling No.		PART NO.	SEE NOTE	REV.
		DOC. NO.		E