

Peak power(WP) :	140W
Power tolerance:	±3%
Dimensions :	1710*505*35
Type of Cells:	Mono
Cell orientation:	36 cells
Maximum Power Voltage, Vmp:	18V
Maximum Power Current, Imp:	7.78A
Open Circuit Voltage, Voc:	21.6V
Short Circuit Current, Isc:	8.40A
Cells Conversion Efficiency:	18.40%
Maximum System Voltage:	1000VDC
Operating Temperature: -40°C to +85°C / -40°F to +185°F	
Standard Test Conditions, STC:	
Irradiance Level:	1000W/m ²
Spectrum:	AM 1.5
Cell Temperature:	25°C / 77°F

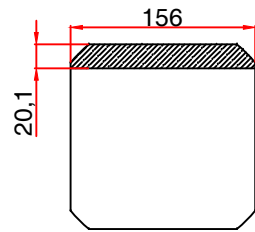

电池片损耗: 156*20.1

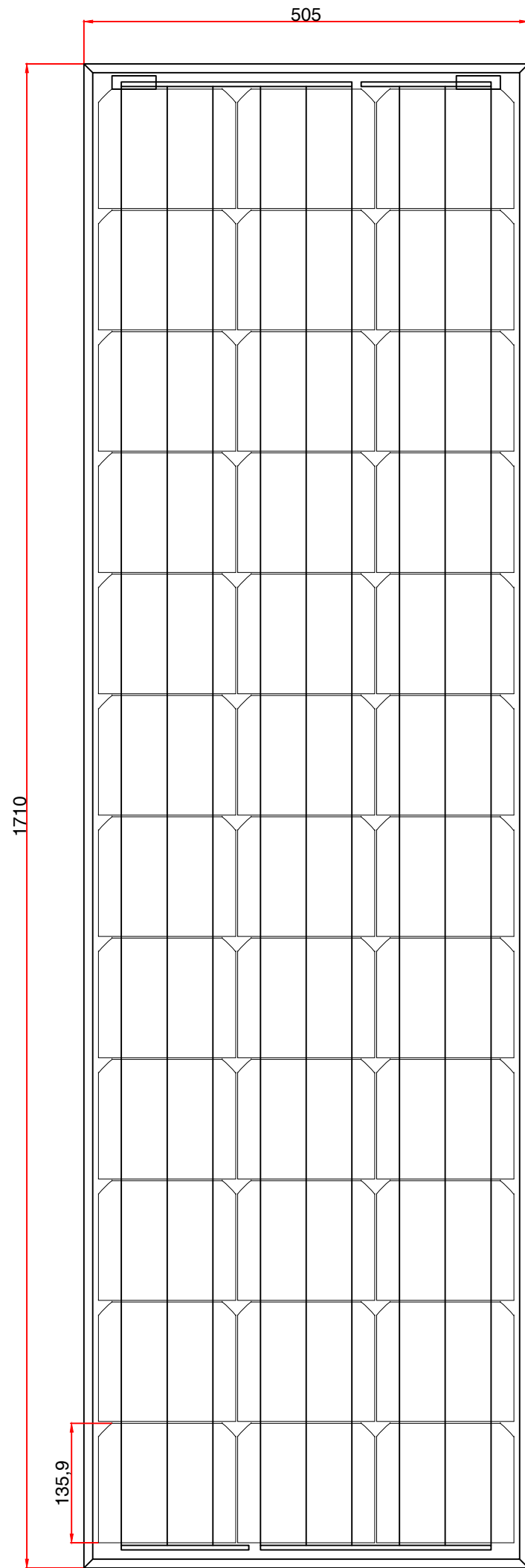

35

