

Warnings

The flashlight will get hot in Turbo mode quickly and discharge the battery by high current. Don't leave it without your attention as very bright light can heat objects and be a cause of the fire.

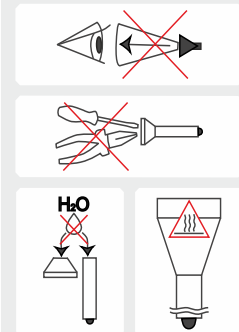

1. Always follow the instructions from this manual and recommendations on battery usage.
2. Apply only the recommended power sources.
3. Do not reverse battery polarity.
4. Do not use different power sources together, i.e. old ones with new ones, charged with discharged. Do not use different types of batteries combined as the element with less capacity can be damaged.
5. Do not modify or recast the flashlight and its components as it will deprive you of the warranty.
6. Do not allow water or any other liquid to leak into the flashlight.
7. Do not aim a switched-on flashlight at people's or animals' eyes – it can cause temporary blindness.
8. Do not allow children to use the flashlight without your assistance.

! The producer will not be liable for any harm done to the user if it was caused by improper use of the product.

Care and Storage

It is recommended to clean the threads and O-rings off dirt and old grease once or twice per year. Remember that reliable protection from water and dust cannot be provided by worn out sealing. The fouling as well as lack of lubricant cause fast wear-out of threads and sealing rings.

To clean the threads do the following:

1. Unscrew the tailcap and remove the sealing ring carefully with a toothpick (do not use sharp metal things as they can damage the ring).
2. Wipe the sealing ring thoroughly with a soft cloth (or tissue). Do not use solvents. If the sealing ring is worn out or damaged replace it by a new one.
3. Clean the metal threads with a brush using ethanol. Be careful not to allow the applied liquid to get inside the flashlight or tailcap as it can cause fails in functionality of the flashlight.

After cleaning lubricate the thread and the sealing ring with polyalphaolefin-based silica grease, e.g. Nyogel 760G. The application of automotive and other improper grease can cause swelling and damage of the sealing rings.

In case of active operation and exploitation in dusty environments, it is recommended to perform cleaning and lubricating of the parts as often as required.

Service and Warranty

Armytek provides free warranty repair for 10 years (excluding batteries, chargers, switches and connectors which have 2 years warranty) from the date of buy with the document confirming the purchase.

Guarantee does not extend to damage during:

1. Improper usage.
2. Attempts to modify or repair the flashlight by nonqualified specialists.
3. Longtime application in chlorinated or polluted water, or other liquids (other than water).
4. High temperatures and chemicals' exposure (including the exposure of liquid from defected batteries).
5. Usage of low-quality batteries.

Armytek Optoelectronics Inc.

Web: www.armytek.com Email: service@armytek.com
Address: 13-85 West Wilmot St, Richmond Hill, Ontario, L4B 1K7, Canada

Specifications are subject to change without notice.

Prime

THE MOST TECHNICALLY ADVANCED

USER MANUAL

Thank you for choosing the products of Armytek Optoelectronics Inc., Canada.
Please read this manual carefully before using the flashlight.

Specifications

Armytek Optoelectronics Inc. is a Canadian manufacturer that produces powerful and reliable flashlights designed especially for your needs. The components made in the USA and Japan. **10 years no-hassle warranty.**

- Superb light of amazing constant brightness due to powerful electronics and active temperature control without timers.
- Efficient TIR-optics and no "tunnel vision" effect even after continuous use.
- Warning Indication of low battery level and high temperature.
- Side switch for comfortable one-hand operation and easy modes switching.
- Ultra low current drain in OFF-state – more than 25 years.
- Removable clip, comfortable holster and possibility of tail-stand for multipurpose use.
- Compact and light-weight flashlight of guaranteed durability stands up harsh impacts and falling from 10 meters.
- Total protection from water, dirt and dust penetration – flashlight continues to work even at the depth of 10 meters.

Model	Prime A1	Prime A2	Prime C1	Prime C2	
LED / Optics	Cree XP-L or XM-L2 / TIR				
Brightness stabilization type	FULL (constant light)			DIGITAL (CPU brightness control)	
Light output, LED / OTF lumens*	600 / 500	850 / 700	800 / 650	1250 / 1050	
Peak beam intensity, candelas	3280	5080	4320	7560	
Hotspot / spill	20° / 80°				
Beam distance*	115 meters	143 meters	131 meters	174 meters	
Modes, light output (OTF lumens*) and runtimes (measured with Sanyo Eneloop AA 2000 mAh / Armytek CR123A 1500 mAh / Armytek 18650 Li-Ion 3400 mAh until the light output drops to 10% of the initial value)	Turbo	500 lm / 0.8h	700 lm / 0.8h	650 lm / 0.7h	1050 lm / 1.5h
	Main3	95 lm / 4.2h	95 lm / 8.3h	95 lm / 6.2h	410 lm / 3.8h
	Main2	34 lm / 11.7h	34 lm / 25h	34 lm / 18h	190 lm / 9h
	Main1	10 lm / 35h	10 lm / 75h	10 lm / 55h	32 lm / 48h
	Firefly2	2 lm / 8d	2 lm / 17d	2 lm / 13d	2.5 lm / 18d
	Firefly1	0.15 lm / 90d	0.15 lm / 200d	0.15 lm / 140d	0.4 lm / 100d
Power source	1xAA / 1x14500 Li-Ion	2xAA	1x18350 Li-Ion / 1xR123 Li-Ion / 1xCR123A	1x18650 Li-Ion / 2xCR123A / 2xR123 Li-Ion	
Size and weight (without batteries)	Length 103mm, body diameter 24.5mm, head diameter 24.5mm, weight 54g	Length 149mm, body diameter 24.5mm, head diameter 24.5mm, weight 58g	Length 87mm, body diameter 24.5mm, head diameter 24.5mm, weight 52g	Length 118mm, body diameter 24.5mm, head diameter 24.5mm, weight 56g	

* Light output for flashlights with Warm light are about 7% less, beam distances are about 3% less.

! We DO NOT RECOMMEND to use CR123A batteries as a power source for often and continuous flashlight's operation. Remember that old or low-quality disposal batteries can be damaged under heavy load and explode.

Set description

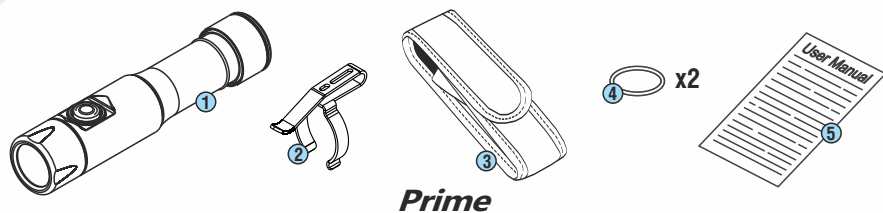

Prime

Items included in the package:

- 1 - Flashlight
- 2 - Clip
- 3 - Holster
- 4 - 2 spare O-rings
- 5 - User manual



- ✓ Your flashlight can inconsiderably differ from the pictures in the manual.
- ✓ The producer reserves the right to change the package at his own discretion without modifying this manual.

Initial Service

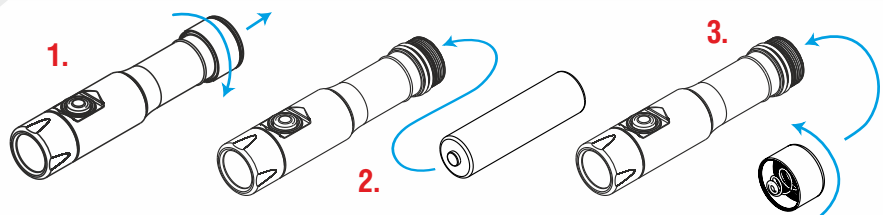

To set/replace batteries:

1. Unscrew the tailcap.
2. Place the batteries with the positive contact (+) facing the head of the flashlight.
3. Adjust the tailcap and tighten it as far as it can go.



We DO NOT RECOMMEND to leave power sources inside the flashlight for a long storage period, as batteries (especially, non-rechargeable) can leak for various reasons and damage the inner parts of the flashlight. If you want to keep your flashlight in a stand-by state with batteries in then use new and high-quality batteries and store the flashlight in acceptable for batteries operational temperature and revise the batteries' state at least once a month. If you have noticed any signs of batteries' defects then withdraw them from the flashlight and utilize. It is also recommended to replace discharged batteries with new ones before the storage as the chance of leakage is higher with discharged batteries.

Operation

In OFF state:

Click: To turn on the last used mode.

Press and hold: To go through 2 Firefly modes (release to select). Keeping button pressed will start cycling through the Main modes.

In ON state:

Click: To turn off the flashlight.

Press and hold: To start cycling through the Main modes.

Double click: To turn on the Turbo mode. The second double click brings back the last used mode.

For comfortable operation you have a convenient momentary access to all the following modes:

Press & Hold



OFF → Firefly1 → Firefly2

Firefly

Firefly. Press and hold the button in OFF-state to turn on the desired Firefly mode and then release immediately. Keeping the button pressed will start cycling through the Main modes.

Click x1



OFF → Main (if last used)

Main

Main. Short click from OFF-state activates the Main mode (if it was the last mode used previously).

Click x2



Any mode → Turbo
Turbo → Last mode

Turbo

Turbo. The mode is activated by double click in any mode. To return to the last mode make double-click again.

Press & Hold



Main1 → Main2
Main3

Cycling through Modes

Cycling through the Main modes. In ON-state press and hold the button (in any mode): the 3 Main modes will start switching cyclically. Release the button to select the desired mode. In Turbo mode it starts cycling through the Main modes.

Automemorizing. After switching off the last used Mode is memorized for quick 1-click access at next switching on.

Lock-out function. Unscrew the tailcap to 1/4 for the protection from accidental switching on.

Low Battery Indication



Low Battery Indication. If the brightness is <25% from the nominal value, the LED flashes 2 times ONCE (after 30sec from switching on). If you are not sure if it flashed or not switch the flashlight off and on: in case the battery is low flashes will repeat. Light output decreases to Firefly mode at critical level.

Active temperature control (Prime C2 only). The flashlight can quickly heat up in Turbo mode. When the temperature become +60°C – the brightness decreases by small steps. After cooling-down (provided that battery voltage is sufficient) the brightness increases to the Turbo mode again. This stepping goes cyclically to maintain the user's safety and the flashlight's functionality. In conditions of good air-cooling the flashlight delivers light without stepping down even in Turbo mode. There are no preset timers for stepping, but real-time active temperature measurements.