

**Industrial Ethernet  
IE-BHS-V14M-RJA-45**

**Weidmüller Interface GmbH & Co. KG**  
Klingenbergstraße 16  
D-32758 Detmold  
Germany  
Fon: +49 5231 14-0  
Fax: +49 5231 14-292083  
www.weidmueller.com



PushPull plug-in connector according to IEC  
61076-3-117 ver.14 (PROFINET), metal, RJ45 empty  
housing

**General ordering data**

|            |                                 |
|------------|---------------------------------|
| Type       | IE-BHS-V14M-RJA-45              |
| Order No.  | <a href="#">1296710000</a>      |
| Version    | Empty enclosure, Flange, angled |
| GTIN (EAN) | 4050118094831                   |
| Qty.       | 10 pc(s).                       |

**Industrial Ethernet  
IE-BHS-V14M-RJA-45**

**Weidmüller Interface GmbH & Co. KG**  
 Klingenbergstraße 16  
 D-32758 Detmold  
 Germany  
 Fon: +49 5231 14-0  
 Fax: +49 5231 14-292083  
 www.weidmueller.com

**Technical data****Dimensions and weights**

|            |          |
|------------|----------|
| Net weight | 81.659 g |
|------------|----------|

**Temperatures**

|                             |                |                             |        |
|-----------------------------|----------------|-----------------------------|--------|
| Operating temperature, max. | 70 °C          | Operating temperature, min. | -40 °C |
| Operating temperature       | -40 °C...70 °C | Storage temperature         |        |
| Installation temperature    |                |                             |        |

**Environmental Product Compliance**

|            |                |
|------------|----------------|
| REACH SVHC | Lead 7439-92-1 |
|------------|----------------|

**General data**

|                       |              |                   |                             |
|-----------------------|--------------|-------------------|-----------------------------|
| Housing main material | Zinc diecast | Protection degree | IP67                        |
| Seal material         | EPDM         | Type of mounting  | 2 screws, M3 (not included) |

**Standards**

|                         |         |
|-------------------------|---------|
| Certificate no. (cULus) | E316369 |
|-------------------------|---------|

**Classifications**

|            |             |            |             |
|------------|-------------|------------|-------------|
| ETIM 6.0   | EC001031    | eClass 6.2 | 27-25-05-04 |
| eClass 7.1 | 27-25-05-04 | eClass 8.1 | 19-17-01-25 |
| eClass 9.0 | 27-18-27-02 | eClass 9.1 | 27-18-27-02 |

**Approvals**

Approvals



|      |         |
|------|---------|
| ROHS | Conform |
|------|---------|

**Downloads**

|                    |  |
|--------------------|--|
| Brochure/Catalogue | <a href="#">CAT 9 IETH 15/16 EN</a><br><a href="#">FL FIELDWIRING EN</a><br><a href="#">PI PROFINET CABLING EN</a> |
| User Documentation | <a href="#">MAN IE GUIDE DE</a><br><a href="#">MAN IE GUIDE EN</a>   |

**Industrial Ethernet**  
**IE-BHS-V14M-RJA-45**

**Weidmüller Interface GmbH & Co. KG**  
Klingenbergstraße 16  
D-32758 Detmold  
Germany  
Fon: +49 5231 14-0  
Fax: +49 5231 14-292083  
www.weidmueller.com

**Drawings**

**Dimensioned drawing**

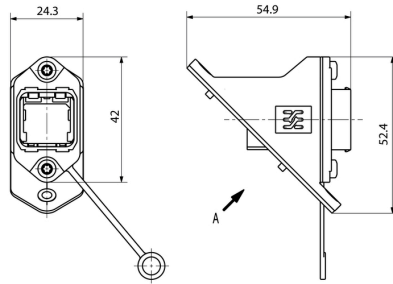

**Dimensioned drawing**

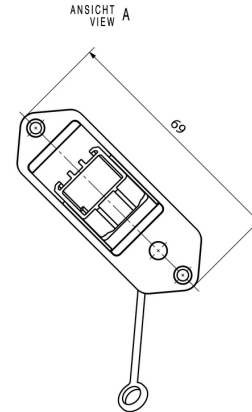

**Installation cut-out**

