

# Data Sheet

## TECHNICAL SPECIFICATIONS

### D-Sub Hood:

- Material: Zinc, Nickel Plated
- Operating Temperature: -45°C to + 105°C
- Cable Entry: Top Entry
- Thumbscrews: UNC 4-40 (Standard)
- Cable O.D:
  - 9-Way: Up to 9,5mm
  - 15-Way: Up to 12,5mm
  - 25-Way: Up to 12,5mm
  - 37-Way: Up to 15,5mm

### D-Sub High Density:

- Insulator: PBT, Black, UL94 V-0
- Shell: Stamped Steel, Tin Plated
- Contact pins: Copper Alloy
- Stamped & Formed pins: 100 inserts min
- Contacts Plating: Selective Gold over Nickel
- Operating Temperature: -55°C to +105°C
- Withstanding voltage: 500V for 1 minute
- Insulator resistance: 500MΩ min

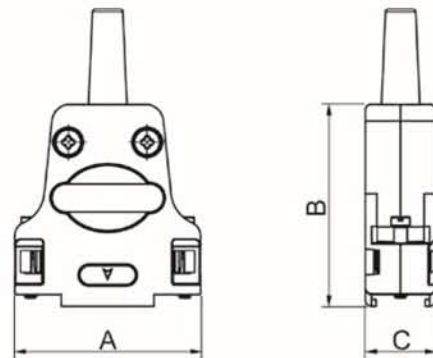

Size DTZF	Dim A	Dim B	Dim C
9-way	31,6	39,5	15,2
15-way	40,0	41,0	15,2
25-way	53,7	47,5	15,2
37-way	70,2	48,0	15,2