

3528 package SMD LED

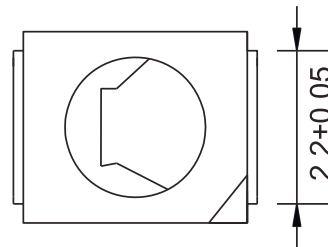
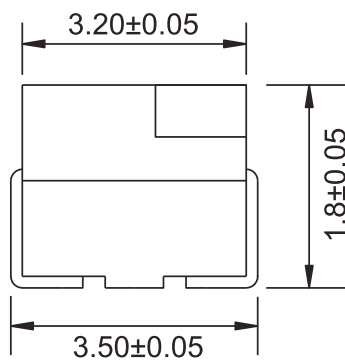

Achtung: Leuchtdioden müssen immer durch Vorwiderstand oder Konstantstromquelle strombegrenzt werden!

Attention: Do not drive LED without forward-current limitation (pre-resistor or constant current source)

Item number	00430371	00430372	00430373	00430374	00430375	00430376
Light Source	Red	Blue	Green	Yellow	Warm White	Cold White
Wavelength / color temperature	620-625nm	460-465nm	520-525nm	590-595nm	3000K	12000K
Max. Luminous intensity	300mcd	320mcd	400mcd	300mcd	2000mcd	3200mcd
Viewing angle (typ.)	120°	120°	120°	120°	120°	120°
Forward current (max.)	18mA	18mA	18mA	18mA	18mA	20mA
Forward voltage (typ.)	2V	3V	3V	2V	3V	3V
Operating temperature	-30°C To +80°C	-30°C To +80°C	-30°C To +80°C	-30°C To +80°C	-40°C To +80°C	-40°C To +80°C
Storage temperature	-30°C To +80°C	-35°C To +80°C	-35°C To +80°C	-35°C To +80°C	-40°C To +80°C	-40°C To +80°C