

Data Sheet

Insulated and Non-Insulated Cable Ferrules assortment Set Typ.1904C087

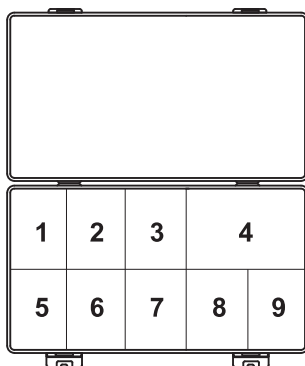

Insulator material: PVC
 Terminal material: Tinned Copper
 Working Temperature:
 Insulated - 75°C max.
 Non-insulated - 105°C max.
 Rating voltage: 300 V/AC max.

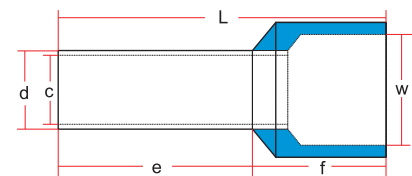
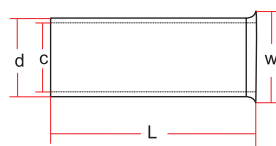

Section	Wire range	Dimension(mm)						Color	Contents
		e	f	L	ød	øc	øw		
1	0.75 mm ²	8.0	6.6	14.6	1.5	1.2	2.8	Grey	25pcs
2	1.0 mm ²	8.0	6.6	14.6	1.7	1.4	3.0	Red	50pcs
3	1.5 mm ²	8.0	6.6	14.6	2.0	1.7	3.5	Black	50pcs
4	2.5 mm ²	8.0	7.2	15.2	2.6	2.3	4.0	Blue	50pcs
5	4.0 mm ²	9.0	7.5	16.5	3.2	2.8	4.4	Grey	25pcs
6	0.75 mm ²	/	/	8	1.5	1.2	2.3	Non-insulated	25pcs
7	1.0 mm ²	/	/	8	1.7	1.4	2.5	Non-insulated	25pcs
8	1.5 mm ²	/	/	8	2.0	1.7	2.8	Non-insulated	25pcs
9	2.5 mm ²	/	/	8	2.5	2.2	3.4	Non-insulated	25pcs