

Data Sheet

Non-Insulate Cable Ferrules Set

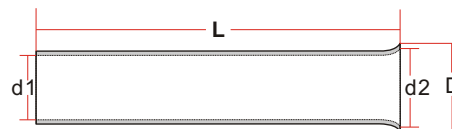

Material: Tinned Copper
Working Temperature: 120°C max.
Rating voltage: 600 V/AC max.

Type	Dimension(mm)				Wire range	Contents
	L	ød1	ød2	øD		
T1904C125	8.0	1.0	1.3	2.1	0.5 mm ²	500pcs
T1904C083	8.0	1.2	1.5	2.3	0.75 mm ²	500pcs
T1904C084	8.0	1.4	1.7	2.5	1.0 mm ²	500pcs
T1904C085	8.0	1.7	2.0	2.8	1.5 mm ²	500pcs
T1904C086	8.0	2.2	2.5	3.4	2.5 mm ²	500pcs
T1904C126	10.0	2.8	3.2	4.0	4.0 mm ²	50pcs
T1904C127	12.0	3.5	3.9	4.7	6.0 mm ²	50pcs
T1904C128	12.0	4.5	4.9	5.8	10.0 mm ²	50pcs