



## Model Number

**CBN15-18GS75-E2-V1**

## Features

- 15 mm non-flush
- The switching distance can be set over a wide range with the potentiometer

## Accessories

### BF 18

Mounting flange, 18 mm

### V1-G

Female connector, M12, 4-pin, field attachable

### V1-W

Female connector, M12, 4-pin, field attachable

### V1-G-2M-PUR

Female cordset, M12, 4-pin, PUR cable

### V1-W-2M-PUR

Female cordset, M12, 4-pin, PUR cable

## Technical Data

### General specifications

Switching function	Normally open (NO)
Output type	PNP
Rated operating distance	$s_n$ 2 ... 15 mm
Installation	non-flush
Output polarity	DC
Output type	3-wire

### Nominal ratings

Installation conditions	
A	30 mm
B	18 mm
C	30 mm
F	36 mm
Operating voltage	$U_B$ 10 ... 30 V
Switching frequency	$f$ 0 ... 100 Hz
Reverse polarity protection	reverse polarity protected
Short-circuit protection	pulsing
Voltage drop	$U_d$ $\leq 1.5$ V
Temperature drift	max. 20 % at -5 ... 55 °C (23 ... 131 °F)
Operating current	$I_L$ 0 ... 100 mA
No-load supply current	$I_0$ $\leq 15$ mA
Time delay before availability	$t_v$ $\leq 300$ ms

### Functional safety related parameters

MTTF <sub>d</sub>	226 a
Mission Time (T <sub>M</sub> )	20 a
Diagnostic Coverage (DC)	0 %

### Indicators/operating means

LED green	Operating display
LED yellow	indication switching state
Potentiometer	sensitivity adjustment

### Ambient conditions

Ambient temperature	-25 ... 85 °C (-13 ... 185 °F)
---------------------	--------------------------------

### Mechanical specifications

Connection type	Connector plug M12 x 1, 3-pin
Housing material	Stainless steel 1.4305 / AISI 303
Sensing face	PBT
Degree of protection	IP67

### Compliance with standards and directives

Standard conformity	
Standards	EN 60947-5-2:2007 EN 60947-5-2/A1:2012 IEC 60947-5-2:2007 IEC 60947-5-2 AMD 1:2012

### Approvals and certificates

UL approval	cULus Listed, General Purpose
CCC approval	CCC approval / marking not required for products rated $\leq 36$ V

## Dimensions

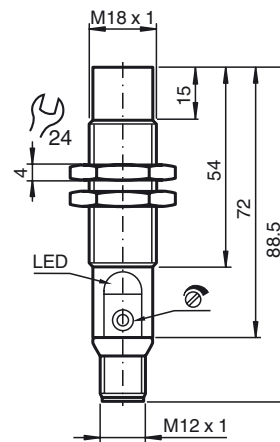

## Electrical Connection

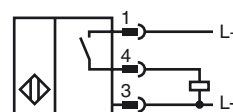

Pinout

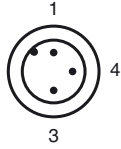

Wire colors in accordance with EN 60947-5-2

1		BN	(brown)
3		BU	(blue)
4		BK	(black)

Installation Conditions

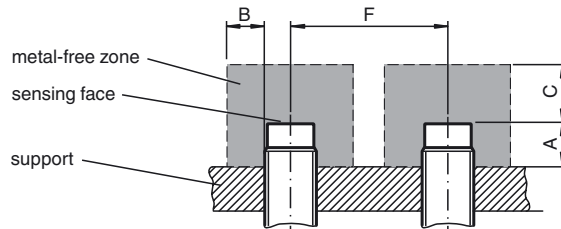

Release date: 2018-02-23 10:28 Date of issue: 2018-02-23 237042\_eng.xml