



The Jabra Engage 65 Engineered to be the world's most powerful professional wireless headsets*

The Jabra Engage 65 is an entirely new class of DECT wireless professional headsets engineered to boost customer satisfaction.

Industry-leading professional wireless performance. Better customer connections.

Provides superior wireless connectivity to a range of up to 150m/490ft. Enables up to 3x more users to operate in the same office space – with no loss in connection quality.¹

Crystal-clear calls. Enhance the customer experience.

Advanced noise-cancelling microphone and enhanced speakers deliver crystal-clear calls even in noisy offices. Meets Skype for Business Open Office requirements.²

More talk time, less interruption. Increase productivity.

Up to 13 hours talk time³ and a busylight that acts as a do-not-disturb sign for colleagues.

Increase availability for calls.

Connect to up to two devices simultaneously. Can connect to 1 USB device (softphone or desk phone) and 1 analog phone.

Choice of wearing styles. Support different workstyles.

With stereo, mono and lightest-in-category convertible models, there's a Jabra Engage for everyone.

* Relates to Jabra Engage 75/65 Stereo and Mono variants. February 19, 2018. See facts on Jabra.com/commercial-claims
¹ Find details on page 2 ² Variant dependent ³ Dependent on usage

At a glance:
Jabra Engage 65 wireless headsets

- Up to 150m/490ft range
- Up to 3x wireless density¹
- Advanced noise-cancelling microphone
- Enhanced speakers with intelligent volume control
- Up to 13 hours talk time³
- Integrated busylight
- Connect up to 2 devices

Works with

Getting started

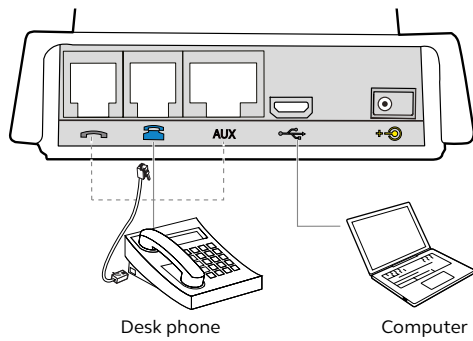

First, connect the desk phone and PC cables to the base. For information on your specific phone, refer to <http://www.jabra.com/compatibilityguide>

Connect to power

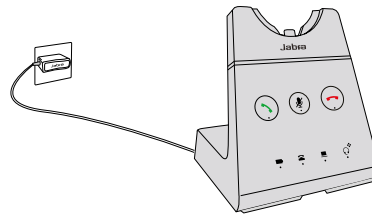

Stereo and Mono

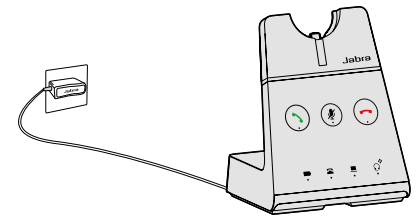

Convertible

Then plug the base into a power supply. Press Vol + and Vol - simultaneously to enter the setup menu to help you connect to your computer or desk phone.

How to wear

Stereo and Mono

Convertible

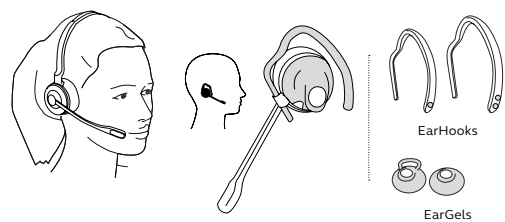

The headset can be worn on the left or right ear.

How to use

Stereo and Mono

Convertible

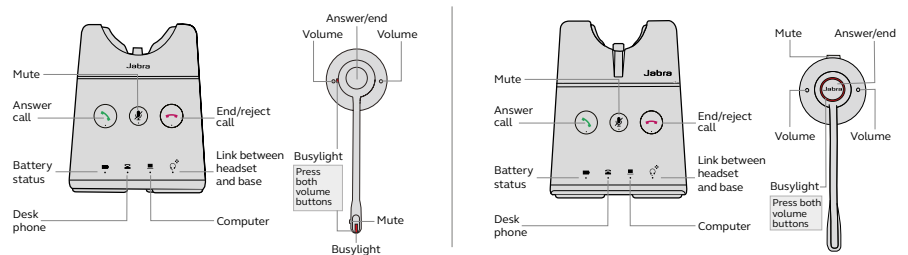

Features	Jabra Engage 65 Stereo	Jabra Engage 65 Mono	Jabra Engage 65 Convertible
Wireless capacity NA/EU - wideband ¹	70/145	70/145	70/145
Wireless capacity NA/EU - narrowband ²	95/190	95/190	95/190
Wireless range (up to - meters/feet)	150/490	150/490	100/330
Talk time (up to - hours) ³	13	13	9
Fast charge - from 0-40% (minutes)	30	30	30
Emergency charging	Yes	Yes	Yes
Connectivity - how many devices	2 ⁴	2 ⁴	2 ⁴
Wireless technology	DECT	DECT	DECT
Secure DECT (level)	C	C	C
Intelligent volume control (speech level normalization and balanced voice)	Yes	Yes	Yes
User sound protection (PeakStop™, Noise@Work, Intelligent Acoustic Shock, IntelliTone 2.0)	Yes	Yes	Yes
Directional noise cancelling microphone	Yes	Yes	Yes
Microphone (G-MOS, Tx, CC)	4.3	4.3	3.8
Speaker (P-MOS, Rx, Silent)	4.4	4.4	3.9
Meets Skype for Business Open Office requirements	Yes	Yes	No
Boom arm adjustable	270°	270°	360°
Busylight	Yes	Yes	Yes
Wearing styles	Stereo	Mono ⁵	Comes with earhook and headband ⁶
Headset weight (g)	83	57	18

Compatibility For compatibility information go to Jabra.com



¹ DECT capacity, number of theoretical users in wideband. Actual numbers may vary
² DECT capacity, number of theoretical users in narrowband. Actual numbers may vary ³ Dependent on usage
⁴ Can connect to 1 USB device (softphone or desk phone) and 1 analog phone. ⁵ Engage 65 Mono: neckband is available as an accessory ⁶ Engage 65 Convertible: neckband is available as an accessory
⁷ Softphone certified, desk phone in progress