

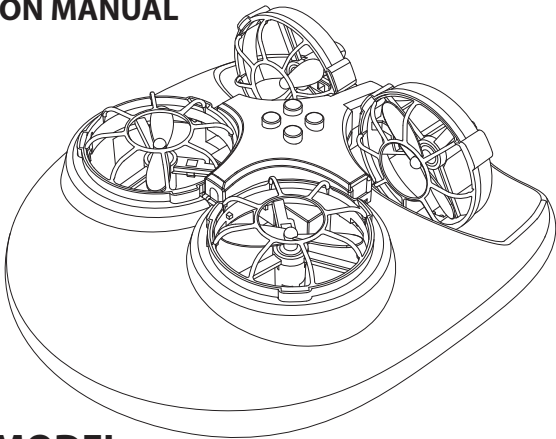

8+

## Item No.: 25307 / 25308 INSTRUCTION MANUAL



### 3IN1 RC MODEL Drives ashore, in the water and flies

#### MAXIMUM TRANSMITTING POWER

Operation frequency: 2.405 ~ 2.476 MHz  
Maximum Radio frequency power: maximum peak power: 2 dBm

Amewi Trade e.K.  
Nikolaus-Otto-Str. 18  
D-33178 Borchten

#### Declaration of Conformity

This product has been manufactured according to actual technical standards. The product is matching the requirements of the existing European and national guidelines. The Declaration of Conformity has been provided. AMEWI TRADE GmbH declares that this product is matching the basic requirements and remaining regulations of the guideline 2014/53/EU (RED). The declarations and documents are stored at the manufacturer and can be requested and applied there.

The full text of the declaration of conformity can be found at: <https://amewi.com/Konformitaetserklaerungen>

For additional questions to the product and conformity please contact:  
AMEWI TRADE GmbH Nikolaus-Otto-Str. 18, 33178 Borchten or via the website amewi.com



#### Security and Hazard Warnings

- Warning!** For damage, caused by disregarding of the manual, warranty expires! We are not liable for secondary failures, material or personal damage, caused by improper usage or disregarding the security notices.
- Warning!** Based on security and registration (CE) reasons, it is forbidden to modify the product personally. Do not disassemble the product.
- Warning!** Small parts. Danger of suffocation or risk of injury caused by small parts.
- Warning!** Suitable for people aged 14+!

The product is not allowed to get moist or wet. The product is only allowed to be used on flat and clean surfaces. Even a drop down from a small height can cause damage to the product.

#### Battery Notice and Battery Disposal

**Warning!** Battery do not belong in children's hands. A change of the battery has to be done by an adult person. Never mix chargeable batteries with non-chargeable batteries. Never mix fully charged batteries with almost empty batteries. Never mix batteries of different capacities. Never try to charge dry batteries. Take care of the correct polarity. Defective batteries belong to special waste. Never leave a charging battery unattended. For questions about the charging time please read the manual or ask the manufacturer.

#### Disposal

The company AMEWI is registered below the WEEE Reg. Nr. DE93834722 at the foundation EAR and recycles all used electronic parts properly. Electric and electronic products are not allowed to put in household garbage. Please dispose the product at the end of the lifetime according to the actual laws. You as a customer are responsible by law for the return of all used batteries, a disposal over the household garbage is forbidden!

Batteries containing hazardous substances are marked with the alongside symbols, which point to the prohibition of disposal in household garbage.

Additional notations for the critical heavy metal are: Cd=Cadmium, Hg=Quecksilber, Pb=lead (Label is placed on the batteries, for example below the bottom left trash symbols).

Based on RoHS labeling the manufacturer confirms, that all limit values were taken care of at the time of manufacturing.

Batteries labeled with the recycling symbol can be put into used battery collecting tank. (Most supermarkets have) They are not allowed to be put into local household garbage.

AMEWI is involved in the dual system for boxing over the company Firma Landbell AG. All used boxes are collected from partner companies (waste disposal contractor) at private customers (local household), sorted and properly utilized. The involvement in a Dual System helps to save CO<sub>2</sub> emissions.

#### KNOW YOUR DRONE

DRONE applies 2.4G remote control system to allow for multiple players compete without interference and functions such as forward and backward, left and right, left sideward and right sideward, left rotation and right rotation, and 360 degree flips and rolls etc.

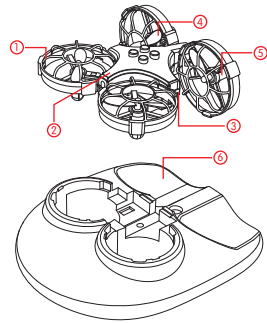

- 1 Protective Guard
- 2 Upper Casing
- 3 Lower Casing
- 4 Propeller
- 5 Motor
- 6 Bottom Base

#### ACCESSORIES

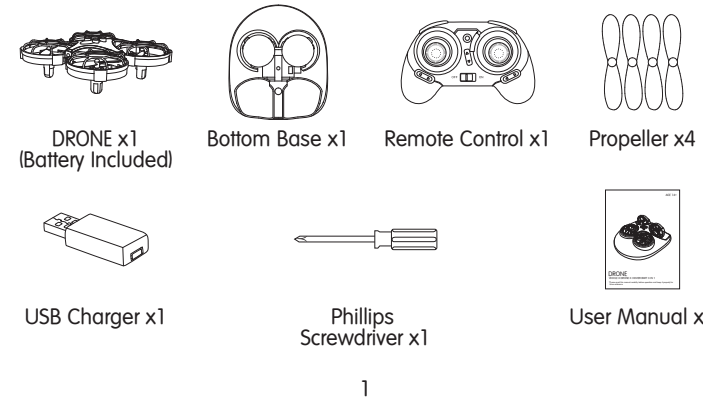

Usage of DIY Stickers: Tear apart the film. Apply the patterned side to the desired position and use wet tissues or a piece of damp cloth to gently tap the sticker. 5 to 10 seconds later, peel up one corner of the sticker to see if the pattern has been printed. If so, rip the whole piece of the sticker.

#### ACCESSORY ASSEMBLY

##### 1. Propeller Installation

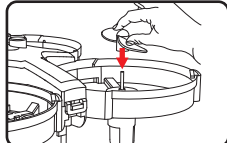

1 Align the propellers to the motor shaft with the propellers and the shaft aligned correctly.

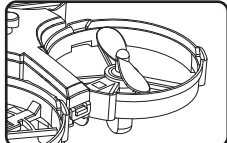

2 Depress the propellers until fixed.

##### Notes:

When installing or dismantling the propeller, please do not force on the propeller to avoid distortion.

##### 2. Propeller Replacement

Please replace with new propellers once the propellers are damaged due to crashes or collisions. Each propeller is marked with A or B. When installing, make sure that A corresponds to A and B to B, otherwise the drone cannot perform functions such as takeoff, rotation or throw-to-fly.

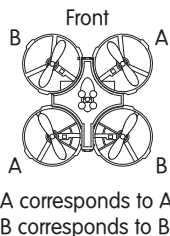

A corresponds to A  
B corresponds to B

2

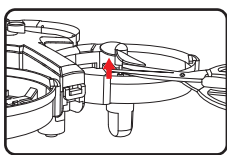

1 Use scissors to pry the propellers that needs to be replaced.

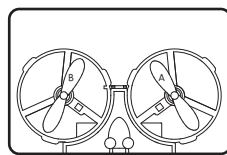

2 Install the propellers in order of A to A and B to B. Hold the propellers, align to the crankshaft and depress until fixed.

##### Notes:

When installing or dismantling the propeller, please do not force on the propeller to avoid distortion.

Propellers vary from one to another!

##### 3. Prop Guard Installation

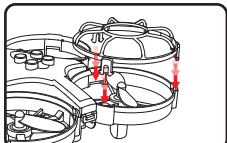

1 Align the protective guard to the three holes.

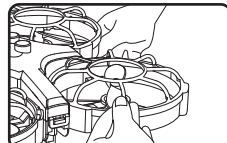

2 Depress the protective guard until fixed.

##### 4. Battery Charging for Drone

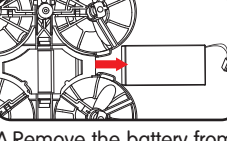

A Remove the battery from the bottom of the drone.

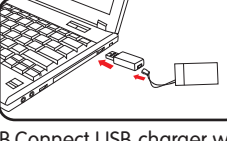

B Connect USB charger with the battery. (Do not charge the battery until the water stains on it have been vaporized.)

3

##### Notes :

The LED light turns on during charging and turns off when the charging completes. It takes about 65 minutes to fully charge and gives about 5-6 minutes of running time when fully charged.

#### BATTERY INSTRUCTIONS

- There is a certain risk when using battery. It may cause fire, body injury or property loss. Users must be aware of the risks and take full responsibility of using battery improperly.
- If battery leakage occurs, please avoid contacting your eyes or skin with electrolyte. Once it happens, please wash your eyes with clean water and seek medical care immediately.
- Please remove the plug immediately if you sense any peculiar smell, noise or smog.

##### Battery Charging

- Please use the original charger to ensure safe use.
- Do not charge dilantant or outworn battery.
- Do not over charge battery. Please unplug the charger once fully charged.
- Do not charge the battery next to inflammables, such as carpet, timber floor or wood furniture or on the surface of electro-conductive objects. Please always keep an eye on the battery when charging.
- Do not charge battery which not cool down yet.
- The charging temperature should be between 0°C to 40°C.

##### Battery Recycling

- Do not dispose the battery as daily rubbish. Please familiarize yourself with the local garbage disposal method and dispose it according to the special requirement.

4

#### KNOW YOUR REMOTE CONTROL

##### 1. Protective Guard the Parts Name of the Remote Control

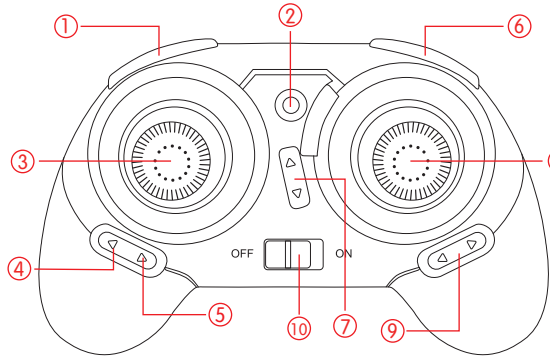

- |   |   |
|---|---|
| 1 Speed Mode  | 6 Flips and Rolls (This Button Works as One-key Rotation on Ground Model) |
| 2 Indicator Light   | 7 Forward/Backward Fine-tuning  |
| 3 Throttle Joystick   | 8 Rudder Joystick   |
| 4 Flight Mode/Ground Mode/Water Mode                          | 9 Left/Right Sideward Fine-tuning   |
| 5 Short Press for Headless Mode/Long Press for Return to Home | 10 Power Switch   |

##### Notes:

The flight mode will be turned on by default at startup. The light turns red on flight mode, turns green when you switch it to ground mode and turns blue when you switch it to water mode.

5

#### 2. Remote Control Battery Installation

- Open the Remote Control Battery Cover  
Open the battery compartment cover with a philips screwdriver.

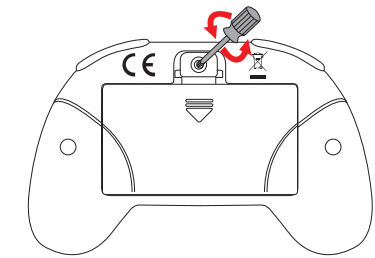

##### 2. Assemble the Battery

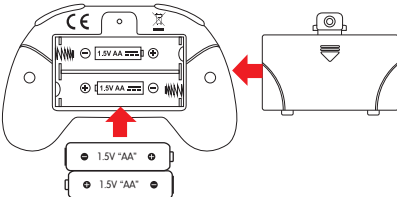

Open the battery compartment cover, insert two AA batteries (not included) with the two poles aligned correctly.

##### Notes :

- Ensure the polarity symbols on the batteries match the symbols inside the battery compartment.
- Do not mix new and old batteries.
- Do not mix different types of batteries.

6

#### PRE-FLIGHT PREPARATION

##### 1. Flight Environment



Indoor: Spacious spaces away from barriers, crowds or pets are preferred.



Outdoor: Sunny, windless and breezy weathers are preferred.



Please keep the drone in sight during the flight and keep it away from barriers, high-tension cables, trees and crowds.



Do not fly in extreme environment, such as hotness, coldness, strong wind or heavy rain.

##### 2. Pre-flight Inspection

Please Check the Followings Before Flying:

- If the drone and the remote controller are fully charged.
- If the propellers have been correctly installed and in good condition.
- If the propellers work well after startup.
- If the surrounding conditions are ideal for a safe flight.

7

#### 3. Pairing Remote Control with Drone

- Turn on the power of the drone; put the drone on plain ground; check whether the indicator lights of remote control and LED lights of drone flash.

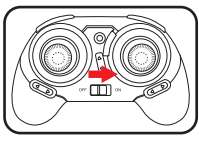

- Push the throttle joystick to the top and then pull back to the bottom. After the sounds of beep, the flash of indicator lights of remote control and LED lights of drone will turn to constant lights, which means the pairing completes.

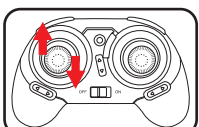

##### 4. Calibration

If the drone fails to ascend vertically, please proceed to the calibration process. Toggle the throttle joystick and the rudder stick towards toe-out at the same time. When the drone's indicator light turns from quick blinking to solid light, the process of calibration completes. Please calibrate the drone on a level surface as to ensure the calibration can be successful.

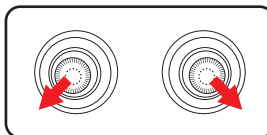

#### FLY WITH REMOTE CONTROL

##### 1. Flying

The left joystick is used to control flying height and left and right turning, while the right joystick is used to control forward, backward and sideward flights.

##### Left Joystick

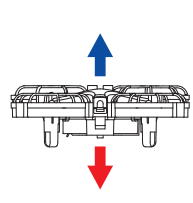
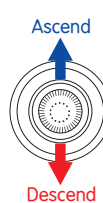

8

##### Right Joystick



##### Forward



##### Backward



##### Left Sideward



##### Right Sideward

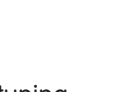

##### 2. Fine-tuning

Gradually push the throttle joystick to make the drone ascend. Fine-tune the direction when the drone rolls or yaws.

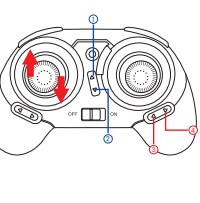

9

##### 3. Speed Mode

If you want to control the speed of the drone, press the "Speed Mode" button to control it to fly at the speed of 30%, 60% and 100% out of the full speed.

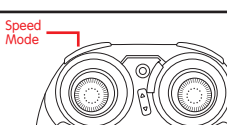
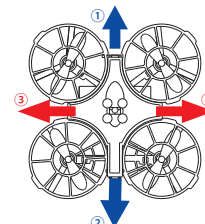

##### 4. Headless Mode

Put the drone with its front being your front. Pair the drone with the remote controller before its takeoff. Then short press the "Headless Mode" button to let it enter the headless mode. To exit, press the "Headless Mode" button again.

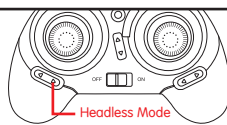

##### 5. One-key Return

Long press the "One-key Return" button to return the drone automatically. After the drone has returned to home point, toggle the front joystick or press the "One-key Return" button to exit the auto return mode. The drone's light will then turn solid.

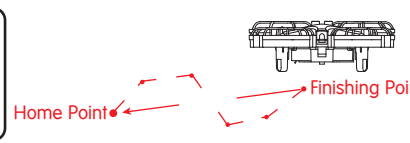
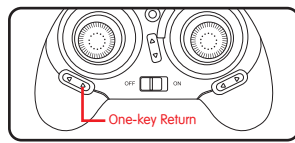

10

#### 6. Flips and Rolls

Till the drone ascends to the altitude of 3 meters, press the button of flips and rolls and move the right joystick to certain direction to finalize flips and rolls.

##### Right Joystick

##### Front Flips and Rolls



##### Back Flips and Rolls



##### 7. Ground Mode/Water Mode

Rotate the accessory part (close to the projections on the tail) on the drone's back as shown in figure 1, and install the drone onto the bottom base as shown in figure 2. It has been completely set up and ready for takeoff or cruising as shown in figure 3. (Please wipe off the drone with a piece of dry cloth after water mode.)

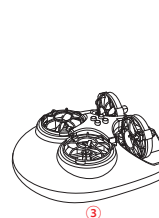
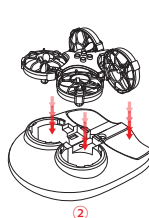
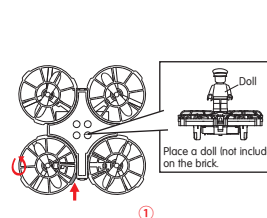

11

#### 8. Separation of the Drone and the Bottom Base

Put your hands at the tail of the drone and push it forward to take it apart from the bottom base.



##### FAQ

PROBLEMS	CAUSES	SOLUTIONS
Control failure	Not connect with the drone battery.	Connect the drone battery in right way.
	Too strong wind force.	The wind can affect the drone's flight. Therefore, do not fly it in strong wind conditions.
Fail to ascend	The rotation speed of main blades is too slow.	Push up the throttle joystick.
	The battery of the drone is not fully charged.	Please fully charge the battery.
Landing too soon	The throttle joystick is pulled down too fast.	Pull down the throttle joystick slowly to perform a smooth landing.
Out of control	Beyond the effective controlling distance.	Ensure that the flying distance is within 20 meters.
Motor cannot rotate	Dust or other objects has been gathered on the motor.	Clean the dust or remove other objects on or around the motor.

12