

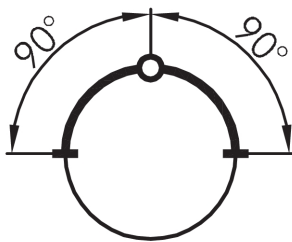

### Key actuator head, maintained, silver-coloured JRMSSA13E

Description: including two keys other lock types on request

Category:	Key Switches (momentary/maintained)
Series:	RONDEX-JUWEL®
Panel cut-out:	Ø 22.3 mm
Protection class:	II (protective insulation)
Degree of protection:	IP65
Switching function:	maintained action
Illumination:	no
With labelling option:	no
Front bezel	silver-coloured
Shape:	round

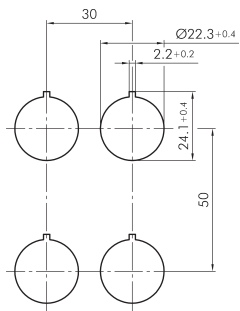
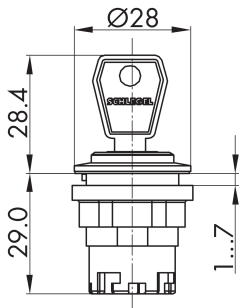

red**dot** award 2018  
winner

#### Legend

⏏ = Switching position

> = Spring return

● = Key removable position