

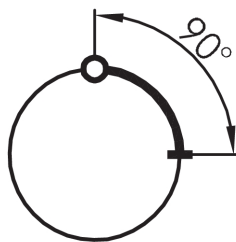

Key actuator head, maintained, silver-coloured JRMSSA14E

Description: including two keys other lock types on request

Category: Key Switches (momentary/maintained)
 Series: RONDEX-JUWEL®
 Panel cut-out: Ø 22.3 mm
 Protection class: II (protective insulation)
 Degree of protection: IP65
 Switching function: maintained action
 Illumination: no
 With labelling option: no
 Front bezel: silver-coloured
 Shape: round

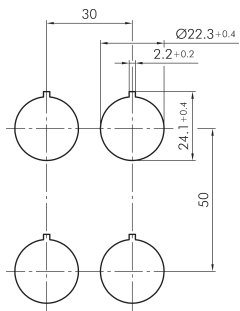
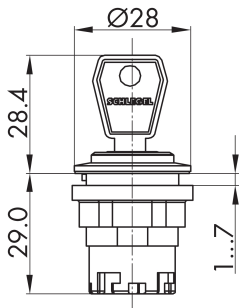

reddot award 2018
winner

Legend

- = Switching position
- > = Spring return
- = Key removable position