

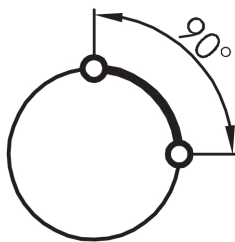

### Key actuator head, maintained, silver-coloured JRMSSA15E

Description: including two keys other lock types on request

Category: Key Switches (momentary/maintained)  
 Series: RONDEX-JUWEL®  
 Panel cut-out: Ø 22.3 mm  
 Protection class: II (protective insulation)  
 Degree of protection: IP65  
 Switching function: maintained action  
 Illumination: no  
 With labelling option: no  
 Front bezel: silver-coloured  
 Shape: round

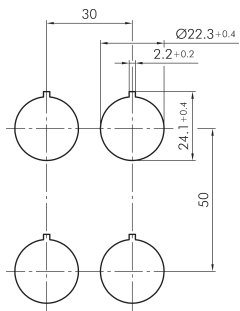
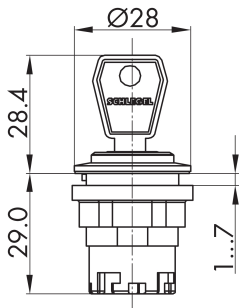

reddot award 2018  
winner

#### Legend

- = Switching position
- > = Spring return
- = Key removable position