

No.	Changes and/or Note No.	Date	Sign	No.	Changes and/or Note No.	Date	Sign

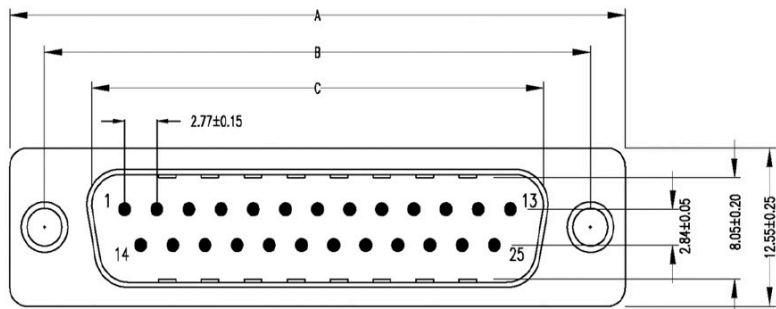

Hexscrew

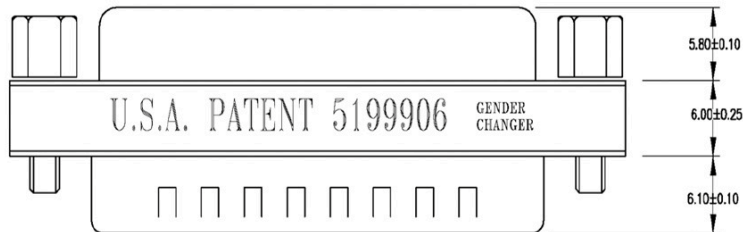
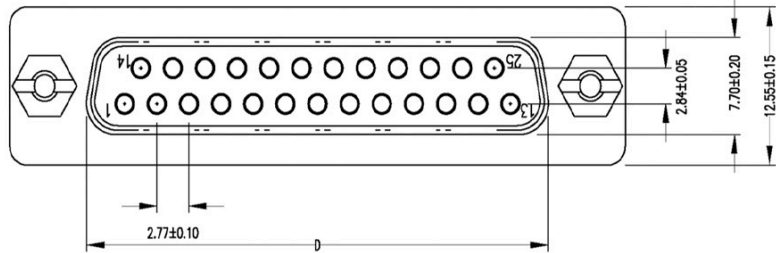
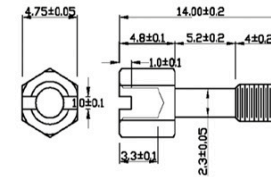

GENDER CHANGER

PIN OUT: R1 = L1

Label: yellow color with black character

One side: U.S.A. PATENT 5199906

GENDER CHANGER

The other side: R.O.C. PATENT 64341

GENDER CHANGER

SPECIFICATION

INSULATOR: PBT Glass fibre reinforced UL 94 V0

CONTACT: Brass

CONTACT PLATING: Gold plated over nickel

SHELL: Tin plated shell

CURRENT RATING: 3 AMP

DIELECTRIC STRENGTH: 1000V AC for one minute

INSULATOR RESISTANCE: 1000MΩ min at 500V DC

TEMPERATURE: -55°C — +105°C

Part no.	Type/Item	A±0.15	B±0.10	C±0.15	D±0.10
2401-0100-11	9M/F	30.8	25.0	16.92	16.35
2401-0100-12	15M/F	39.2	33.3	25.25	24.7
2401-0100-13	25M/F	53.05	47.04	38.96	38.4
2401-0100-14	37M/F	69.4	63.5	55.42	54.8

DATE	DRAWN	SCALE	MATERIAL TYPE
	APPROVED		REPLACES
	GENDER CHANGER - STANDARD		
	Male to Female DMGC-xxxx-MF		
DRAWING No.			2401-0100-1X