

D-Sub

TECHNICAL SPECIFICATIONS

Materials:

Unshielded Hood: UL-recognised plastic material
 Colour: Grey

Shielded Hood: UL-recognised plastic material
 Plating: Nickel over Copper

Operating Temperature: -30°C to +90°C

Thumbscrews: UNC 4-40 (Standard)

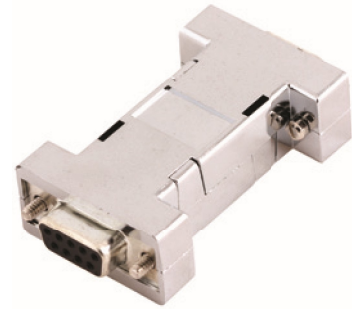

Features:

- Available in sizes 9 and 25 (15 on request)
- Available in EMI-shielded and unshielded version
- Delivered complete with wires and Sub-D
- Pre-wired connectors on request

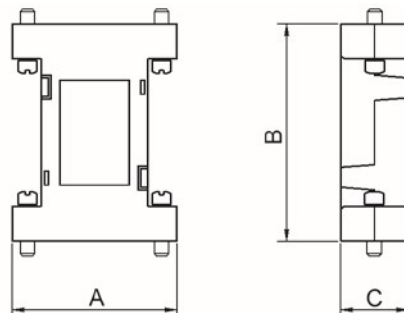
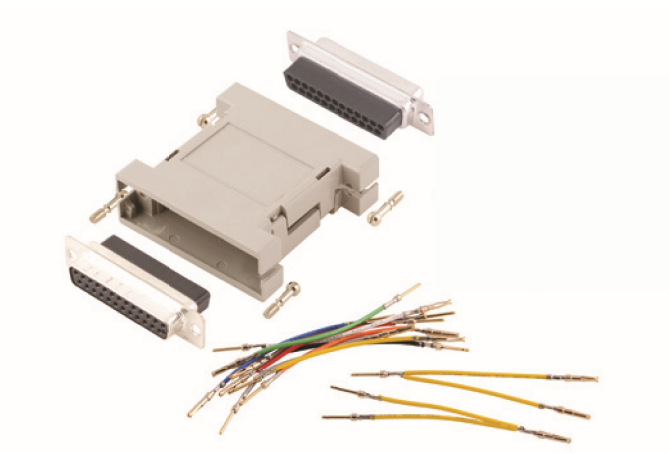

Size GA	Dim A	Dim B	Dim C
9-way	33,2	62,0	16,5
15-way	41,0	62,0	16,5
25-way	56,0	62,0	16,5

Ordering information:

Size:	P/N - Kitted:	Product Code:
9-way	2111-0101-01	GA0909-MM-LG-K-RC
15-way	2111-0101-02	GA1515-MM-LG-K-RC
25-way	2111-0101-03	GA2525-MM-LG-K-RC

Size:	P/N - Kitted:	Product Code:
9-way	2111-0101-11	GA0909-MF-LG-K-RC
15-way	2111-0101-12	GA1515-MF-LG-K-RC
25-way	2111-0101-13	GA2525-MF-LG-K-RC

Size:	P/N - Kitted:	Product Code:
9-way	2111-0101-21	GA0909-FF-LG-K-RC
15-way	2111-0101-22	GA1515-FF-LG-K-RC
25-way	2111-0101-23	GA2525-FF-LG-K-RC

MM = Male to Male Sub-D
 MF = Male to Female Sub-D
 FF = Female to Female Sub-D

