

RoHS Compliant

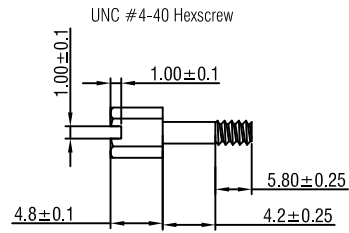

WIRE ADDRESS

P1	P2
4	1+6
3	2
2	3
1+6	4
5	5
8	7
7	8
SHELL	SHELL

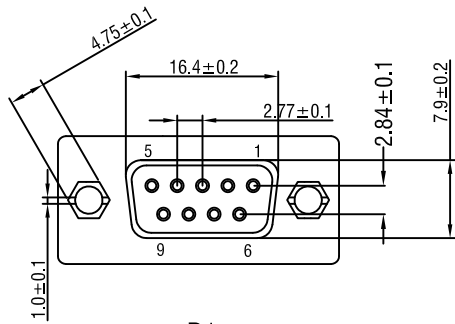
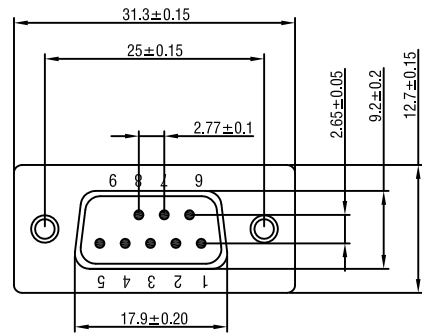
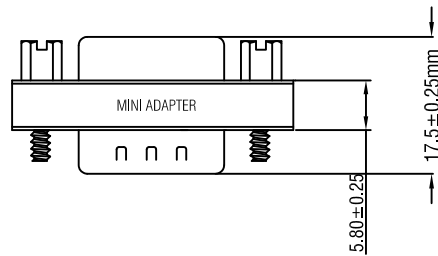
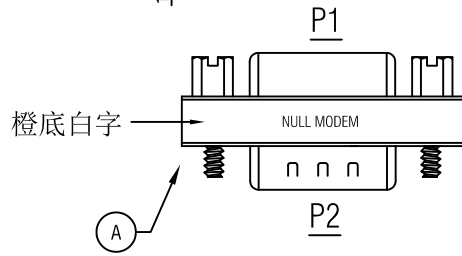

- Electrical Test:
- 1.100% TEST OPEN SHORT MIS-WIRE.
 - 2.CONTACT RESISTANCE:3Ω MAX.
 - 3.INSULATION RESISTANCE:5MΩ MIN.
 - 4.HI-POT:300V DC/10MS.

D		
C		
B		
VER.A	REVISE	DATE
Company: CONRAD		
Item	2269064	
Draw	Kobe	Date: 2020.11.14
Approval		
Duty	F16	BOM.NO: 14043
Sample NO.	29039c232	Drawings of 1 (2) Proportion: 1:1 Unit(mm) A4

A	1	9-DBDB010-10022	DB9F-DB9M Mini ADAPTER(Black Insulator,Nicke Plated)	1	PCS
NUMBER	BOM.NO	PRODUCT SPECIFICATIONS		Quantity	Unit

RoHS Compliant

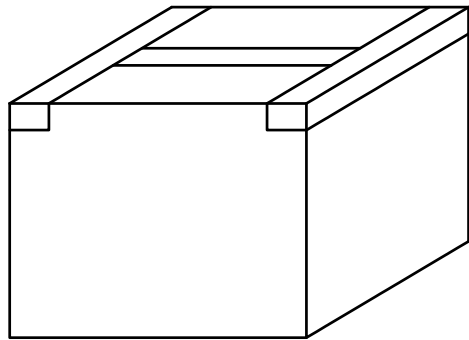

500PCS/CTN (540*370*320mm)

CONRAD
GERMANY
BEST NO.: 2269064
PCS.: 500PCS
MODEL NO.: DB9-MF-MI-AD
ORDER NO.:
WEIGHT(KG.): KGS

外箱側麥

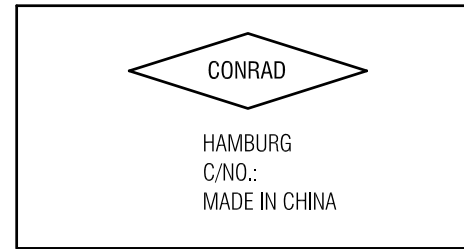

外箱正麥

背面沒封口

雙面膠

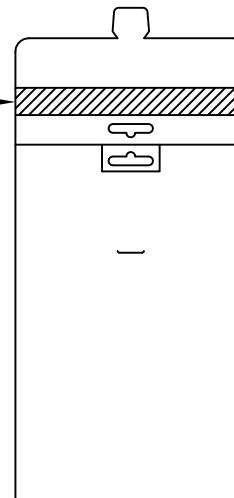

紙袋正面



紙袋背面

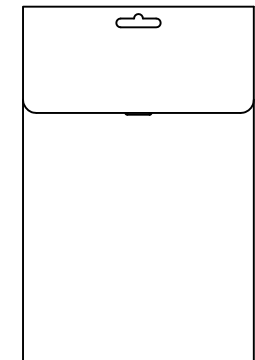

1PCS/Kraft paper bag(0.06*130*200mm) + Barcode



Barcode(85*100mm)

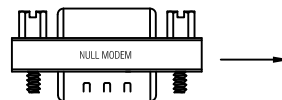

D		
C		
B		
VER.A	REVISE	DATE

Company: CONRAD

Item	2269064	
Draw	Kobe	Date: 2020.11.14
Approval		
Duty	F16	BOM.NO: 14043