



Paulmann

### Safety Instructions

1, 2, 3, 4, 5, 6, 7, 8, 11, 14, 19, 22, 23, 24, 25, 26, 27, 28, 29, 33, 34;



Info

[www.paulmann.com](http://www.paulmann.com)

Paulmann Licht GmbH  
Quezinger Feld 2  
31832 Springe  
Germany

[www.paulmann.com](http://www.paulmann.com)

Art.-Nr.: 999.62  
999.63



99962/63

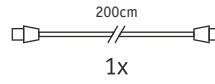
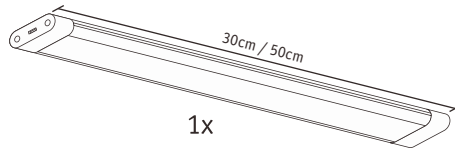

(+MA 326)PEO 04/20



A

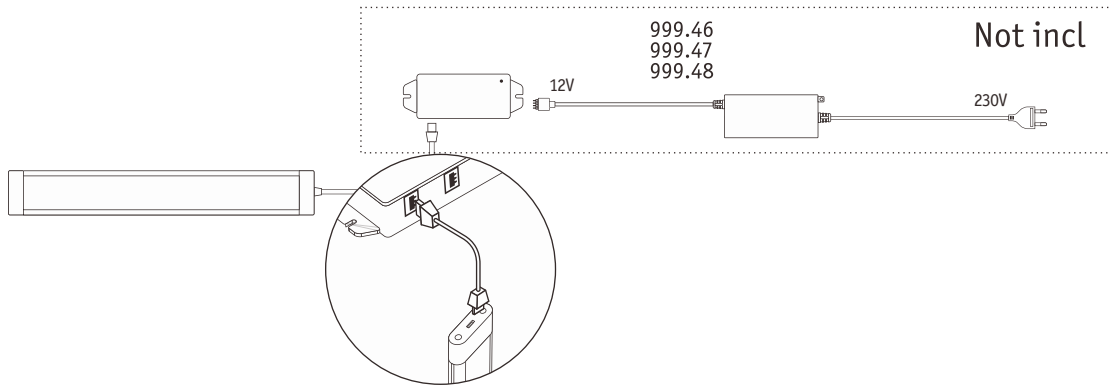

B1

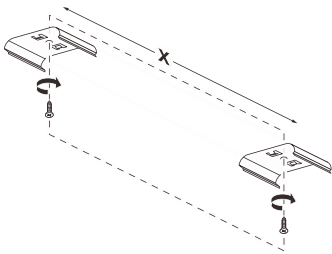

B2

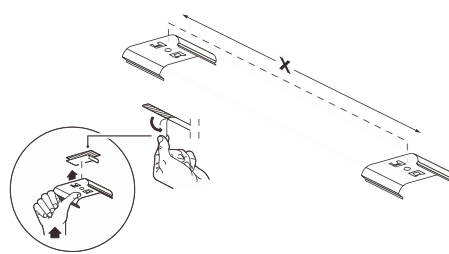

C

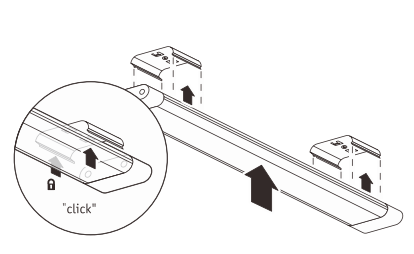

Not incl.

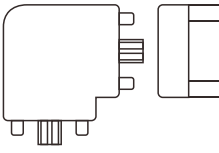

Paulmann  
Art.Nr.:999.64

Not incl.

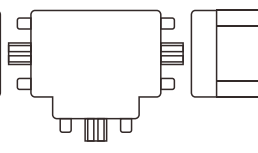

Paulmann  
Art.Nr.:999.65

Not incl.

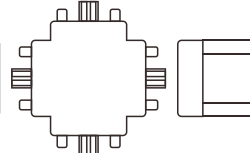

Paulmann  
Art.Nr.:999.66

Not incl.

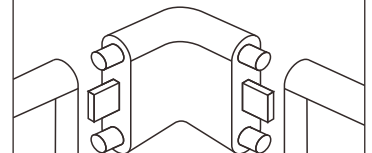

Paulmann  
Art.Nr.:999.67

Not incl.

Driver: Max.12W

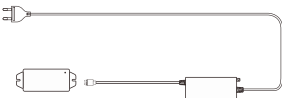

Paulmann  
Art.Nr.:999.46

Not incl.

Driver: Max.25W

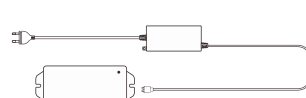

Paulmann  
Art.Nr.:999.47

Not incl.

Driver: Max.36W



Paulmann  
Art.Nr.:999.48

Not incl.

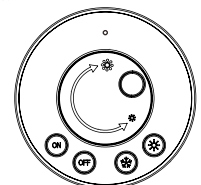

Paulmann  
Art.Nr.:999.76

## Function of keys

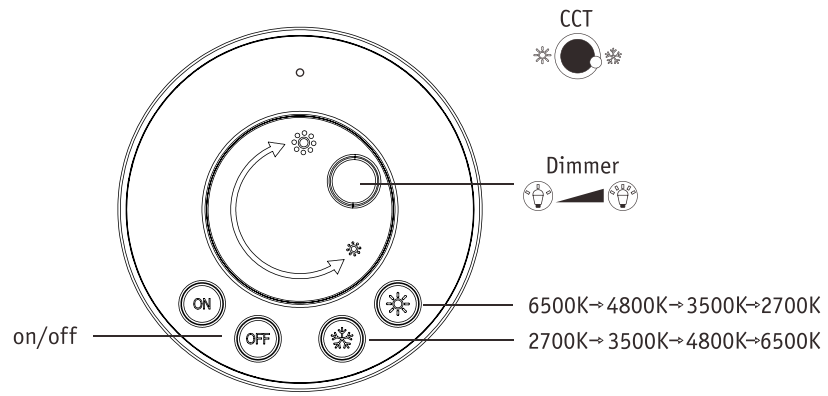

## Code Matching

(Press the "ON" button one time within 5s of connecting to the controller)

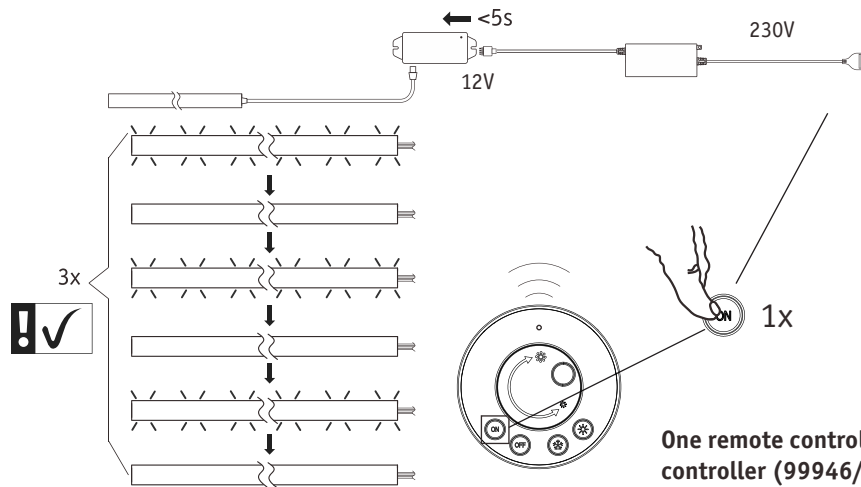

One remote control can control countless controller (99946/99947/99948), but a controller (99946/99947/99948) can be only controlled by 4 pcs remote control.

## Code Clearing

(Press the "NO" button three times within 5s of cancelling the connection to the controller)

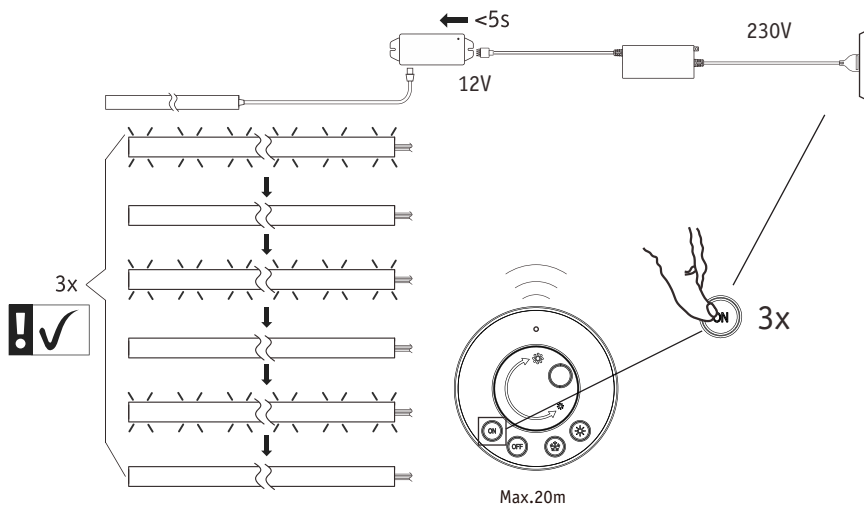

Hiermit erklärt Paulmann Licht, dass der Funkanlagentyp Art.-Nr.: 999.62/999.63 der Richtlinie 2014/53/EU entspricht. Der vollständige

Text der EU-Konformitätserklärung ist unter der folgenden Internetadresse verfügbar: [www.paulmann.de](http://www.paulmann.de)

Zugelassen für den Betrieb in allen Ländern der EU / Approved for operating in all European countries

CE: Konform mit / in accordance with / conformément a 2014/30/EU, 2014/53/EU <http://www.paulmann.com/ce>

Funk-Frequenz :2.4GHz -2.4835GHz Abgestrahlte Energie :10mW  NO

Doesn't apply for the geographical area within a radius of 20km from the centre on "Ny Alesund"