

## Emergency stop switch – Y090

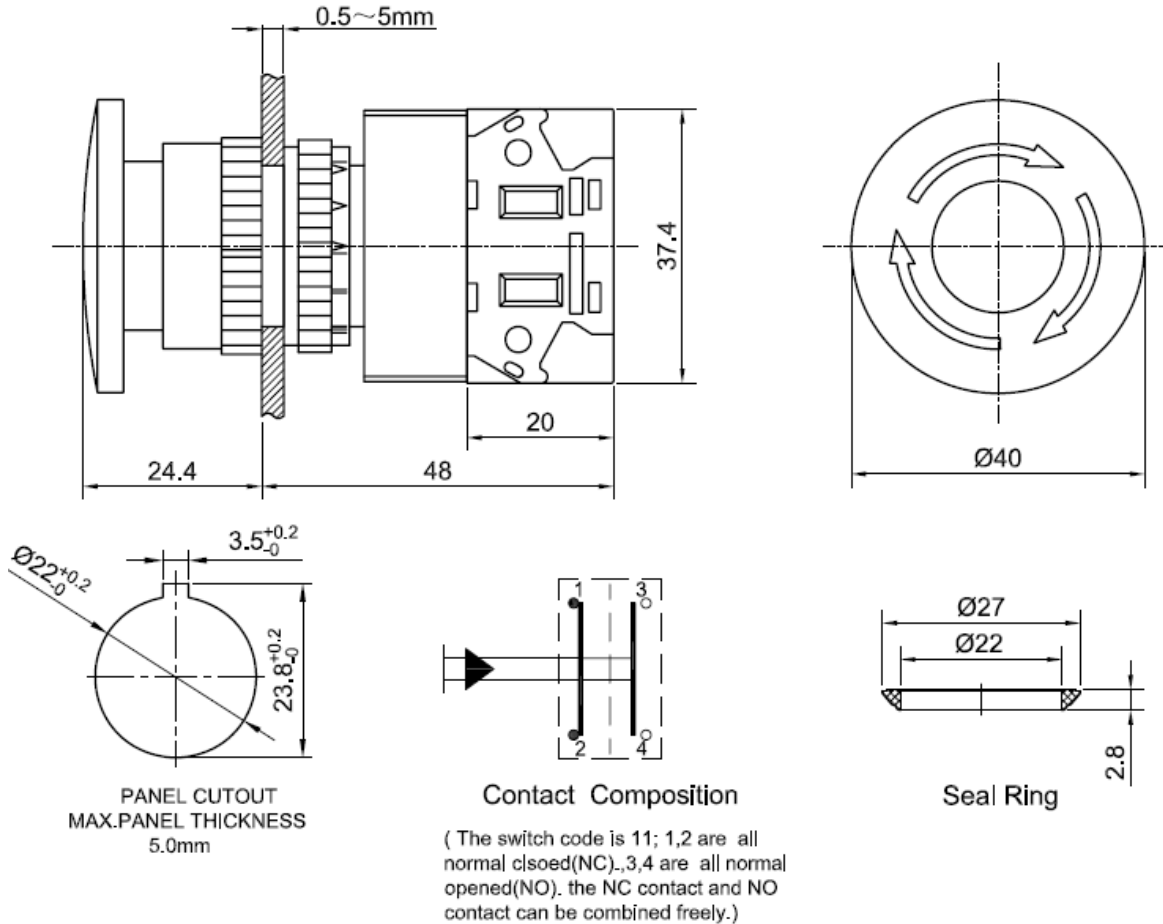

### Specification

Mounting diameter .....	22mm
Operation type .....	Push on turn reset
Contact structure .....	1NO1NC
Switch rating .....	Ue: 250V, Ie: 5A
Terminal .....	Screw terminal
Operating and storage temperature .....	-25 to +55 °C
Operating and storage humidity .....	45 to 85 % RH
IP rating .....	IP40