

Unit: mm

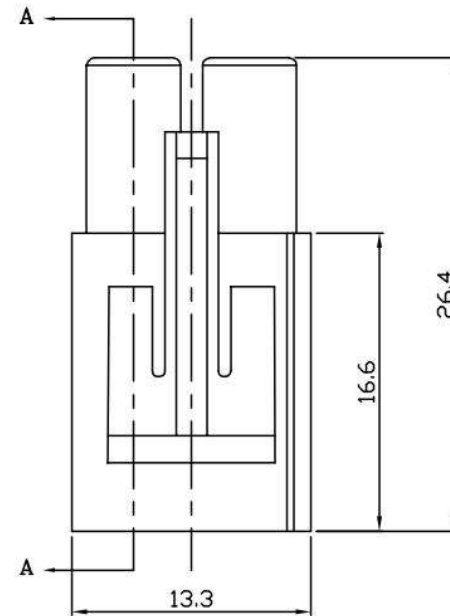
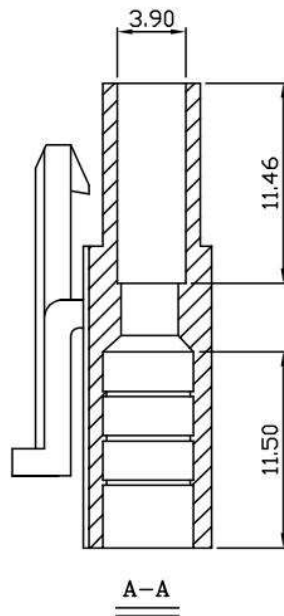

Specifications:

- Poles: 2 Poles
- Current Rating: 5A
- Voltage Rating: 250V AC, DC
- Temperature Range:  $-25^{\circ}\text{C}$ ~ $+85^{\circ}\text{C}$
- Contact Resistance: Initial value/ $10\text{m}\Omega$  max  
After environmental testing/ $20\text{m}\Omega$
- Withstand Voltage: 1500V AC/minute
- Insulation Resistance:  $1000\text{ M}\Omega/\text{min}$
- Material: Nylon UL94V-0, UL94V-2
- Suitable SM 1010T Series Terminal
- Mates With SM 2000W-02-2000W-02F Series Housing