

## Operating Instructions

### Solar Garden Light

Item No. 2338745

#### Intended use

The product is intended for use as decoration and is not suitable for domestic lighting. A flickering, amber-colored LED serves as the illuminant. The light turns on automatically at nightfall. The product is powered by a battery that recharges via the integrated solar panel during the daylight hours.

The product has an IP44 ingress protection rating. It is splash proof and suitable for outdoor use. Do not submerge!

For safety and approval purposes, you must not rebuild and/or modify this product. If you use the product for purposes other than those described above, the product may be damaged. In addition, improper use can result in short circuits, fires or other hazards. Read the instructions carefully and store them in a safe place. Make this product available to third parties only together with its operating instructions.

This product complies with the statutory national and European requirements. All company names and product names are trademarks of their respective owners. All rights reserved.

#### Delivery content

- 1x solar garden light (1x rechargeable battery inserted)
- 2x standpipes
- 1x ground spike
- Operating instructions

#### Up-to-date operating instructions

Download the latest operating instructions at [www.conrad.com/downloads](http://www.conrad.com/downloads) or scan the QR code shown. Follow the instructions on the website.



#### Explanation of symbols



The symbol with the exclamation mark in the triangle is used to indicate important information in these operating instructions. Always read this information carefully.



This product is constructed according to protection class III.



The arrow symbol indicates special information and advice on operation.

#### Safety instructions



**Read the operating instructions carefully and especially observe the safety information. If you do not follow the safety instructions and information on proper handling in this manual, we assume no liability for any resulting personal injury or damage to property. Such cases will invalidate the warranty/guarantee.**

##### a) General information

- The device is not a toy. Keep it out of the reach of children and pets.
- Do not leave packaging material lying around carelessly. This may become dangerous playing material for children.
- Protect the product from extreme temperatures, strong jolts, flammable gases, steam and solvents.
- Do not place the product under any mechanical stress.
- If it is no longer possible to operate the product safely, take it out of operation and protect it from any accidental use. Safe operation can no longer be guaranteed if the product:
  - is visibly damaged,
  - is no longer working properly,
  - has been stored for extended periods in poor ambient conditions or
  - has been subjected to any serious transport-related stresses.
- Please handle the product carefully. Jolts, impacts or a fall even from a low height can damage the product.
- Do not short circuit the battery terminals.
- Consult an expert when in doubt about the operation, safety or connection of the product.
- Maintenance, modifications and repairs must only be completed by a technician or an authorised repair centre.
- If you have questions which remain unanswered by these operating instructions, contact our technical support service or other technical personnel.

##### b) LED light

- Attention, LED light:
  - Do not look directly into the LED light!



- Do not look into the beam directly or with optical instruments!

#### c) Rechargeable battery

- Correct polarity must be observed while inserting the rechargeable battery.
- The rechargeable battery should be removed from the device if it is not used for a long period of time to avoid damage through leaking. Leaking or damaged rechargeable batteries might cause acid burns when in contact with skin, therefore use suitable protective gloves to handle corrupted (rechargeable) batteries.
- Rechargeable batteries must be kept out of reach of children. Do not leave rechargeable batteries lying around, as there is risk, that children or pets swallow them.
- Rechargeable batteries must not be dismantled, short-circuited or thrown into fire. Never recharge nonrechargeable batteries. There is a risk of explosion!

#### Operating elements

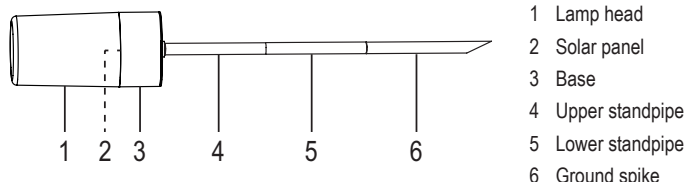

#### Assembly

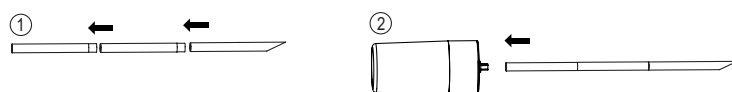

1. Assemble the shaft as shown.
2. Connect the shaft to the base

#### Location

- Insert the ground spike (6) into a level and sufficiently firm surface (e.g. soil). A stony subsurface will cause damage to the ground spike. Hold the ground spike while inserting. Do not hold the lamp head (1). This helps prevent damage to the lamp head. Make sure the ground spike is inserted securely and cannot tip over.
- To optimize charging, place the solar panel (2) in a location exposed to maximum sunlight. Do not set up the solar panel in the shade or under any cover.
- Do not install the product in the direct proximity of other light sources such as yard or street lights, otherwise the product will not switch on automatically at nightfall.

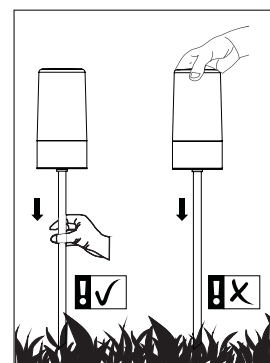

- The product is suitable for use in unprotected outdoor areas. Do not submerge!

#### Solar charging

When using for the first time or after prolonged periods of low sunlight, you should fully recharge the battery.

#### Operation



For first time use, remove the battery insulation strip. See section "Operation - a) First time use and light on".

##### a) First time use and light on

This product comes with a battery installed. For first time use, you must remove the battery insulation strip to activate the power supply.

1. Gently turn the lamp head (1) anticlockwise to unlock, then remove it from the base (3).
2. Find the battery insulation strip on the bottom of the lamp head (1) and simply pull the battery insulation strip out of the battery compartment.
3. Reattach the lamp head to the base (2).



When detaching or reattaching the lamp head from the base, make sure no moisture enters the battery compartment.

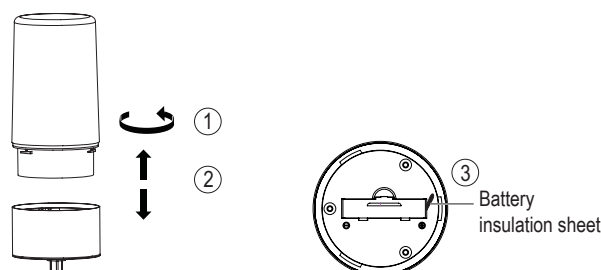

- When the battery insulation sheet is removed, the LED light turns on automatically during darkness.
- When the ambient light reaches a certain brightness level, the LED light will turn off.

→ If required, carry out a performance test in a dark room.

### b) Notes on battery use and charging

- The battery can be fully charged for eight hours in sunny weather, which can light the product for approximately eight hours.
- Keep the product clean. Dust and dirt covering the solar panel reduces charging efficiency.
- During extended periods without sufficient sunlight (especially in winter), the rechargeable battery charges less energy during the day than the lights use at night. So it is possible that the rechargeable battery's charge state will only light the product for a brief time only.
- Cold temperatures adversely affect the battery life. To ensure long, error-free operation, we recommend storing the product in a dry, warm location when not in use.
- You can remove the rechargeable battery before storing the product and charge it with a suitable charger. Observe all relevant information provided in these operating instructions regarding removing or replacing the rechargeable battery.

### c) Remove/Insert rechargeable battery

→ Replace the rechargeable battery if the illumination time reduces significantly despite the battery being sufficiently charged.

When replacing the rechargeable battery, make sure no moisture enters the battery compartment.

1. Remove the lamp head (1) from the base (3). See section "Operation - a) First time use and light on".
2. Find the battery compartment on the bottom of the lamp head and remove the battery compartment.
3. Replace the battery matching the polarity shown inside the compartment.

 Only use a rechargeable battery of the same type and specification as indicated in the section "Technical data".

4. Reverse these steps to reassemble the product.

### Troubleshooting

| Problem                                   | Solution  |
|---|---|
| The light does not turn on automatically. | <ul style="list-style-type: none"> <li>• There is a nearby light source which causes interference with the product. Make sure the product is placed in darkness to activate the light.</li> <li>• The battery power is not sufficient to light the product. Charge the battery.</li> </ul>  |
| The light stays on for short periods.     | <ul style="list-style-type: none"> <li>• Long periods of low sunlight (e.g. cloudy weather or in winter) will cause the battery to recharge less during the day. We recommend using a commercially available charger to charge the battery.</li> <li>• The battery is old and cannot store sufficient charge. Replace with a new one.</li> <li>• See sections "Solar charging" and "Operation - b) Notes on battery use and charging".</li> </ul> |

### Care and cleaning

- Do not use any aggressive cleaning agents, rubbing alcohol or other chemical solutions as they can cause damage to the housing and malfunctioning.
- Never point a water jet, e.g. of a high-pressure cleaning device, at the product.
- Besides occasional cleaning, the product is maintenance-free.
- Let the product cool down sufficiently before cleaning.
- Use a clean, soft and dry cloth to clean the housing. For more stubborn dirt, slightly moisten the cloth with lukewarm water.

### Disposal

#### a) Product



Electronic devices are recyclable waste and must not be disposed of in the household waste. At the end of its service life, dispose of the product in accordance with applicable regulatory guidelines.

Remove the rechargeable battery and dispose of it separately from the product.

#### b) Rechargeable batteries



You as the end user are required by law (Battery Ordinance) to return all used rechargeable batteries. Disposing of them in the household waste is prohibited.

Contaminated rechargeable batteries are labeled with this symbol to indicate that disposal in the domestic waste is forbidden. The designations for the heavy metals involved are: Cd = Cadmium, Hg = Mercury, Pb = Lead (name on rechargeable batteries, e.g. below the trash icon on the left).

Used rechargeable batteries can be returned to collection points in your municipality, our stores or wherever rechargeable batteries are sold.

You thus fulfill your statutory obligations and contribute to the protection of the environment.

### Technical data

|                                    |   |
|------------------------------------|---|
| Power supply .....                 | 1.2 V, 600 mAh Ni-MH, AAA (HR03) rechargeable battery |
| Power consumption .....            | max. 0.07 W   |
| Solar panel .....                  | 2 V, 100 mA, monocrystal                              |
| Illuminant type .....              | LED   |
| LED quantity .....                 | 1 pcs   |
| LED service life.....              | 25000 hours   |
| Charging time .....                | 8 hours (in optimum conditions)                       |
| Illumination time.....             | max. 8 hours with fully charged battery               |
| Light output.....                  | max. 10 lm  |
| Light activation threshold.....    | ≤10 lux   |
| Colour temperature.....            | 1900 K  |
| Ingress protection .....           | IP44  |
| Protection class .....             | III   |
| Material.....                      | Stainless steel + PC                                  |
| Operating/Storage conditions ..... | -20 to +40 °C, ≤100 % RH (non-condensing)             |
| Dimensions (Ø x H) .....           | 90 x 1080 mm  |
| Weight .....                       | 380 g   |