

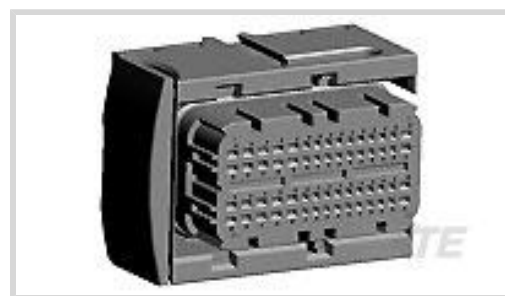

Connectors > Automotive Connectors > Connector Housings > MQS, CONNECTOR HOUSING



Connector & Housing Type: **Housing for Female Terminals**

Mating Tab Width: **.63 mm, 1.5 mm [.025 in, .059 in]**

Connector System: **Wire-to-Board, Wire-to-Device**

Number of Positions: **60**

Sealable: **Yes**

[All MQS, CONNECTOR HOUSING \(575\)](#)

Features

Product Type Features

Connector & Housing Type	Housing for Female Terminals
Connector System	Wire-to-Board, Wire-to-Device
Sealable	Yes
Hybrid Connector	Yes
Primary Locking Feature	Integrated in Housing

Configuration Features

Blank Cavity Position	24, 36
Number of Positions	60
Number of Rows	4

Electrical Characteristics

Operating Voltage	12 VDC
Nominal Voltage Architecture	12 V

Body Features

Body Material	PBT GF
Primary Product Color	Black

Contact Features

Mating Tab Width	.63 mm, 1.5 mm [.025 in][.059 in]
------------------	-----------------------------------

Mechanical Attachment

Mounting Feature	Without
Terminal Position Assurance	Yes
Strain Relief	Yes
Mating Alignment Type	Polarized

Dimensions

Product Width	36.5 mm[1.437 in]
Product Length	60.65 mm[2.388 in]
Product Height	43 mm[1.693 in]
Row-to-Row Spacing	2.54 mm[.1 in]

Usage Conditions

Operating Temperature (Max)	70 °C, 75 °C, 80 °C, 85 °C, 90 °C, 100 °C, 105 °C, 110 °C, 120 °C[158 °F][167 °F][176 °F][185 °F][194 °F][212 °F][221 °F][230 °F][248 °F]
Operating Temperature Range	-40 – 120 °C[-40 – 248 °F]

Operation/Application

Circuit Application	Signal
---------------------	--------

Industry Standards

UL Flammability Rating	UL 94HB
------------------------	---------

Packaging Features

Packaging Quantity	168
Packaging Method	Box

Other

Serviceable	Yes
Connector Position Assurance Capable	No

Product Compliance

[For compliance documentation, visit the product page on TE.com>](#)

EU RoHS Directive 2011/65/EU	Compliant
EU ELV Directive 2000/53/EC	Compliant
China RoHS 2 Directive MIIT Order No 32, 2016	No Restricted Materials Above Threshold
EU REACH Regulation (EC) No. 1907/2006	

Current ECHA Candidate List: JAN 2021
(211)
Candidate List Declared Against: JAN 2021
(211)
Does not contain REACH SVHC

Halogen Content

BFR/CFR/PVC Free, but Br/Cl >900 ppm in other sources.

Solder Process Capability

Not applicable for solder process capability

Product Compliance Disclaimer

This information is provided based on reasonable inquiry of our suppliers and represents our current actual knowledge based on the information they provided. This information is subject to change. The part numbers that TE has identified as EU RoHS compliant have a maximum concentration of 0.1% by weight in homogenous materials for lead, hexavalent chromium, mercury, PBB, PBDE, DBP, BBP, DEHP, DIBP, and 0.01% for cadmium, or qualify for an exemption to these limits as defined in the Annexes of Directive 2011/65/EU (RoHS2). Finished electrical and electronic equipment products will be CE marked as required by Directive 2011/65/EU. Components may not be CE marked. Additionally, the part numbers that TE has identified as EU ELV compliant have a maximum concentration of 0.1% by weight in homogenous materials for lead, hexavalent chromium, and mercury, and 0.01% for cadmium, or qualify for an exemption to these limits as defined in the Annexes of Directive 2000/53/EC (ELV). Regarding the REACH Regulation, the information TE provides on SVHC in articles for this part number is based on the latest European Chemicals Agency (ECHA) 'Guidance on requirements for substances in articles' posted at this URL: <https://echa.europa.eu/guidance-documents/guidance-on-reach>

Compatible Parts



TE Part # CAT-M8793-CH8172
MQS, CONNECTOR HOUSING



TE Part # CAT-M8793-T273
MQS, RECEPTACLE AND TAB



TE Part # 284723-1
COVER FOR 60 POS RECEPTACLE HO

Also in the Series | MQS



Automotive Connector Caps & Covers
(133)

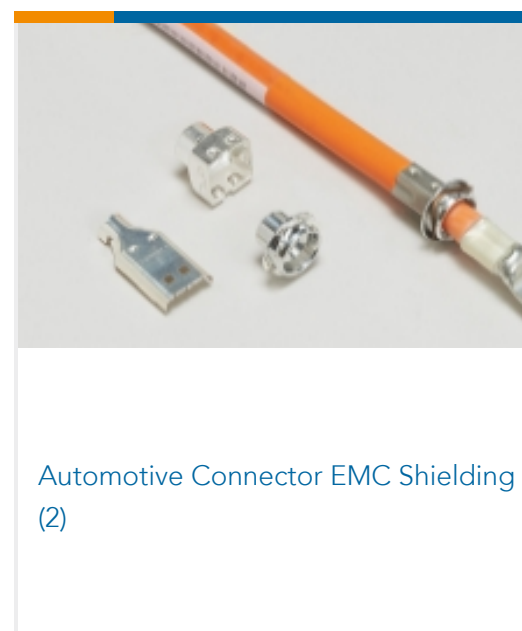

Automotive Connector EMC Shielding
(2)



Automotive Connector Locks &
Position Assurance(29)

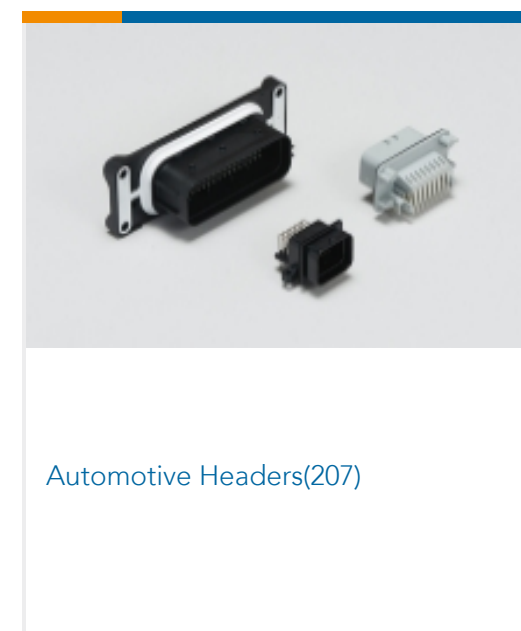

Automotive Headers(207)



Automotive Housings(498)



Automotive Seals & Cavity Plugs(26)



Automotive Terminals(98)



Data Connectivity Headers(1)



Insertion & Extraction Tools(42)



Other Automotive Connector Accessories(13)

Customers Also Bought



TE Part #1-2208709-1
MCON, CONNECTOR HOUSING



TE Part #1-1355132-2
SHIELD, 94POSN., RECEPTACLE HO



TE Part #1-1355133-1
HEBEL F.AUFNAHM-GEH



TE Part #1-1355122-2
SHIELD, 60POSN. RECEPTACLE HOU

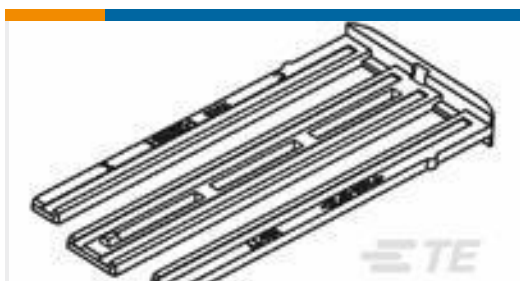

TE Part #1-1355118-1
RETAINER FOR 60POS SOCKET HSG

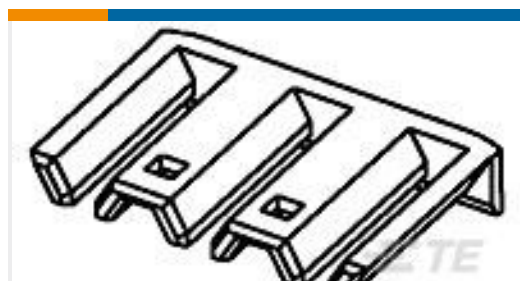

TE Part #1-1355135-1
RETAINER 94P

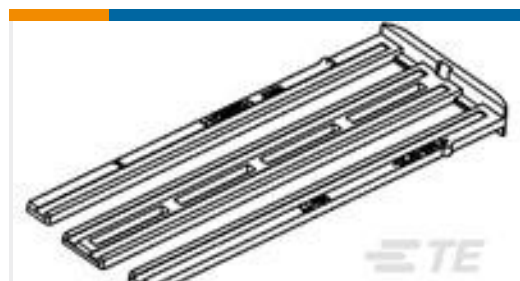

TE Part #1-1355134-1
RETAINER 94P



TE Part #1-1452424-2
BLIND PLUG FOR MCON 1.2 CB (1)



TE Part #1-1452424-1
BLIND PLUG FOR MCON 1.2 CB (0)

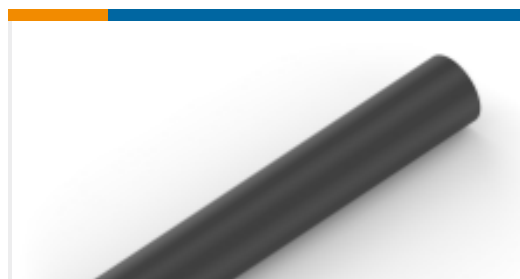

TE Part #NB09466001
ATUM-16/4-0-70MM

Documents



Product Drawings

CARRIER HSG 60POS,ASSY

English

CAD Files

3D PDF

3D

Customer View Model

ENG_CVM_CVM_2-1355123-3_D.2d_dxf.zip

English

Customer View Model

ENG_CVM_CVM_2-1355123-3_D.3d_igs.zip

English

Customer View Model

ENG_CVM_CVM_2-1355123-3_D.3d_stp.zip

English

By downloading the CAD file I accept and agree to the [Terms and Conditions](#) of use.

Datasheets & Catalog Pages

Micro Quadlok Interconnection System (MQS)

English

Product Specifications

Application Specification

English

Product Environmental Compliance

Product Compliance

English

Product Compliance

English