



PIDG

TE Internal #: 320555

PIDG, Knife Disconnects, Tin, Wire Insulation Support, Knife Disconnect Wire Insulation Diameter (Max) .125 in [3.18 mm], Knife Disconnect

[View on TE.com >](#)

Terminals & Splices > Knife Disconnects > PIDG KNIFE DISCONNECT SPLICES

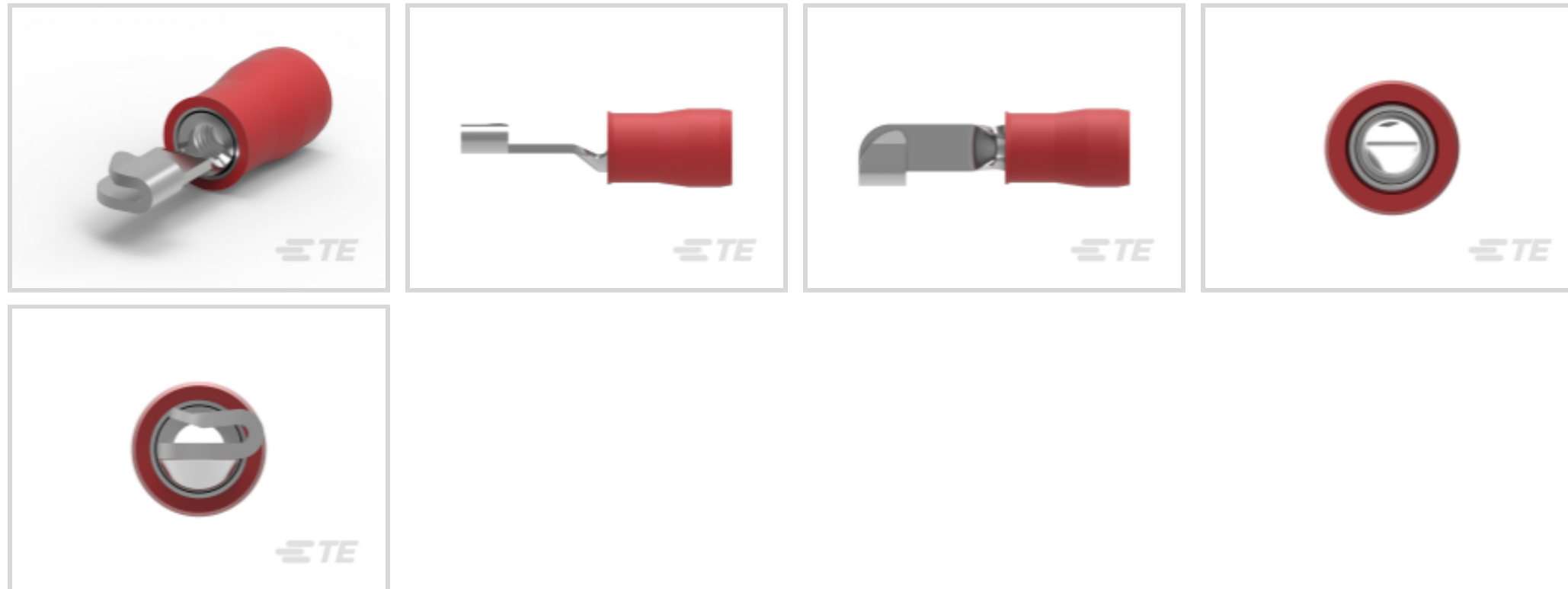

Body Plating Material: Tin

Wire Insulation Support: With

Knife Disconnect Wire Insulation Diameter (Max): 3.18 mm [.125 in]

Terminal & Splice Type: Knife Disconnect

Wire Size: 22 – 16 AWG

[All PIDG KNIFE DISCONNECT SPLICES \(9\)](#)

Features

Product Type Features

Sealable	No
Insulated	Yes

Body Features

Insulation Sleeve Material	Nylon
Body Plating Material	Tin

Contact Features

Terminal & Splice Type	Knife Disconnect
------------------------	------------------

Mechanical Attachment

Wire Insulation Support	With
-------------------------	------

Dimensions

Knife Disconnect Wire Insulation Diameter (Max)	.08 – .125 in 3.18 mm[.125 in]
---	-----------------------------------



Wire Size	.26 – 1.65 mm ²
-----------	----------------------------

Usage Conditions

Insulation Requirement	Partially Insulated
Operating Temperature Range	105 °C[221 °F]

Packaging Features

Packaging Quantity	1000
Packaging Method	Loose Piece

Other

Barrel Color	Red
--------------	-----

Product Compliance

[For compliance documentation, visit the product page on TE.com>](#)

EU RoHS Directive 2011/65/EU	Compliant
EU ELV Directive 2000/53/EC	Compliant
China RoHS 2 Directive MIIT Order No 32, 2016	No Restricted Materials Above Threshold
EU REACH Regulation (EC) No. 1907/2006	Current ECHA Candidate List: JAN 2021 (211) Candidate List Declared Against: JAN 2021 (211) Does not contain REACH SVHC
Halogen Content	Low Halogen - Br, Cl, F, I < 900 ppm per homogenous material. Also BFR/CFR/PVC Free
Solder Process Capability	Not applicable for solder process capability

Product Compliance Disclaimer

This information is provided based on reasonable inquiry of our suppliers and represents our current actual knowledge based on the information they provided. This information is subject to change. The part numbers that TE has identified as EU RoHS compliant have a maximum concentration of 0.1% by weight in homogenous materials for lead, hexavalent chromium, mercury, PBB, PBDE, DBP, BBP, DEHP, DIBP, and 0.01% for cadmium, or qualify for an exemption to these limits as defined in the Annexes of Directive 2011/65/EU (RoHS2). Finished electrical and electronic equipment products will be CE marked as required by Directive 2011/65/EU. Components may not be CE marked. Additionally, the part numbers that TE has identified as EU ELV compliant have a maximum concentration of 0.1% by weight in homogenous materials for lead, hexavalent chromium, and mercury, and 0.01% for cadmium, or qualify for an exemption to these limits as defined in the Annexes of Directive 2000/53/EC (ELV). Regarding the REACH Regulation, the information TE provides on SVHC in articles for this part number is based on the latest European Chemicals Agency (ECHA) 'Guidance on requirements for substances in articles' posted at this URL: <https://echa.europa.eu/guidance-documents/guidance-on-reach>

Compatible Parts

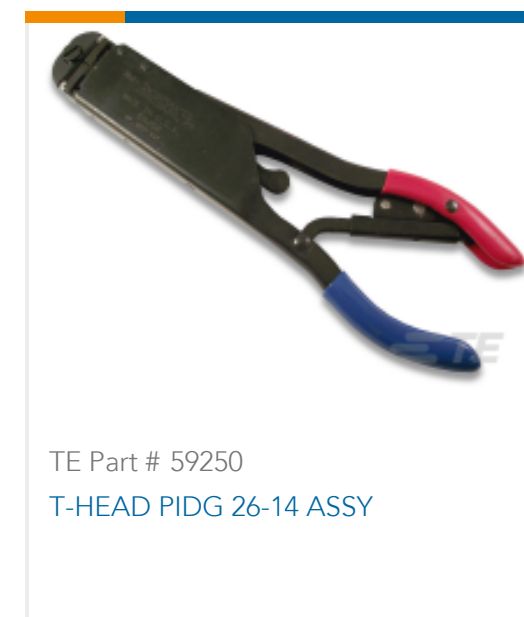

Also in the Series | PIDG

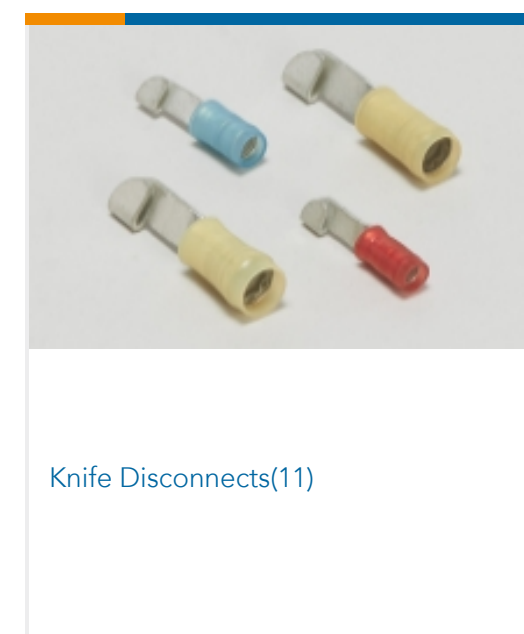
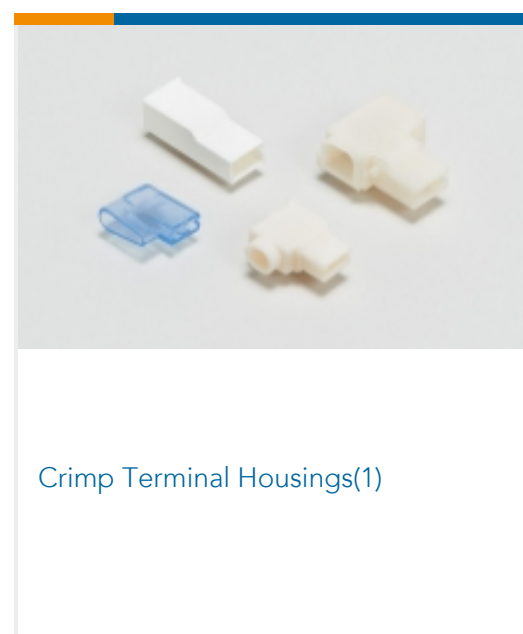
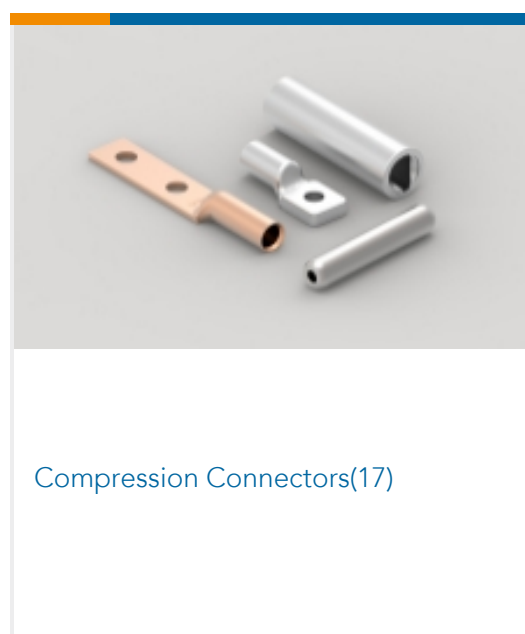



PCB Terminals(9)



Portable Crimp Tools(2)

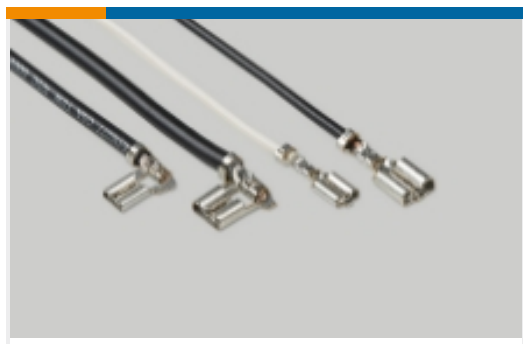

Quick Disconnects(53)



Ring Terminals & Spade Terminals(862)



Special Purpose Terminals(1)



Splices(48)

Customers Also Bought



TE Part #1-320551-2
PIDG RING TONGUE TERMINALS



TE Part #0662-212-1631L
CONT SOC ASSY



TE Part #1662-213-2031
CONT SOC ASSY



TE Part #0662-207-1282
CONT SOC ASSY

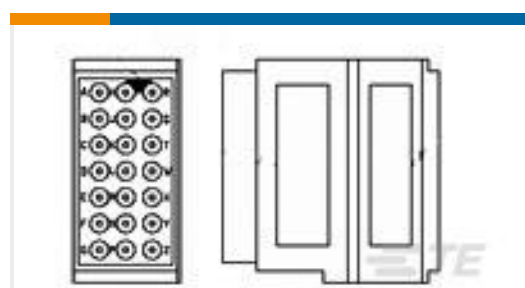

TE Part #1-592629-1
TERM JCT,F/B SZ 21HD,37 BUSS



TE Part #1-321897-0
DG 22-16 HT CHROMEL R 8

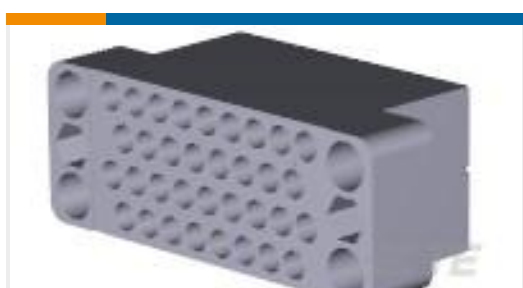

TE Part #200838-2
BLOCK,34 POSN,M SERIES

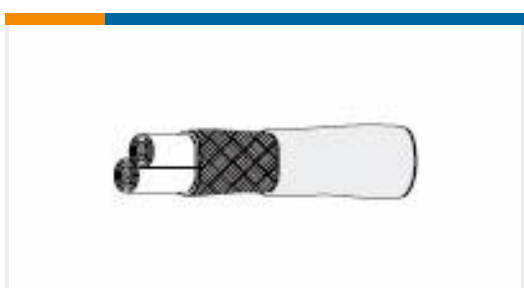

TE Part #123421-000
55A1122-20-9/96-9CS2275



TE Part #YDIV46E13-04SNC009
PLUG ASSY

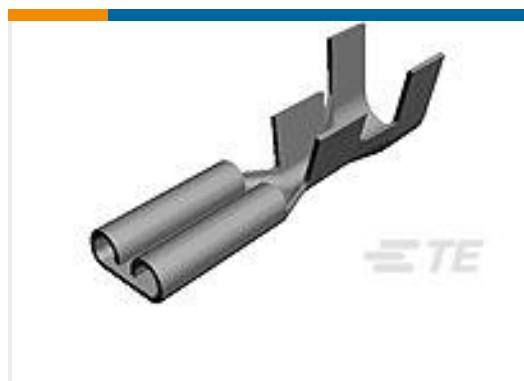

TE Part #170043-4
110 FASTON,REC.,24-20 AWG,TPBR

Documents



Product Drawings

KNIFE DISCONNECT,N PIDG 22-16

English

CAD Files

3D PDF

3D

Customer View Model

[ENG_CVM_320555_E.3d_igs.zip](#)

English

Customer View Model

[ENG_CVM_320555_E.3d_stp.zip](#)

English

Customer View Model

[ENG_CVM_320555_E.2d_dxf.zip](#)

English

3D PDF

English

Customer View Model

[ENG_CVM_CVM_320555_H.2d_dxf.zip](#)

English

Customer View Model

[ENG_CVM_CVM_320555_H.3d_igs.zip](#)

English

Customer View Model

[ENG_CVM_CVM_320555_H.3d_stp.zip](#)

English

By downloading the CAD file I accept and agree to the [Terms and Conditions](#) of use.

Datasheets & Catalog Pages

PIDG TERMINALS & SPLICES Quick Reference Guide

English

Product Specifications

Application Specification

English

Product Environmental Compliance

[MD_320555_04022015442_dmtec](#)

English

[MD_320555_04022015442_dmtec](#)

English

Instruction Sheets

Instruction Sheet (U.S.)

English



[Agency Approvals](#)

[Agency Approval Document](#)

English