

7 6 5 4 3 2 1

ELECTRICAL DIAGRAM
Voltage: 24V

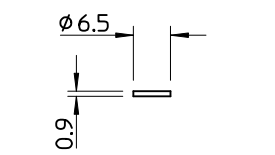

NBR Black Gasket - G13

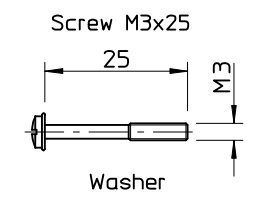
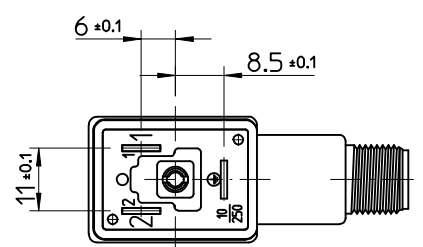
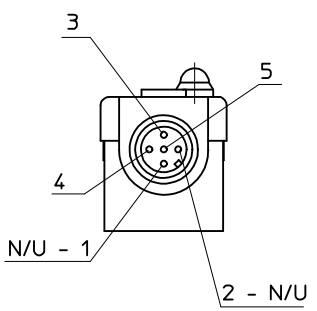
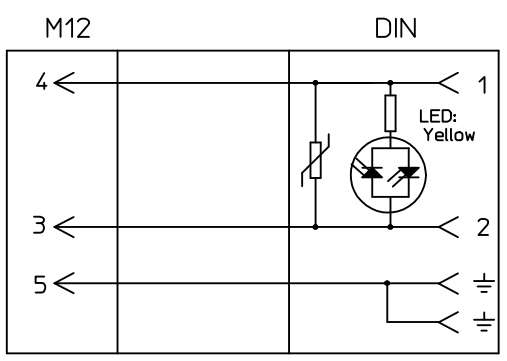
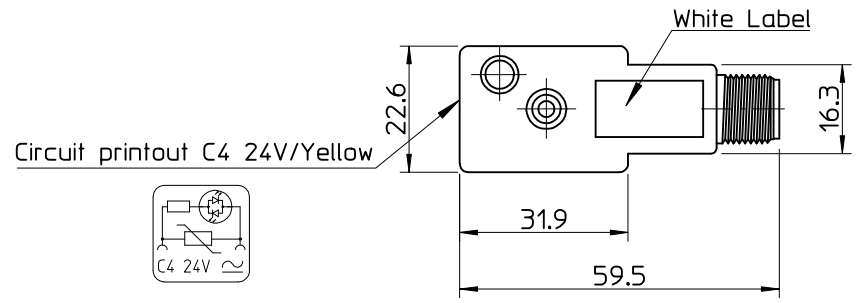
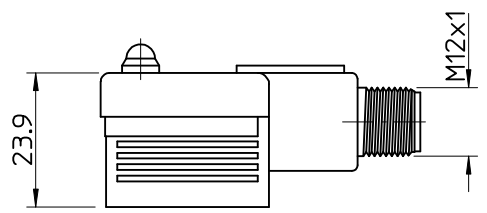
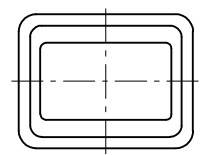

Circuit printout C4 24V/Yellow

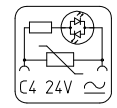

Engineering No.: F850B0

Notes:
1. Single packing in plastic bag
2. All dimensions are references

| | | | | | | | | | | | |
|---|------------------|---------------------|---|----------------------------|----------------------------|--------------------|---|------------------------|------------------------|--|--|
| ORIGINAL RELEASE EC NO: IPG2014-1345 DRWN: JMARSZALEK 2014/01/30 CHKD: MSZWAJKOWSKI 2014/01/30 APPR: MIWASIECZKO 2014/01/30 | DESCRIPTION A | QUALITY SYMBOLS | GENERAL TOLERANCES (UNLESS SPECIFIED) | | DIMENSION STYLE MM ONLY | | SCALE - | DESIGN UNITS METRIC | FIRST ANGLE PROJECTION | | |
| | | ▼=0 ▽=0 | 4 PLACES ± --- ± --- 3 PLACES ± --- ± --- 2 PLACES ± --- ± --- 1 PLACE ± --- ± --- 0 PLACE ± --- ± --- | mm INCH | DRAWN BY JMARSZALEK | DATE 2014/01/30 | TITLE DIN-IND H6 / M12-ST ADAPTER F850B0 | | | | |
| | | ANGULAR ± --- ° | DRAFT WHERE APPLICABLE MUST REMAIN WITHIN DIMENSIONS | MATERIAL NO. 1210370058 | APPROVED BY MIWASIECZKO | DATE 2014/01/30 | DOCUMENT NO. SD-121037-012 | | | | |
| | | SHEET NO. 1 OF 1 | THIS DRAWING CONTAINS INFORMATION THAT IS PROPRIETARY TO MOLEX INCORPORATED AND SHOULD NOT BE USED WITHOUT WRITTEN PERMISSION | | | | | | | | |

6 5 4 3 2 1