

PLEASE CHECK WWW.MOLEX.COM FOR LATEST PART INFORMATION

Part Number: [0638247700](#)
Status: **Active**
Overview: [Application Tooling](#)
Description: Extractor Tool for CTX-J 100 Receptacle Crimp Terminal for Compactus Connector

Documents:
[RoHS Certificate of Compliance \(PDF\)](#)

General	
Product Family	Application Tooling
Series	207121
Comments	See Tooling Specification (PDF) Above
Function	Extraction
Geographic Area	Global
Level of Automation	Manual
More Detailed Tech Information	applicationtooling@molex.com
Overview	Application Tooling
Product Name	CTX-J 100
Tool Type	Extraction Hand Tool
UPC	191128291040
Warranty Disclaimer	CAUTION: Molex tooling crimp specifications are valid only when used with Molex terminals and tooling manufactured by Molex and sold by Molex or authorized distributors ("Molex Tooling"). When using tooling other than Molex Tooling with Molex specific connector systems listed in our ATS documents, the Molex tooling qualification does not apply and the responsibility for full qualification of the connector system is that of the customer. Molex accepts no liability for connector performance or tooling support where tooling other than Molex Tooling is used or where Molex Tooling is modified.

Material Info

Reference - Drawing Numbers	
Application Tooling Documents	ATS-638247700-001

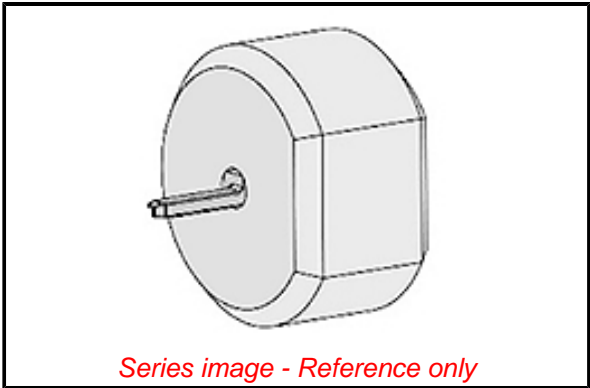

Series image - Reference only

EU ELV Not Reviewed	
EU RoHS Not Reviewed REACH SVHC Not Reviewed Halogen-Free Status Not Reviewed	China RoHS
For more information, please visit Contact US	
China ROHS	Not Reviewed
ELV	Not Reviewed
RoHS Phthalates	Not Reviewed

Search Parts in this Series
[207121](#) Series

PLEASE CHECK WWW.MOLEX.COM FOR LATEST PART INFORMATION