

HELU-S-RK-F-CU Tubular cable lugs for fine stranded wires - straight

uninsulated



Tubular cable lug HELU-S-RK-F-CU

Uninsulated, straight tubular cable lugs in eye type design for fine stranded wires. The expanded sleeve facilitates cable inlet.

Material

Socket: Copper according to DIN EN 13600
Surface: tin plated

Note

Compression instruction and instruction for assembly see chapter "Technical information".

Technical data

Temperature range: up to +120°C

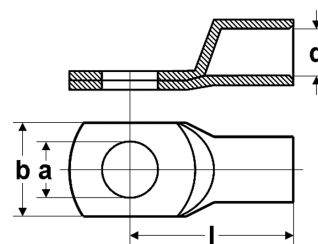

Dimensions

- a Diameter of the boring
- d Inner diameter of the cable insertion
- b Flange width
- l Length till middle of the boring

eye type

Part no.	Type	Cross-section mm ²	a mm	d mm	b mm	l mm	Code type	Weight kg / 1000 items	Unit	Net EUR/ 100 items at a purchase of		
										up to 100	101 - 500	501 - 1000
907409	HELU-S-RK-F-CU 10-5	10,0	5,3	5,0	12,0	23,0	-	7,0	100	o. r.	o. r.	o. r.
907410	HELU-S-RK-F-CU 10-6	10,0	6,4	5,0	12,0	25,0	-	7,6	100	o. r.	o. r.	o. r.
907411	HELU-S-RK-F-CU 10-8	10,0	8,4	5,0	15,0	28,0	-	8,9	100	o. r.	o. r.	o. r.
907412	HELU-S-RK-F-CU 10-10	10,0	10,5	5,0	18,0	31,0	-	9,8	100	o. r.	o. r.	o. r.
907413	HELU-S-RK-F-CU 10-12	10,0	13,0	5,0	20,0	32,0	-	10,0	100	o. r.	o. r.	o. r.
907414	HELU-S-RK-F-CU 16-5	16,0	5,3	6,0	14,0	25,5	-	9,4	100	o. r.	o. r.	o. r.
907415	HELU-S-RK-F-CU 16-6,4	16,0	6,4	6,0	14,0	27,0	-	10,0	100	o. r.	o. r.	o. r.
907416	HELU-S-RK-F-CU 16-8	16,0	8,4	6,0	15,0	29,5	-	11,2	100	o. r.	o. r.	o. r.
907417	HELU-S-RK-F-CU 16-10	16,0	10,5	6,0	18,0	32,0	-	11,2	100	o. r.	o. r.	o. r.
907418	HELU-S-RK-F-CU 16-12	16,0	13,0	6,0	20,0	33,0	-	11,8	100	o. r.	o. r.	o. r.
907419	HELU-S-RK-F-CU 25-6	25,0	6,4	7,7	16,0	32,0	-	14,7	100	o. r.	o. r.	o. r.
907420	HELU-S-RK-F-CU 25-8	25,0	8,4	7,7	16,0	34,0	-	14,3	100	o. r.	o. r.	o. r.
907421	HELU-S-RK-F-CU 25-10	25,0	10,5	7,7	18,0	35,0	-	15,3	100	o. r.	o. r.	o. r.
907422	HELU-S-RK-F-CU 25-12	25,0	13,0	7,7	20,0	36,0	-	16,1	100	o. r.	o. r.	o. r.
907423	HELU-S-RK-F-CU 25-16	25,0	17,0	7,7	26,0	40,5	-	19,1	100	o. r.	o. r.	o. r.
907424	HELU-S-RK-F-CU 35-6	35,0	6,4	9,2	18,0	36,0	-	20,7	100	o. r.	o. r.	o. r.
907425	HELU-S-RK-F-CU 35-8	35,0	8,4	9,2	18,0	36,0	-	20,7	100	o. r.	o. r.	o. r.
907426	HELU-S-RK-F-CU 35-10	35,0	10,5	9,2	18,0	38,0	-	21,4	100	o. r.	o. r.	o. r.
907427	HELU-S-RK-F-CU 35-12	35,0	13,0	9,2	23,0	40,0	-	22,2	100	o. r.	o. r.	o. r.
907428	HELU-S-RK-F-CU 35-16	35,0	17,0	9,2	26,0	45,0	-	24,2	100	o. r.	o. r.	o. r.
907429	HELU-S-RK-F-CU 50-6	50,0	6,4	11,2	22,0	42,0	-	32,5	100	o. r.	o. r.	o. r.
907430	HELU-S-RK-F-CU 50-8	50,0	8,4	11,2	22,0	42,0	-	32,2	100	o. r.	o. r.	o. r.
907431	HELU-S-RK-F-CU 50-10	50,0	10,5	11,2	22,0	43,0	-	33,3	100	o. r.	o. r.	o. r.
907432	HELU-S-RK-F-CU 50-12	50,0	13,0	11,2	23,0	44,0	-	33,9	100	o. r.	o. r.	o. r.
907433	HELU-S-RK-F-CU 50-14	50,0	15,0	11,2	25,0	45,5	-	36,0	100	o. r.	o. r.	o. r.
907434	HELU-S-RK-F-CU 50-16	50,0	17,0	11,2	28,0	48,5	-	36,5	100	o. r.	o. r.	o. r.

Continuation ►

HELU-S-RK-F-CU Tubular cable lugs for fine stranded wires - straight

uninsulated

eye type

Part no.	Type	Cross-section mm ²	a mm	d mm	b mm	l mm	Code type	Weight kg / 1000 items	Unit	Net EUR/100 items at a purchase of		
										up to 100	101 - 500	501 - 1000
907435	HELU-S-RK-F-CU 70-6	70,0	6,4	13,5	25,0	46,0	-	44,3	50	o. r.	o. r.	o. r.
907436	HELU-S-RK-F-CU 70-8	70,0	8,4	13,5	25,0	45,5	-	48,0	50	o. r.	o. r.	o. r.
907437	HELU-S-RK-F-CU 70-10	70,0	10,5	13,5	25,0	47,0	-	48,4	50	o. r.	o. r.	o. r.
907438	HELU-S-RK-F-CU 70-12	70,0	13,0	13,5	26,0	47,0	-	48,4	50	o. r.	o. r.	o. r.
907439	HELU-S-RK-F-CU 70-16	70,0	17,0	13,5	28,0	50,0	-	50,5	50	o. r.	o. r.	o. r.
907440	HELU-S-RK-F-CU 70-20	70,0	21,0	13,5	31,0	54,5	-	55,2	50	o. r.	o. r.	o. r.
907441	HELU-S-RK-F-CU 95-6	95,0	6,4	15,5	29,0	50,5	-	65,0	50	o. r.	o. r.	o. r.
907442	HELU-S-RK-F-CU 95-8	95,0	8,4	15,5	29,0	50,5	-	66,2	50	o. r.	o. r.	o. r.
907443	HELU-S-RK-F-CU 95-10	95,0	10,5	15,5	29,0	53,0	-	71,5	50	o. r.	o. r.	o. r.
907444	HELU-S-RK-F-CU 95-12	95,0	13,0	15,5	29,0	52,5	-	71,1	50	o. r.	o. r.	o. r.
907445	HELU-S-RK-F-CU 95-16	95,0	17,0	15,5	29,0	55,0	-	71,9	50	o. r.	o. r.	o. r.
907446	HELU-S-RK-F-CU 95-20	95,0	21,0	15,5	35,0	60,0	-	76,1	50	o. r.	o. r.	o. r.
907447	HELU-S-RK-F-CU 120-10	120,0	10,5	16,8	31,0	56,5	-	80,7	50	o. r.	o. r.	o. r.
907448	HELU-S-RK-F-CU 120-12	120,0	13,0	16,8	31,0	56,0	-	80,7	50	o. r.	o. r.	o. r.
907449	HELU-S-RK-F-CU 120-16	120,0	17,0	16,8	31,0	58,0	-	83,6	50	o. r.	o. r.	o. r.
907450	HELU-S-RK-F-CU 120-20	120,0	21,0	16,8	35,0	63,0	-	87,5	50	o. r.	o. r.	o. r.
907451	HELU-S-RK-F-CU 150-10	150,0	10,5	19,0	35,0	59,0	-	104,0	25	o. r.	o. r.	o. r.
907452	HELU-S-RK-F-CU 150-12	150,0	13,0	19,0	35,0	58,5	-	106,2	25	o. r.	o. r.	o. r.
907453	HELU-S-RK-F-CU 150-16	150,0	17,0	19,0	35,0	63,0	-	111,9	25	o. r.	o. r.	o. r.
907454	HELU-S-RK-F-CU 150-20	150,0	21,0	19,0	35,0	66,0	-	116,1	25	o. r.	o. r.	o. r.
907455	HELU-S-RK-F-CU 185-10	185,0	10,5	21,0	38,0	67,0	-	130,3	25	o. r.	o. r.	o. r.
907456	HELU-S-RK-F-CU 185-13	185,0	13,0	21,0	38,0	67,0	-	121,5	25	o. r.	o. r.	o. r.
907457	HELU-S-RK-F-CU 185-16	185,0	17,0	21,0	38,0	69,5	-	128,8	25	o. r.	o. r.	o. r.
907458	HELU-S-RK-F-CU 185-20	185,0	21,0	21,0	38,0	71,0	-	139,5	25	o. r.	o. r.	o. r.
907459	HELU-S-RK-F-CU 240-12	240,0	13,0	24,0	44,0	82,0	-	214,0	20	o. r.	o. r.	o. r.
907460	HELU-S-RK-F-CU 240-16	240,0	17,0	24,0	44,0	85,0	-	219,4	20	o. r.	o. r.	o. r.
907461	HELU-S-RK-F-CU 240-20	240,0	21,0	24,0	44,0	85,0	-	222,0	20	o. r.	o. r.	o. r.

Dimensions and specifications may be changed without prior notice.

o. r. = on request