

User Manual

VER:NDL703P-V1.2

1.Function Introduction

Thank you for buying our hunting camera. This product is a dedicated high-definition digital camera that can support record and observe wildlife. This camera has pyroelectric animal/human sensing technology as well as automatically capture high-resolution images and smooth videos technology. This hunting camera will be in a state of energy saving when there is no detection of the animal (body) which can be alerted for a long time. In order to operate the camera, please read this manual carefully before using.

The contents contained in this manual refer to the latest information when the manual is written. Due to different technical development and production batches, it may be slightly different from your actual use. Please refer to the actual product functions.

2.Notice for use

Instructions for use:

- Before using this product, please insert the battery first, open the hunting camera, find the battery box, put into 8 1.5VAA battery, and at the same time ensure that the battery polarity is correct.

●When using a power adapter (optional), find a DC port at the bottom of the camera and plug one end of the power adapter into the power supply. (Note: To use the DC 6.0V/2A adapter, Outer ϕ 3.5mm, inner ϕ 1.3mm)

●If you use a newly purchased memory card for the first time, make sure to format the memory card before using it.

●This camera must use C10 or higher grade brand high speed SD card.

The usage of the memory card is as follow:

●According to the instruction next to the memory card slot (chip up), push the SD card into the slot until the card is fully inserted pop up.

●To remove the SD card, gently press the back of the memory card inward and the card will

●After repeated use or improper use, the memory card will degrade its performance and may damage the recorded data. You need to buy a new memory card.

Note: The memory card will get hot after being used for a long time, which is normal.

3.Button, Interface, Indicator Function Introduction

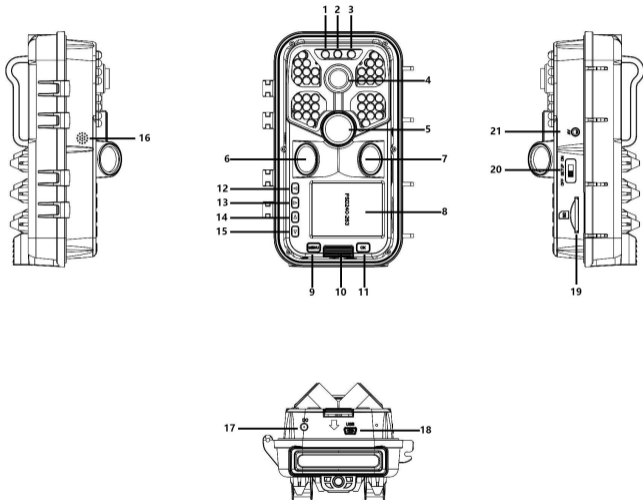

1. Left indicator
2. .Light sensor
3. Right indicator
- 4.Lens
5. primary sensor
6. Left PIR
7. Right PIR
8. LCD
9. MENU
10. Battery bin switch button
11. OK key
- 12.left key
- 13.right key
14. up key
- 15.Down key
- 16.speaker
17. DC port
- 18.USB port
19. SD card slot
20. OFF/SETUP/ON
- 21.AV port

Key and interface	Functions
MODE KEY	<ol style="list-style-type: none"> 1.Click the preview interface to enter the main menu OR return to the previous menu 2.Click on playback interface to enter the settings menu or return to the previous menu
OK key	<ol style="list-style-type: none"> 1.On preview interface of video or photo, Click it to record or take photo 2.On menu setting, click to confirm 3.On playback, click to play video or pause

UP Key	<ol style="list-style-type: none">1.On menu setting, click for up choice2.On time or password setting, click to choose up digit3.On Preview interface, Long press 3seconds to turn on WIFI, short press to turn off WIFI4.On photo preview interface , click switching to video preview interface5.On Playback, click to switch up file
Down	<ol style="list-style-type: none">1.On menu setting, click for down choice2.On time or password setting, click to choose down digit3.On video preview interface, click switching to photo preview interface4.View Playback, short press Down key to switch files
Left Key	<ol style="list-style-type: none">1.Press this key to select left when the submenu sets multiple digits
Right Key	<ol style="list-style-type: none">1.Press this key to select right when the submenu sets multiple digits2.Click “ RIGHT” Key on the preview interface to enter playback mode or return to the preview interface from playback mode

OFF/SETUP/ON	<ol style="list-style-type: none">1. Switch to OFF mode to shut down2. Switch to SETUP mode to setup3. Switch to ON mode to monitor
Battery bin switch button	Press down, battery bin pop up, replace battery

4.System settings

1. Switch machine/setting/hunting mode

- When the battery is put in, push the switch from the “OFF” to the “SETUP” to set up the function
- It is monitor mode when push the mode to “ON”, then the camera will perform operations as setting Photo, Video or Photo+Video.
- Push switch to “OFF”, the camera will be turned off, then LCD screen will show nothing.

2.Working Mode

The Camera have three modes: Photo, Video, and Photo+Video.

●Photo mode:

Photo resolution option: 30MP、24MP、20MP、16MP、12MP、8MP、5MP、3MP、1MP, Higher resolution means larger photo size, then the SD card can store fewer photos, otherwise more.

●Video mode:

Video resolution option: 4K、2K、1296P、1080P、720P、480P、360P

Higher resolution means larger video size, then the SD card can store fewer video, otherwise more.

●Photo + video mode:

Once choose Photo + Video mode and pull to “ON”, the camera takes photo firstly, then record.

Remarks: The screen will automatically be turned off during recording for power saving, users can click any key to recover display.

3. Picture Number

●One, two and three and continuous photo taking functions can be selected

4. Shutter speed

●Shutter speed option: 1/15、1/20、1/30, the night vision is different in brightness

5. Video length

●Set the video length (5-180 seconds optional), more longer setting time, more longer video time, and the default video length is 5 seconds

6. Record Audio

●Option: “ON” or “OFF”, when choose “ON”, the video recorded with sound, otherwise without

7. PIR Interval

●set PIR interval, when different modes are selected, the time period is different

Photo: PIR interval setting option: 5seconds~ 60minutes

Video: PIR interval setting option: 10seconds~ 60minutes

Photo+Video interval setting option: 10seconds~ 60mintues

The camera does not record any images or videos during the selected time interval, which prevents the memory card from saving too many files and occupying memory capacity.

8. PIR Sensitivity

●The sensitivity of the main sensor setting, when the indoor environment is very small, "Low sensitivity" shall be selected. When the outdoor environment is normal, "medium sensitivity" shall be selected. When the external environment has a great impact on the shooting, "high sensitivity" shall be selected.

9. IR LED

●Option: Auto, Economy, OFF

Auto: If it is shooting under night environment, the camera will automatically adjust the brightness of the lamp according to the current battery power usage;

Economy: As long as the IR led light is turned on, the lamp will be in a weak brightness to make the battery longer;

OFF: IR light won't be turn on even if the environment is completely dark.

Remark: Auto option is recommended, the camera will adjust the brightness of IR led light automatically according to it's power state under this model.

10. Time Lapse

●Time lapse setting. For example, to observe the flowering process of plants, you can use this function, setting the interval between each shooting then the camera will record the whole process of flowering. When choose Time Lapse, press "OK" key to open this menu, and select "ON" , the screen will pop up a Hours/Minutes/Seconds window to set (when this function is on, the main /secondary sensor does not work).

11. Monitoring Period

● Camera working time setting. Select "Monitor Period ", then press "OK" key to select " ON ". Then you can set the start time and end time of the camera . After setting up, the camera will only work within the set time every day, and the other time will be in standby state. (when this function is on, the main / secondary sensor does not work)

12. Side PIR Setup

Option: ON or OFF

The induction is wider when both sides PIR are ON(for the purpose of pre-opening), when it' s OFF, the two sides of the induction will not start.

13. Date/Time

Date and time setting. Press "OK" key to enter the settings dialog box. Press UP/Down key to choose the number, and press LEFT/RIGHT key to confirm the present digit and enter next option. When it shows YY/MM/DD, press UP/DOWN key to change the format (YY/MM/DD,MM/DD/YY,DD/MM/YY), and finally press OK/Menu to confirm and finish setting

14. Time Format

Option: 12 or 24 hours settings.

15. Password Setting

● Choose the menu "password settings ", then press the "OK" key, choose " ON ", press UP/DOWN key to set a 4-digits or 4-letters password between 0-9 or a-z, when the first digit(letter) is set, press LEFT/DOWN key to set the next digit(letter), and press "OK" key to confirm and return to the superior menu after setting up(Quick unlock function: if you forget the boot password, the camera's default initial password is : "1111", switch the mode key to "SETUP" mode, then unlock the camera.)

16. Bluetooth

● Option: ON or OFF

When it's ON, mobile phone can search to find the Bluetooth whether the mode is "ON" or "SETUP", mobile can search to find the Bluetooth; When it's OFF, no Bluetooth can be searched.

17. WIFI name

● The WIFI SSID name can be modified, after the modification, the WIFI name will be presented when turn on WIFI, and this WIFI SSID name can be searched by mobile phone.

18.WIFI password

●After WIFI password is set successfully, enter this password when the mobile phone is connected to WIFI camera.

19. AUTO WIFI OFF

●Set the time of camera shuts down WIFI automatically. Choose the “AUTO WIFI OFF” option, press “OK” to set 1minute/2minutes/3minutes. When the camera is in monitoring or SETUP mode, after turning on WIFI or after connecting to WIFI and using APP, the mobile phone is disconnected from the camera, and the camera will automatically exit WIFI and return to ON (monitoring) Or SETUP mode.

20.Beep Sound

●Option: ON or OFF. The button and switch sound are muted when set to off, the button.

21.Format

●SD card can be formatted, and all data on the SD card will be cleared after formatting.

22.Default Setting

●All functions will default to initial state when restore default setting.

23. Playback

23.1 Turn the switch from "ON" to "SETUP" , press "Right" key to playback mode, press the UP/DOWN key to view the video and pictures , when playing back the video, press "OK" key to start playing and press "OK" again to stop it. During the playback, press "UP" key to quick play by twice /Four times/ 8 times; Press the "DOWN" key to back play -2times/-4 times/ -8 times. If you don't want to play the current video, please press the "MENU" key to exit the current playback.

23.2 Long press the "OK" button for 3 seconds in the playback interface to enter the settings menu (delete / protect)

23.3 Delete current and delete all: press "OK" key to enter the delete menu, you can delete the selected picture or video in the camera memory card, select "delete current" or "delete all ", press "OK" key to confirm. Press "MENU" key to return to the superior menu during setting.

23.4 Protect

Select "Lock Current" to prevent the currently set document from being accidentally deleted

Select "Unlock Current" to remove current document protection

Select "Lock All" to prevent all documents in the memory card from being accidentally deleted

Select "Unlock All" to Unlock Multiple Document Protection

5. Device connect with Phone by WIFI

- Please turn off your cellular data before using, And turn on the Bluetooth and WIFI function in the phone settings, as (Figure 1/2).
- Click the APP icon “Hunting 4K Pro” to pop up the “Turn on Bluetooth” interface, as (Figure 3).
- Click “Turn on Bluetooth” to prompt “Access location info”, please select “Allow only when using the app” as (Figure 4)
- Select the Bluetooth name “CAMERA-XXXXXXXX” corresponding to the device, and click “TURN ON WiFi”, as (Figure 5)
- Enter the countdown while the device WiFi is activated, as (Figure 6).
- After the countdown is completed, the mobile phone will automatically jump to the WLAN menu of the mobile phone, select the “Hunting 4K” WIFI name, enter the password: 12345678 according to the prompts, and connect to the device WiFi. After the connection is successful, the device will display, as (Figure 7).
- Click the back button of the phone to enter the APP and prompt “Confirm connection”, please select “Keep”, if you select “Switch network”, the WIFI connection will be disconnected, as (Figure 8).
- Enter the real-time monitoring screen, you can take pictures、 video、 playback、 set parameters etc. as(Figure 9).

Figure 1**Figure 2****Figure 3****Figure 4****Figure 5****Figure 6**

Figure 7



Figure 8

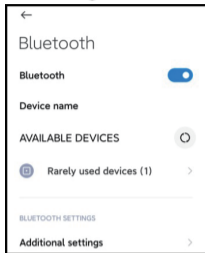
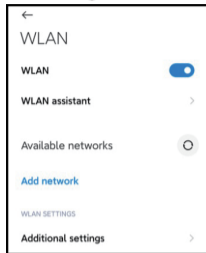
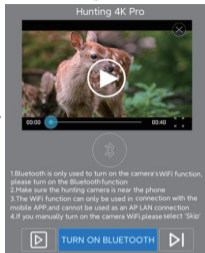
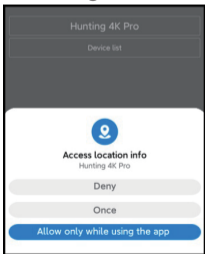
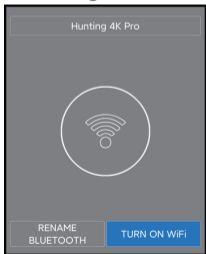
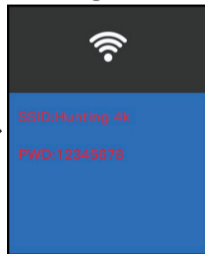
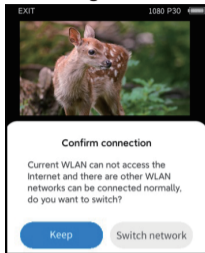
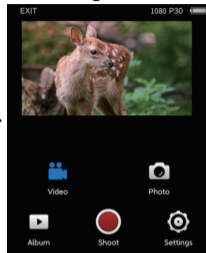

Figure 9



6. Operating mode description

1. Calibrate the installation position of camera

In the “SETUP” mode, the best shooting angle and range of the camera can be calculated

1.1. During the calibration, you can choose whether to use the side sensor for observation.

1.2. The steps to calibrate the camera position are as follows:

1.2.1 Tie the camera to a tree or a 1~2meter high object, adjust the direction of the camera's lens, and then slowly move the camera to the other side to monitor the object's motion track.

1.3. If the indicator light of the side sensor is on, it means that the side sensor has detected the moving object. If the indicator light of the corresponding main sensor is on, it means that the main sensor has detected the moving object. In this way, the best position for installing the camera can be known.

1.4. Only in the test mode, when the sensor detects the moving infrared body temperature, the indicator light will turn on, and the LED will be off in the “ON” mode.

1.5. Make sure that the camera will not be interfered unnecessarily when it is working, and avoid direct sunlight or near the branches. The detection range of the sensor is about 120 degrees, and the lens range is about 90 degrees.

2. Normal operation mode

In this mode, the camera is triggered to shot by the sensor, the camera enters monitoring mode when the switch is “ON”. After 5 seconds, the LED lights will turn off and the camera starts to work independently and enter the standby mode. Once an animal enters the detection area detected by the side sensor, the camera will be activated and detect the it’ s motion track. If the animal continues to move to the main sensor detection area, the camera will take photos or record video automatically. And if the animal leaves the area detected by the main sensor, the camera will turn off and return to standby mode.

3.Night mode

3.1. At night, the infrared LED light will turn on automatically to provide necessary lighting for taking photos. The LED light illuminates with a range of about 3-20 meters. If the animals are too close to the camera, it may cause overexposure.

3.2. In the night mode, the picture or video is only black and white. When recording video for a long time, low voltage may have a big effect on the stability of the camera, so DO NOT record video at night when the power is low.

Note: When the camera is used at night and the battery voltage is low, the current increases due to the infrared light, and low battery may have a big effect on the stability of the camera, then the camera cannot take photos/video or take very dark images, but it does not affect the daytime photo or video.

7. Image / Data output

1.TV connection

This camera can transmit video to external monitor or TV set. Please follow the instructions below

- 1.1.Turn on the TV, and connect the TV to the camera with AV data cable.
- 1.2.Turn on the camera and turn the switch to "Setup".
- 1.3. After successful connection, the camera will enter the playback mode, and the LCD screen will turn black, the captured picture will be displayed on the TV screen.

8.Connect the computer to download photos / videos

After the camera is connected with PC, a removable disk will be added in the "my computer" window. Access the "DCIM " folder in the removable disk, you can copy files to your computer hard disk from MOVIE/PHOTO folder.



Note: do not disconnect the data cable in the process of downloading, and in order to avoid data loss, do not plug and unplug the memory card when connecting.

9. Technical Parameters

LCD Screen	2.4" LCD
Camera	5.0Mega pixel
Photo Resolution	30M, 24M, 20M, 16M, 12M, 8M, 5M, 3M, 1M
Video Resolution	4K, 2K, 1296P, 1080P, 720P, 480P, 360P
Menu language	English, Chinese, German, French, Italian, Spanish, Portuguese, Dutch, Japanese and Danish
Memory card	SD card support 32GB
Format	JPEG, MP4
APP	Android @IOS: Hunting 4K Pro
USB	USB 2.0
DC input	DC-6V/2A adapter
Support System	Windows XP/Vista/7/8, Mac 10.2, Win 10
Dimension	165x90x60MM

Note: the product design specifications are formulated according to the latest information in the preparation of this manual, and are subject to change without notice. Please refer to the actual camera.

Installation instructions for solar power bank:



Before loading the solar power bank into the machine, check that there are no water droplets or stagnant water in the type-c interface, dry the water and load it again.

