

Read the safety instructions supplied with the product before using

## 1 Set printer up

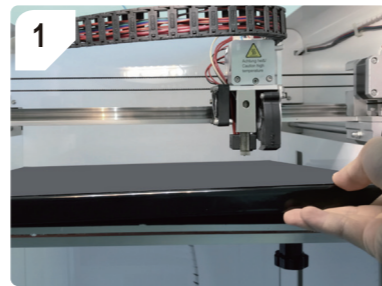

Insert the print bed and magnetic mat.

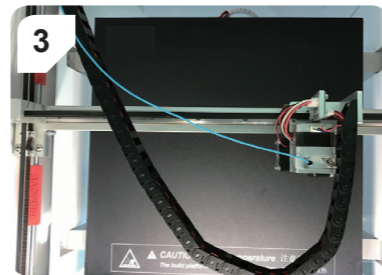
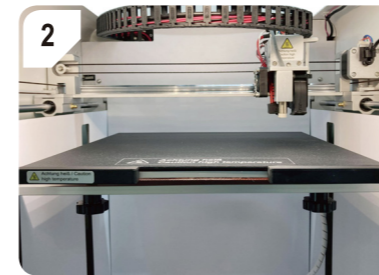

Remove the styrofoam pads

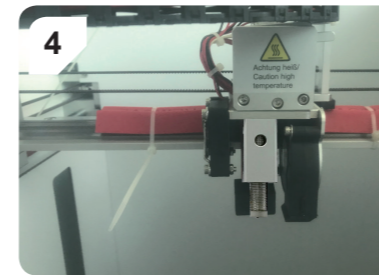

1. Install the spool holder.  
2. Slide the filament spool onto the holder.

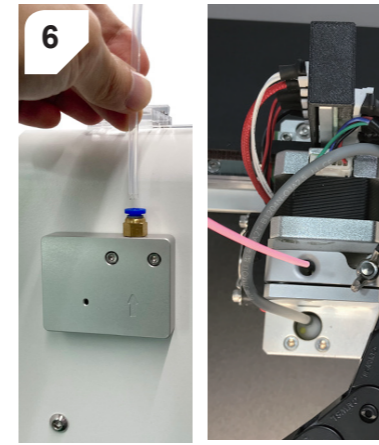

1. Connect the mains cable to the power inlet on the printer.  
2. Flip the power switch into the position I to switch on. The display lights up.

## 2 Calibrate Z-Offset



Insert the print bed and magnetic mat.

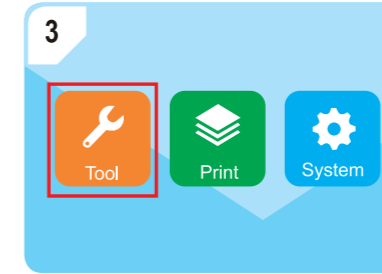

Open the menu **Tools**.

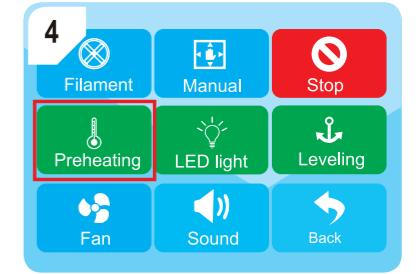

Touch the button **Preheating** to start the pre-heating process.



Wait until the preheat temperature has been reached.

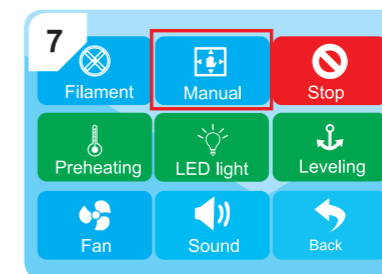

Open the menu **Manual**.

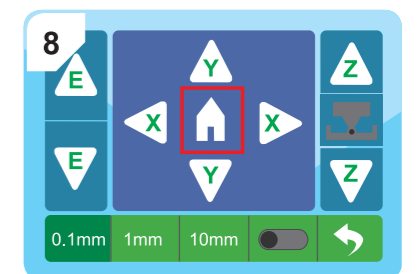

Touch **home** to move the extruder to its zero position.

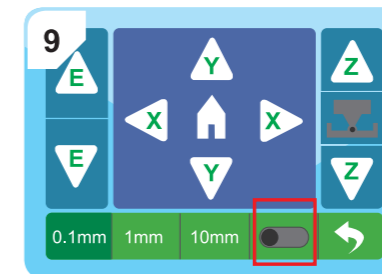

Activate the Z-offset calibration with the slider.

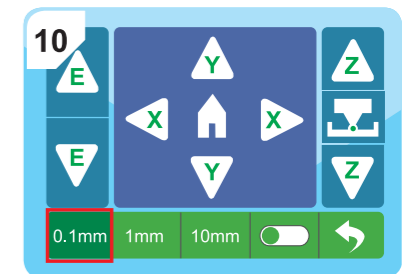

Touch the distance increment **0.1 mm** to activate it.

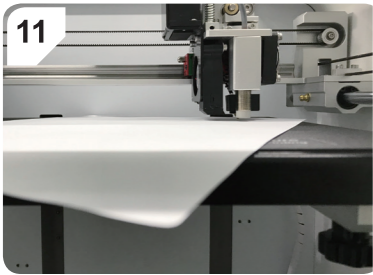

Slide one sheet of A4 paper (80 g) between the nozzle and the print bed.

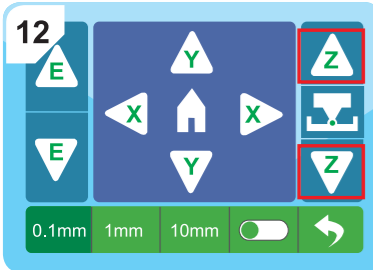

Slide the paper back and forth while repeatedly touching the button ▲ or ▼ to lift or lower the print bed. If you notice slight resistance between nozzle, paper, and print bed, touch the button ⚙️ to finish the calibration.

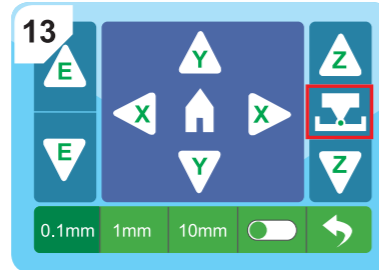

Confirm the Z-offset calibration.

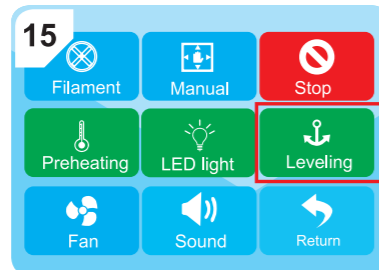

Touch the button **Leveling** to start "Auto-levelling".

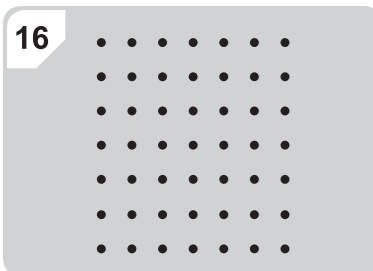

Wait for "Auto-levelling" to finish.

### 3 Load filament

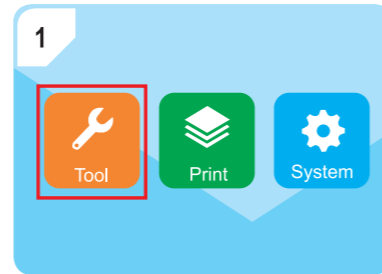

Open the menu **Tools**.

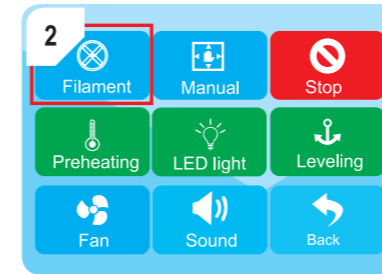

Open the menu **Filament**.

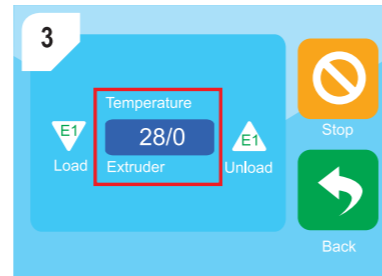

Touch the temperature display to preheat the extruder.

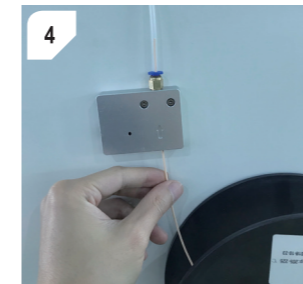

Cut the filament at an angle and then feed it into the feeder.

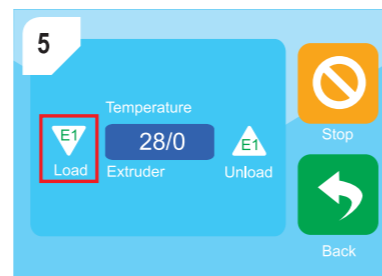

Touch the button **E1 Load** to load the filament into the extruder.

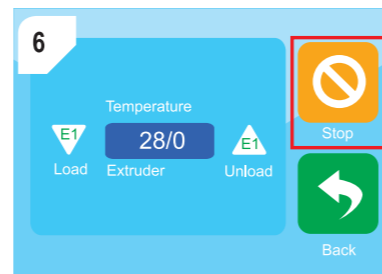

Touch the button **Stop** as soon as molten filament flows from the nozzle.

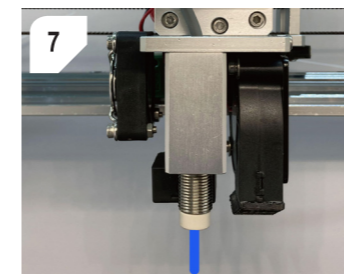

### 4 Print



#### CAUTION

**Hot print bed**  
Touching hot print bed can cause burns  
Let cool down before touching



Connect the USB memory stick that contains the print file to the USB port.

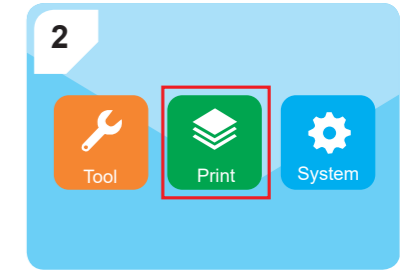

Open the menu **Print**.

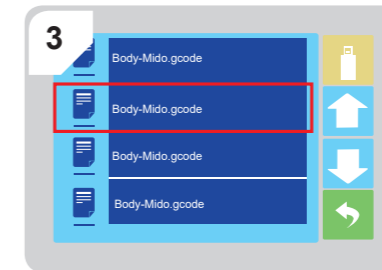

Select file to print. The printer starts printing.

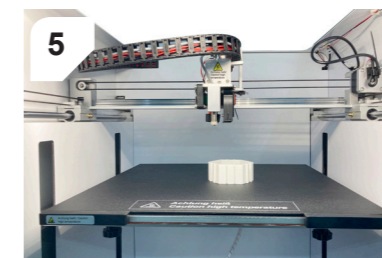
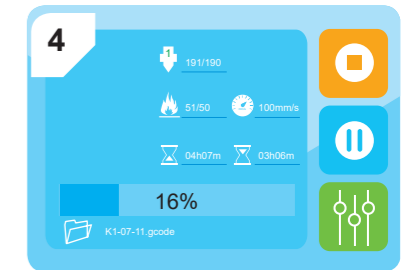

After printing is complete, let the printer cool down to room temperature.

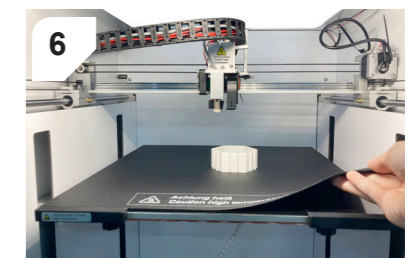

Remove the magnetic mat.