

# E/NTES



## ENS.CCT Series Clamp Type Current Transformer

The ENS.CCT series current transformers offer the advantage of one handed operation. In this way the series offer safe and easy mounting and demounting without interrupting the energy.

- Save time for instant measurements
- Low consumption with magnetic core
- Delicate, exquisite and weightless, conveniently to install
- Ideal for projects where the meter needs to be portable between panels
- Safe and handy design
- Prevention of malfunction (by means of the internal structure) where the ends of the secondary wires are left open in conventional current transformers
- Solution without cutting power: Measuring without the need of disconnecting primary busbar

### Application Area

- Easy mounting to busbar or cable in areas where it is not possible to interrupt the energy
- Narrow and small panel applications thanks to weightless and compact design
- Mobile measurements



## Technical Specifications

	ENS.CCT 10	ENS.CCT 16	ENS. CCT 24	ENS.CCT 36
Rated Primary Current (In)	30A, 50A, 75A	100A, 120A	100A, 150A, 200A, 250A, 300A, 400A	400A, 500A, 600A
Rated Secondary Value	333 mV		333 mV/5A	
Current Range	1A - In			
Max Withstand Current	1,2 In			
Accuracy Class	Class 1		Class 3/1	Class 1/0,5
Working Frequency	50/60Hz			
Phase Displacement	+1,5 ± 1°	+1,0 ± 1°	+0,5 ± 0,5°	+0,5 ± 0,5°
Linearity Error	-1 ± 1%	-1 ± 1%	-1 ± 1%	-1 ± 1%
Max. Voltage / Voltage Test	0,72 / 3 kV	0,72 / 3 kV	0,72 / 3 kV	0,72 / 3 kV
Overvoltage Category	CAT III			
Working Environment	Temperature: -10 / 70°C, Humidity ≤ 85%, Indoor			
Storage Condition	Temperature: -20 / 80°C, Humidity ≤ 85%,			



## Dimensions

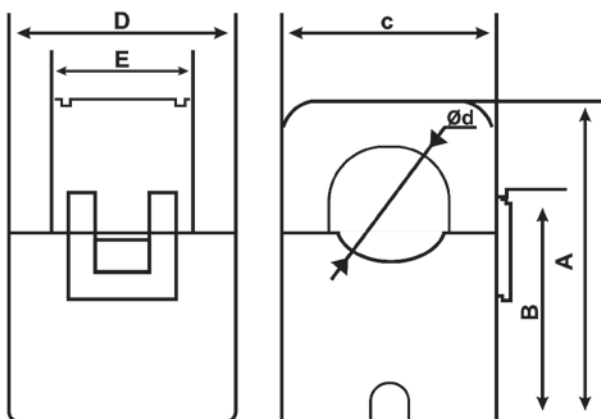

Model Size	A (mm)	B (mm)	C (mm)	D (mm)	E (mm)	Ø d (mm)
ENS.CCT 10	40.5	28.6	22	26	14.5	10
ENS.CCT 16	44	31	29	31	19	16
ENS.CCT 24	75	50	45	35	19.5	24
ENS.CCT 36	91.6	62	57.4	40.9	22.8	36



01.02.2022

## HEADQUARTERS

Address: Dudullu OSB; 1. Cadde; No: 23 34776 Umraniye - ISTANBUL / TURKIYE Tel: +90 216 313 01 10 Fax: +90 216 314 16 15 Sales Fax: +90 216 365 71 71  
E-mail: contact@entes.eu Web: www.entes.eu Call Center Technical Support: 0850 888 84 25 Coordinates: 40,995852 N, 29,178398 E

## INTERNATIONAL BRANCH OFFICES

ISTANBUL : contact@entes.eu Tel: +90 216 313 01 10 Fax: +90 216 314 16 15  
INDIA : contact@entes.in Tel: +91 981 - 2980004  
GREECE : contact@entes.eu Tel: +30 2310 706999 +30 2310 707296  
GERMANY : kontakt@enteselektronik.com Tel: +49(0) 7022-931992-0

© ENTES Elektronik Cihazlar İmalat ve Ticaret A.Ş.

