

Data Sheet

Push in fitting, Different Diameter Union Straight

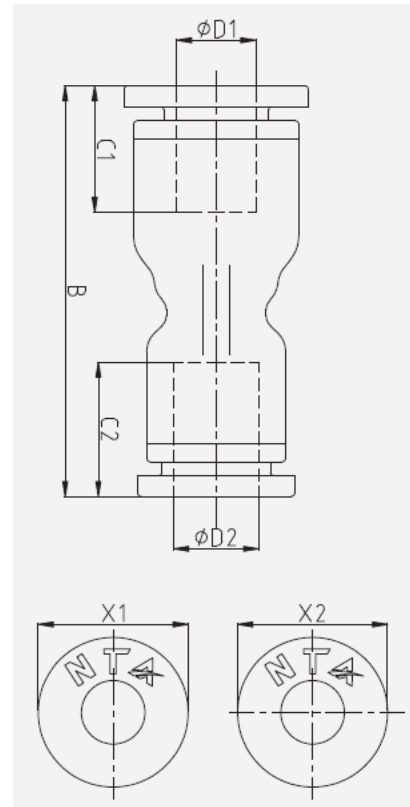

- Pressure range: 0 -10 bar
- Negative pressure: -1 bar (10 Torr)
- Max. pressure: 15 bar
- Temperature range: -10 – 80 °C

Item no.	Model no.	D1	D2	B	C1	C2	X1	X2
2615662	PG6-4	6	4	35.2	16.7	15.3	11.8	9.9
2615663	PG8-6	8	6	39	19.1	16.7	13.8	11.8
2615664	PB10-8	10	8	46.2	21.2	19.1	16.8	13.8