

EAO – Your Expert Partner for Human Machine Interfaces

45-290H.1000.111 - Keylock switch actuator 2 positions

45-290H.1000.111 - Keylock switch actuator 2 positions



Attention: The preview is based on a sample product. This can differ from your current configuration.

Mounting

Mounting cut-out 22.5 mm
Design raised

Front

Front ring material Plastic
Front ring colour black
Front shape round
Front dimension Ø 29.45 mm

Other Attributes

Weight 0.046 kg

Operating-/Indication part

Switching angle C = 90°

IP-Rating

Front protection IP66, IP67, IP69K

Actuator

Key remove A + C
Switching action Rest - Maintained
Housing material Plastic

Switching element

Rotary positions 2
max. number of switching elements 6

Function

Keylock switch

EAO – Your Expert Partner for Human Machine Interfaces

45-290H.1000.111 - Keylock switch actuator 2 positions

Dimensions

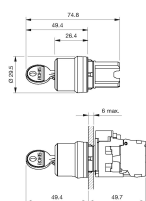

Mounting cut-outs

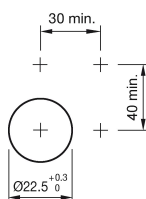

Wiring diagram



Switching positions

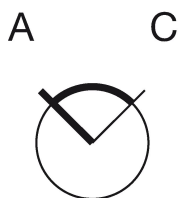

Additional information

The standard lock: RONIS, T254

Legend

Switching action: A = Rest, B = Momentary