

EAO – Your Expert Partner for Human Machine Interfaces

45-2828.1C90.001 - Selector switch actuator 2 positions, short lever

45-2828.1C90.001 - Selector switch actuator 2 positions, short lever



Attention: The preview is based on a sample product. This can differ from your current configuration.

Mounting

Mounting cut-out Design Ø 22.5 mm raised

Front

Front shape round
Front dimension Ø 29.45 mm
Front ring material Plastic
Front ring colour black

Other Attributes

Weight 0.022 kg

Operating-/Indication part

Lever material Plastic
Lever colour white
Switching angle C = 90°

IP-Rating

Front protection IP66, IP67, IP69K

Actuator

Switching action Rest - Maintained
Housing material Plastic

Switching element

Rotary positions 2
max. number of switching elements 6

Function

Selector switch

EAO – Your Expert Partner for Human Machine Interfaces

45-2828.1C90.001 - Selector switch actuator 2 positions, short lever

Dimensions

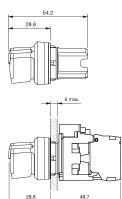

Mounting cut-outs

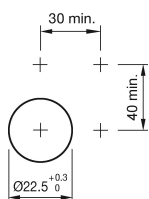

Wiring diagram



Switching positions

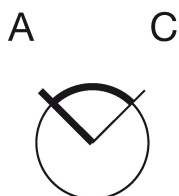

Additional information

External diameter of the short lever 32.3 mm

Legend

Switching action: A = Rest, C = Maintained