

# EAO – Your Expert Partner for Human Machine Interfaces

## 45-2231.11E0.000 - Illuminated pushbutton actuator, Momentary

### 45-2231.11E0.000 - Illuminated pushbutton actuator, Momentary



*Attention: The preview is based on a sample product. This can differ from your current configuration.*

#### Mounting

Design	raised
Mounting cut-out	∅ 22.5 mm

#### Front

Front shape	round
Front dimension	∅ 29.45 mm
Front ring material	Plastic
Front ring colour	black

#### Other Attributes

Weight	0.011 kg
--------	----------

#### Operating-/Indication part

Lens optics	transparent
Lens material	Plastic
Lens colour	red transparent
Lens profile	flat / level with front ring

#### IP-Rating

Front protection	IP66, IP67, IP69K
------------------	-------------------

#### Actuator

Switching action	Momentary
Housing material	Plastic

#### Switching element

max. number of switching elements	6
-----------------------------------	---

#### Function

Illuminated pushbutton
------------------------

# EAO – Your Expert Partner for Human Machine Interfaces

45-2231.11E0.000 - Illuminated pushbutton actuator, Momentary

## Dimensions

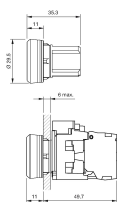

## Mounting cut-outs

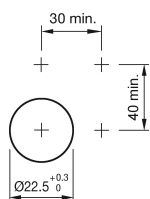

## Legend

Switching action: B = Momentary