

EAO – Your Expert Partner for Human Machine Interfaces

61-2201.0/D - Keylock switch 2 positions round - Actuator

61-2201.0/D - Keylock switch 2 positions round - Actuator



Attention: The preview is based on a sample product. This can differ from your current configuration.

Attribute

Design	flush
Front dimension	Ø 25 mm
Front form	round
IP front protection	IP65
Rotary positions	2
Switching action	Rest (a) - Maintained
Switching angle	90° right
Weight	0.065 kg

Function

Keylock switch

EAO – Your Expert Partner for Human Machine Interfaces

61-2201.0/D - Keylock switch 2 positions round - Actuator

Dimensions

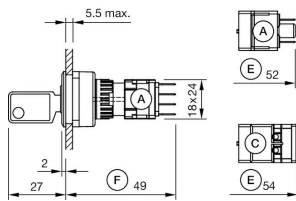

Mounting cut-outs

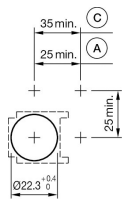

Wiring diagrams

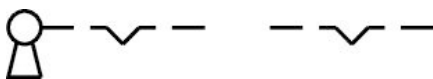

Additional information

a = Key remove
Standard lock: DOM 311