

| BN. | Description |
|---------|-------------|
| 2632367 | 50M |
| 2632368 | 90M |

MATERIAL LIST:

| ⑧ | Cable | CAT7A S/FTP 23AWG 1200MHz BC Solid LSZH Cable Orange RAL 2003 | 1 | |
|-----|---------------|--|-------|--------|
| ⑦ | Snap ring | Plastic | 1 | |
| ⑥ | Brake pads | Plastic | 1 | |
| ⑤ | Handle | rubber | 1 | |
| ④ | Support shaft | Iron | 1 | |
| ③ | Plug | Cat 6A STP Field installable Plug | 1 | |
| ② | FACE PLATE | 86*86mm one-port, Title block with Transparent cover, Dust cap, RAL9010 with CAT6A STP keystone jack | 1 | |
| ① | Plastic reel | φ335mm with face plate, Plastic | 1 | |
| NO. | PARTS NAME | SPECIFICATION STANDARD | QT' Y | REMARK |

FLUKE MPTL LINK TEST:
TEST LIMIT:ISO11801 MPTL Class EA(+PoE)

- Notes:
1. ISO/IEC 11801:2002 Class Fa 1000MHz
 2. ISO/IEC EN 50173 Class Fa 1000MHz
 3. EIA/TIA 568-C 1000MHz
 4. IEC 60603-7-71
 5. RJ45 Contacts durability:750 cycles min
 6. Support PoE, PoE+, PoE++
 7. Storage temperature : -20°C~+60°C
Operation temperature: 0°C~+50°C
Operation humidity:10%~85%
Storage humidity:10%~85%
 8. RoHS 3.0 and REACH Compliant

Renkforce

| NO. | | PARTS NAME | SPECIFICATION STANDARD | QT' Y | REMARK | CUSTOMER | CN | BN. | UNIT | MM | |
|-----|-----|-------------------------------|------------------------|-------|--------|------------|-------|---------|------------|--------|------|
| NEW | | | | | | 2022-08-02 | A | DRAWNBY | CHECKBY | APPOBY | DATE |
| BY | CHK | REVISION RECORD MODIFICATIONS | | | DATE | REV. | Hasia | Arvin | 2022-08-02 | | |

PRODUCT NAME: CAT7A S/FTP with Keystone to Field installable Plug on the mobile Spool

SPECIFICATIONS

TITLE: CAT. 7A S/FTP SOLID CABLE 23AWG (1/0.585 BC*1P+AL-FOIL) × 4PAIR+BRAID (0.12/6/16) AL-MG LSZH
 JACKET OD: 7.7 ± 0.2MM

| | | |
|---------------------|------------|---------|
| FILE AMEND NOTE | DATE | EDITION |
| ORIGINALITY EDITION | 2022-08-02 | A/0 |

VIEW:

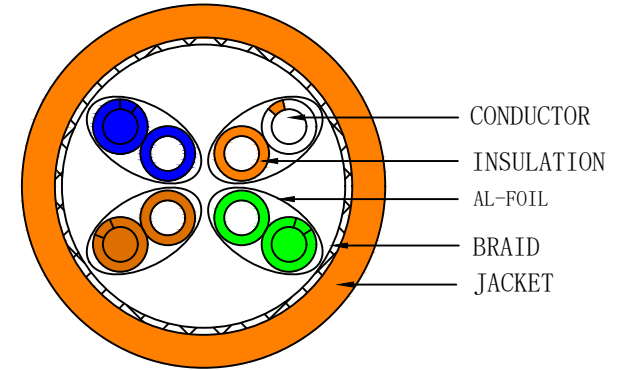

| | | | | | | |
|---------------|---------------------|--------|-----------------------------------|---------------------|-------------------|-------------------|
| ITEMS | | UNIT | A (4P) | | | |
| CONDUCTOR | SIZE | AWG | 23AWG | | | |
| | CONSTRUCTION | PCS/mm | 1/0.585 ± 0.008mm | | | |
| | MATERIAL | / | BC | | | |
| | PICKS | mm | / | | | |
| INSULATION | MATERIAL | / | Foam-PE | | | |
| | DIA. | mm | 1.38 ± 0.05mm | 1.38 ± 0.05mm | 1.38 ± 0.05mm | 1.38 ± 0.05mm |
| | COLOR | / | BLUE/WHITE-BLUE | ORANGE/WHITE-ORANGE | GREEN/WHITE-GREEN | BROWN/WHITE-BROWN |
| | CONCENTRIC | % | ≥90% | ≥90% | ≥90% | ≥90% |
| | NOM. THICKNESS | mm | 0.40 ± 0.05MM | | | |
| TWIST | CONSTRUCTION | / | 1P | 1P | 1P | 1P |
| | AL-FOIL | mm u | YES | | | |
| | MYLAR | mm u | / | | | |
| | CONTORT | % | / | / | / | / |
| | OVERLAPPING | % | >25% | >25% | >25% | >25% |
| | DIA. | mm | / | / | / | / |
| | PICK | mm | / | | | |
| TWIST | CONSTRUCTION | / | 4P | | | |
| | MYLAR OVERLAPPING | mm u % | / | | | |
| | DRAIN WIRE | mm | / | | | |
| | AL-FOIL/OVERLAPPING | mm u % | / | | | |
| | FILLERS | / | / | | | |
| | PE SKELETON | mm | / | | | |
| BRAID/SHIERLD | CONSTRUCTION | / | 0.12/6/16 AL-MG OVERLAPPING ≥ 40% | | | |
| JACKET | MATERIAL/COLOR | / | LSOH/95A Orange RAL 2003 | | | |
| | OUTER DIA. | mm | 7.7 ± 0.2mm | | | |
| | CONCENTRIC | % | ≥80% | | | |
| | NOM. THICKNESS | mm | 0.50 ± 0.1MM | | | |

MARKING: CAT7A S/FTP 1200MHz 4x2x23AWG/1 LSZH ISO11801 & EN50173 & ANSI/TIA568C.2 XXXM (50M OR 90M)

NOTE:

1. Installation temperature 0-50°C
2. Operation temperature -20-75°C
3. Operation humidity: 10%~85%
4. Storage humidity: 10%~85%
5. RoHS 3.0 & REACH compliant
6. 3P Certified
7. CPR Class Eca Certified

Renkforce

| | | | | | |
|---------------|-------|---------------|--------------------------------|-------|--|
| CUSTOMER NAME | CN | NAME | CAT.7A S/FTP Solid CABLE 23AWG | | |
| BN. | | PICTURE SHOWS | TOLERANCE | | |
| | | | X. | ±1.00 | |
| | | | X.X | ±0.50 | |
| APPROVED | AUDIT | DRAWING | UNITS | mm | |
| | ARVIN | Hasia | PAGE | 1/1 | |

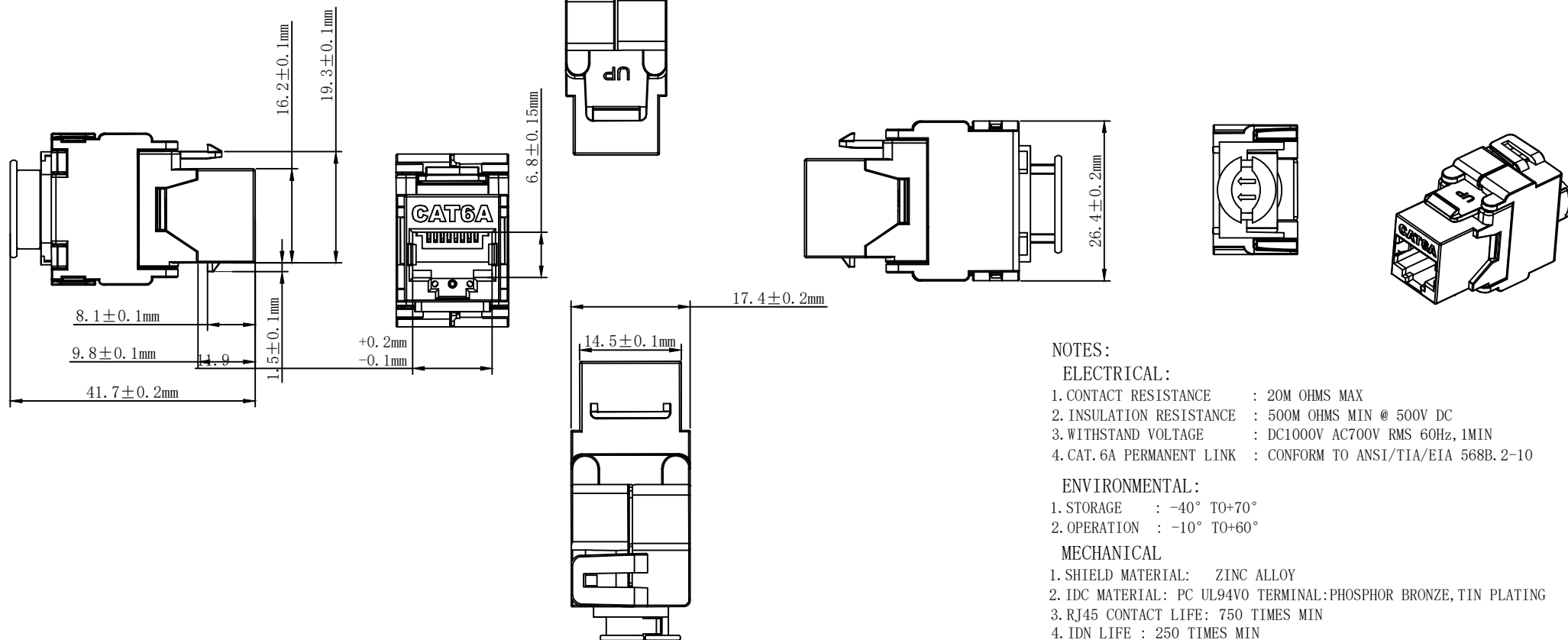

NOTES:

ELECTRICAL:

- CONTACT RESISTANCE : 20M OHMS MAX
- INSULATION RESISTANCE : 500M OHMS MIN @ 500V DC
- WITHSTAND VOLTAGE : DC1000V AC700V RMS 60Hz, 1MIN
- CAT. 6A PERMANENT LINK : CONFORM TO ANSI/TIA/EIA 568B. 2-10

ENVIRONMENTAL:

- STORAGE : -40° TO+70°
- OPERATION : -10° TO+60°

MECHANICAL

- SHIELD MATERIAL: ZINC ALLOY
- IDC MATERIAL: PC UL94V0 TERMINAL:PHOSPHOR BRONZE, TIN PLATING
- RJ45 CONTACT LIFE: 750 TIMES MIN
- IDN LIFE : 250 TIMES MIN
- RJ45 DIMENSION:11.9MM*9.8MM
- WEIGHT: 34.7G

TYPE

- SHIELDED CAT. 6A KEYSTONE JACK
- COLOUR:SILVERY WHITE

RoHS 3.0&REACH COMPLIANT
 Storage temperature : -20°C--+60°C
 Operation temperature: 0°C--+50°C
 Operation humidity:10%~85%
 Storage humidity:10%~85%

MATERIAL LIST:

| ⑦ | MODULAR COVER | FIREPROOF PC UL94V0 | 1 | |
|-----|-------------------|--------------------------|-------|--------|
| ⑥ | RJ 45 JACK INSERT | 8P8C 3U" GOLD PLATED | 8 | |
| ⑤ | PCB | 1.6mm UL 94V0 | 1 | |
| ④ | IDC BODY | FIREPROOF/PC UL 94V0 | 1 | |
| ③ | IDC PIN | PHOSPHOR BRONZE & TINNED | 8 | |
| ② | LABEL COLOR CODE | T568A/B | 2 | |
| ① | IDC TERMINAL | FOR 22-26AWG CABLE | 1 | |
| NO. | PARTS NAME | SPECIFICATION STANDARD | QT' Y | REMARK |

| | | | |
|--------------|---------------------------|-------------------------------|----------------------------------|
| Renkforce | | | |
| CUSTOMER | CN | BN. | |
| PRODUCT NAME | CAT. 6A STP KEYSTONE JACK | | UNIT MM |
| | DRAWNBY | CHECKBY | APPOBY DATE |
| BY | CHK | REVISION RECORD MODIFICATIONS | DATE REV. Hasia Arvin 2022-08-02 |

| | | | | |
|-----|-----|-------------------------------|------------|------|
| NEW | | | 2022-08-02 | A |
| BY | CHK | REVISION RECORD MODIFICATIONS | DATE | REV. |

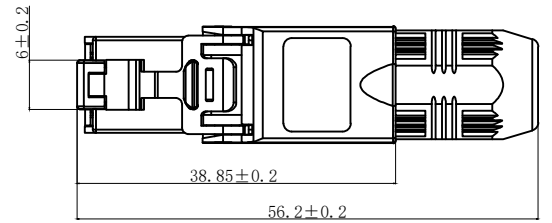
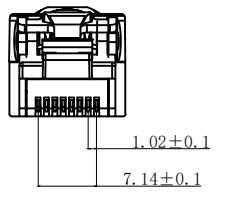
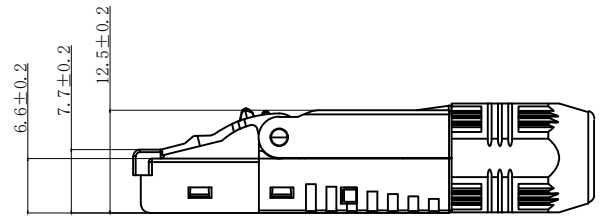
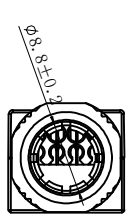
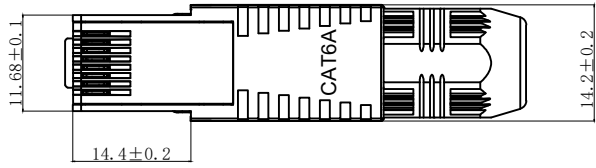
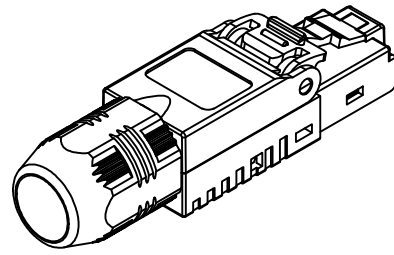

NOTES:

ELECTRICAL:

- 1.Contact Resistance : 20MΩ MAX
- 2.Insulation Resistance : 500MΩ MIN @ 500V DC
- 3.Withstand Voltage : DC 1000V AC 700V RMS 60Hz, 1MIN
- 4.Component testing for ANSI-TIA568.2-D MPTL requirements IEC 60603-7-5
CAT.6A /Class EA MPTL Test pass

ENVIRONMENTAL:

- 1.Storage temperature : -40° TO+70°
- 2.Operation temperature : -10° to+60°

MECHANICAL

- 1.Housing MATERIAL: Zinc alloy
- 2.IDC MATERIAL: PC TERMINAL:PHOSPHOR BRONZE, TIN PLATING
- 3.RJ45 Contact Life: 750 Times Min
- 4.Plug inforce:<30N
- 5.Solid cable:1/22AWG(0.65MM)-1/26AWG(0.4MM) ID:1.1MM-1.6MM
- 6.Stranded cable:7/22AWG(7/0.254mm)-7/27AWG(7/0.14mm) ID:1.1MM-1.6MM
- 7.Cable OD: 5.0mm-8.5mm
- 8.PoE per IEEE 802.3af, PoE+ per IEEE 802.3at, PoE++ per IEEE 802.3bt,
RoHS 3.0 and REACH Compliant
Storage temperature : -20℃~+60℃
Operation temperature: 0℃~+50℃
Operation humidity:10%~85%
Storage humidity:10%~85%

| ⑦ | Sheel | Zinc alloy | 2 | |
|-----|---------------|-----------------------------|-------|--------|
| ⑥ | Housing | Zinc alloy | 1 | |
| ⑤ | MODULAR COVER | PC label color code T568A/B | 1 | |
| ④ | RJ 45 Plug | 8P8C GOLD PLATED | 8 | |
| ③ | PCB | 1.0mm UL 94V0 | 1 | |
| ② | IDC PIN | PHOSPHOR BRONZE & TINNED | 8 | |
| ① | IDC TERMINAL | FOR 22-27AWG CABLE | 8 | |
| NO. | PARTS NAME | SPECIFICATION STANDARD | QT' Y | REMARK |

| Renkforce | | | | | | | | | |
|--------------|--|-------------------------------|------------|------|------|---------|---------|--------|------------|
| CUSTOMER | | CN | | | BN. | | | | |
| PRODUCT NAME | Field Installable RJ 45 shielded with screw type upwards openable L:56.3mm | | | | | | UNIT | MM | |
| NEW | DATE | | 2022-08-02 | REV. | A | DRAWNBY | CHECKBY | APPOBY | DATE |
| BY | CHK | REVISION RECORD MODIFICATIONS | | DATE | REV. | Hasia | Arvin | | 2022-08-02 |

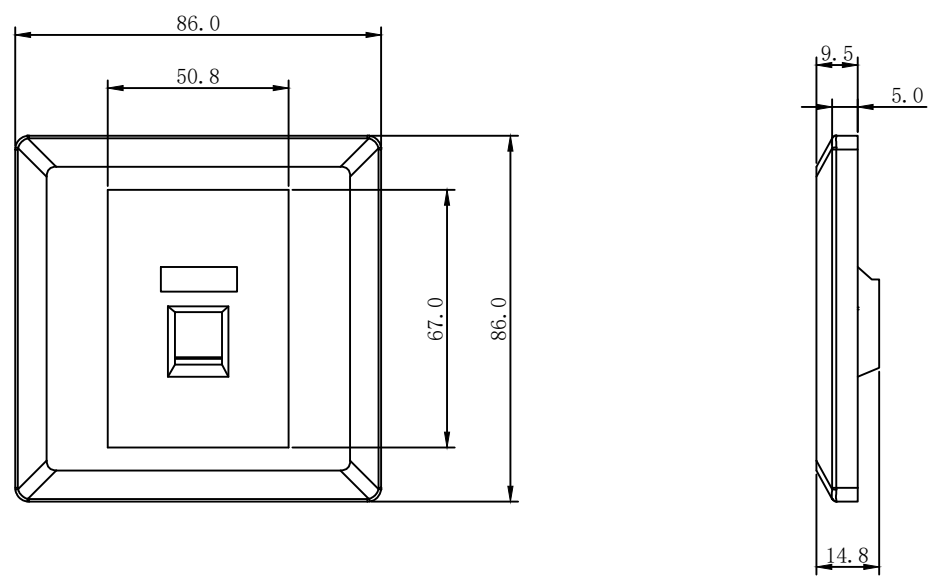

Materials:

Outlet Housing: Fireproof ABS UL-94V0/Colour:RAL 9010

Outlet Base:Firepfoof ABS UL-94V0/Colour:RAL 9010

ACCESSORY :

1. Screw:M3*25mm*2pcs

RoHS 3.0 & REACH Compliant

Storage temperature : -20°C--+60°C

Operation temperature: 0°C--+50°C

Operation humidity:10%~85%

Storage humidity:10%~85%

Renkforce

| | | | |
|----------|----|-----|--|
| CUSTOMER | CN | BN. | |
|----------|----|-----|--|

| | | | |
|--------------|-------------------|------|----|
| PRODUCT NAME | FACE PLATE 1 PORT | UNIT | MM |
|--------------|-------------------|------|----|

| | | | | |
|--|--|-----|------------|---|
| | | NEW | 2022-08-02 | A |
|--|--|-----|------------|---|

| | | | |
|---------|---------|--------|------|
| DRAWNBY | CHECKBY | APPOBY | DATE |
|---------|---------|--------|------|

| | | | | |
|----|-----|-------------------------------|------|------|
| BY | CHK | REVISION RECORD MODIFICATIONS | DATE | REV. |
|----|-----|-------------------------------|------|------|

| | | | |
|-------|-------|--|------------|
| Hasia | Arvin | | 2022-08-02 |
|-------|-------|--|------------|