

PLEASE CHECK WWW.MOLEX.COM FOR LATEST PART INFORMATION

Part Number: **0190330007**
Status: **Active**
Overview: Snap Plugs and Receptacles
Description: Krimptite Snap Plug, for 14-16 AWG Wire

Documents:

[3D Model](#) [Product Specification PS-19902-011-001 \(PDF\)](#)
[3D Model \(PDF\)](#) [Product Specification PS-19902-013-001 \(PDF\)](#)
[Drawing \(PDF\)](#) [RoHS Certificate of Compliance \(PDF\)](#)

Agency Certification

CSA LR18689
 UL E152602

General

Product Family Quick Disconnects
 Series [19033](#)
 Crimp Quality Equipment Yes
 Insulated No
 Overview [Snap Plugs and Receptacles](#)
 Product Name Krimptite
 Taxonomy Quick Disconnects
 Type Snap Plug
 UPC 800755058994

Physical

Barrel Type Closed
 Gender Male
 Glow-Wire Capable No
 Insulation None
 Lock to Mating Part None
 Material - Metal Copper
 Material - Plating Mating Tin
 Material - Plating Termination Tin
 Net Weight 1.179/g
 Orientation Straight
 Packaging Type Bag
 Plating min - Mating 2.540µm
 Plating min - Termination 2.540µm
 Tab Thickness N/A
 Tab Width N/A
 Termination Interface: Style Screw or Lug
 Wire Insulation Diameter N/A
 Wire Size AWG 14, 16
 Wire Size mm² 1.30-2.00

Electrical

Voltage - Maximum N/A

Material Info

Engineering Number B-189

Reference - Drawing Numbers

Product Specification PS-19902-011-001, PS-19902-013-001
 Sales Drawing SD-19033-001-001

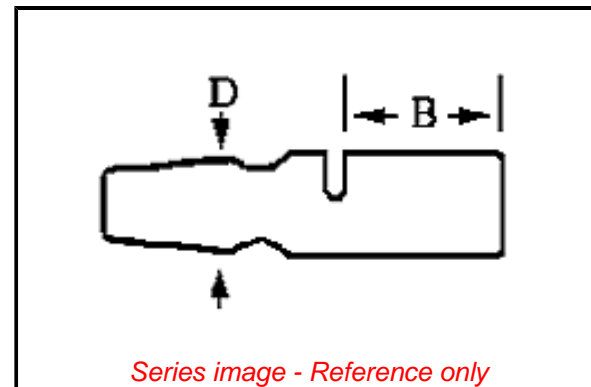

Series image - Reference only

EU ELV

Not Relevant

EU RoHS

Compliant

REACH SVHC

Not Contained Per -
 D(2022)4187-DC (10
 June 2022)

Halogen-Free

Status

Low-Halogen

For more information, please visit [Contact US](#)

China ROHS

ELV

RoHS Phthalates

Green Image

Not Relevant

Not Contained

Search Parts in this Series

[19033 Series](#)

Application Tooling | FAQ

Tooling specifications and manuals are found by selecting the products below. Crimp Height Specifications are then contained in the Application Tooling Specification document.

Global

Description	Product #
PremiumGrade Hand Crimp Tool for Krimptite/Versakrimp Terminals and Splices, 10-22 AWG and 6.0mm ² - 0.5mm ²	640030100
Crimp Head for the AT-200 Pneumatic Hand Tool	640070100
ServiceGrade Hand Crimp Tool - Ratchet	640160038

This document was generated on 02/01/2023

PLEASE CHECK WWW.MOLEX.COM FOR LATEST PART INFORMATION