

SAFETY KNIFE

SECUMAX 350 SE

ORDER NOW!

Order No.	350045.02
Knife size (L x W x H)	152 x 12 x 40 mm
Weight knife	37.0 g
Basic material	Recycled plastic
Variations	350040.02



MAXIMUM SAFETY



Concealed blade
for maximum protection of users and goods

Light ergonomic handle
for comfortable working

Blade change button
incl. access to spare blade head

6 mm cutting depth
for all common cutting materials

SECUMAX BLADE NO. 3448
Blade thickness: 0.50 mm



2-cutting edge blade
for a double period of use

Extra robust blade head
for tougher tasks

Recycled plastic (98%)
as the handle's main material

THE SAFER WAY TO CUT.

martor

MARTOR SAFETY KNIFE SECUMAX 350 SE



SAFETY TECHNOLOGY



SECUMAX
= maximum safety

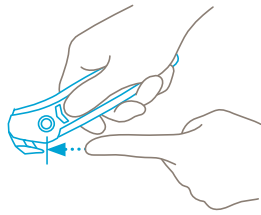

Concealed blade

The SECUMAX 350 SE blade is not an open one, but is hidden from people and goods. This provides you with a maximum degree of safety from cut injuries and from damage to goods.

TECHNICAL FEATURES



Tool-less blade change



Abrasion resistant



Very ergonomic



2-cutting edge blade



1 spare blade in knife body



Cutting depth



For right and left handers



Lanyard hole



Printable for promotional purposes

EXAMPLES OF USE



MAIN CUTTING MATERIALS



Cardboard: up to 2-ply



Wrapping, stretch and shrink foil



Tape



Plastic strapping band



Bagged goods



Layers of foil or paper



Yarn, cord



Felt

MOUNTABLE BLADES



SECUMAX BLADE NO. 3448
0.50 mm, 10 in box

NO. 3448.20



SECUMAX BLADE NO. 3550
0.30 mm, 10 in box

NO. 3550.20

PACKING INFORMATION

Packaging unit 1 in single unit box
(10 knives in multipack)

Size Single unit box 160 x 15.5 x 42 mm

Weight single unit box 50.0 g

EAN Code single unit box 4002632803789

Size outer pack 88 x 80 x 162 mm

Weight outer pack 560.0 g

EAN Code outer pack 4002632853784