

Push-in lug/adaptor for screw mounting for devices with 1 or 2 change-over contacts



product brand name	SIRIUS
product category	Further accessories
product designation	Push-in lugs for screw mounting
design of the product	Can be used for 3UF700, 3UF701, 3UF73, 3UF74, 3UF75, 3RK3
Substance Prohibitation (Date)	05/01/2012

**Safety related data**

protection class IP on the front according to IEC 60529	IP20
---	------

**Certificates/ approvals**

General Product Approval	EMC
--------------------------	-----



[Confirmation](#)



Test Certificates	Marine / Shipping	other
-------------------	-------------------	-------

[Type Test Certificates/Test Report](#)



ABS



LRS



RMRS

[Confirmation](#)

**Further information**

Siemens has decided to exit the Russian market (see here).  
<https://press.siemens.com/global/en/pressrelease/siemens-wind-down-russian-business>  
 Siemens is working on the renewal of the current EAC certificates.  
 Please contact your local Siemens office on the status of validity of the EAC certification if you intend to import or offer to supply these products to an EAC relevant market (other than the sanctioned EAEU member states Russia or Belarus).  
**Information on the packaging**  
<https://support.industry.siemens.com/cs/ww/en/view/109813875>  
**Information- and Downloadcenter (Catalogs, Brochures,...)**  
<https://www.siemens.com/ic10>  
**Industry Mall (Online ordering system)**  
<https://mall.industry.siemens.com/mall/en/en/Catalog/product?mlfb=3RP1903>  
**Cax online generator**  
<http://support.automation.siemens.com/WW/CAXorder/default.aspx?lang=en&mlfb=3RP1903>  
**Service&Support (Manuals, Certificates, Characteristics, FAQs,...)**  
<https://support.industry.siemens.com/cs/ww/en/ps/3RP1903>  
**Image database (product images, 2D dimension drawings, 3D models, device circuit diagrams, EPLAN macros, ...)**  
[http://www.automation.siemens.com/bilddb/cax\\_de.aspx?mlfb=3RP1903&lang=en](http://www.automation.siemens.com/bilddb/cax_de.aspx?mlfb=3RP1903&lang=en)  
**Characteristic: Derating**  
<https://support.industry.siemens.com/cs/ww/en/ps/3RP1903/manual>

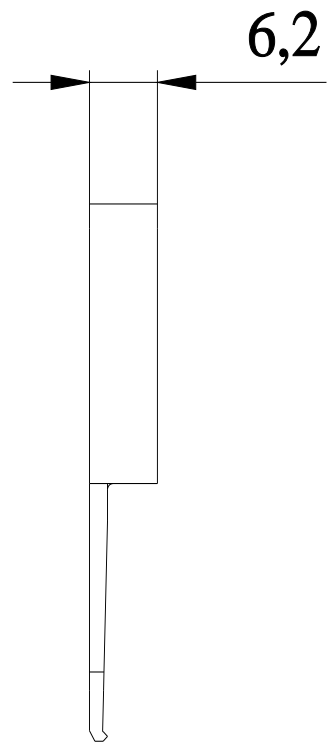
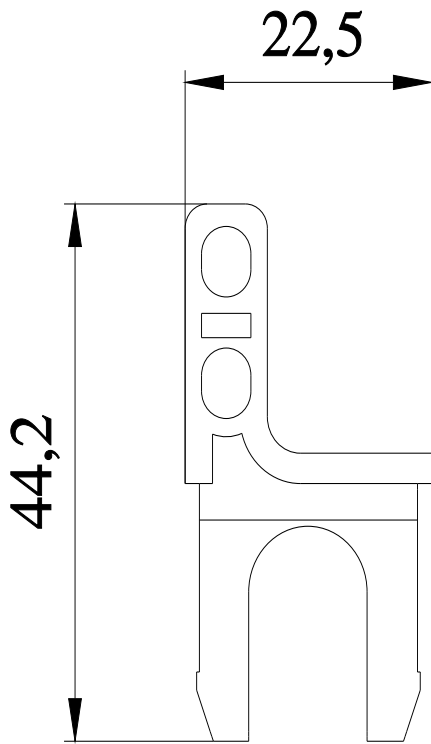

---

last modified:

1/18/2021 