

## LED desk lamp

Item no: 2885393

### 1 Dismantling recommendations

- Disconnect from power supply.
- Ask help from a professional if needed.

### 2 Dismantling instructions

Remove the foot pad x 4.

Use screwdriver to remove 4pcs screws.

Take out the base cover.

Disassembly the light source.

Remove the lamp cap.

Unsolder the LED PCB.

Take out the light source.

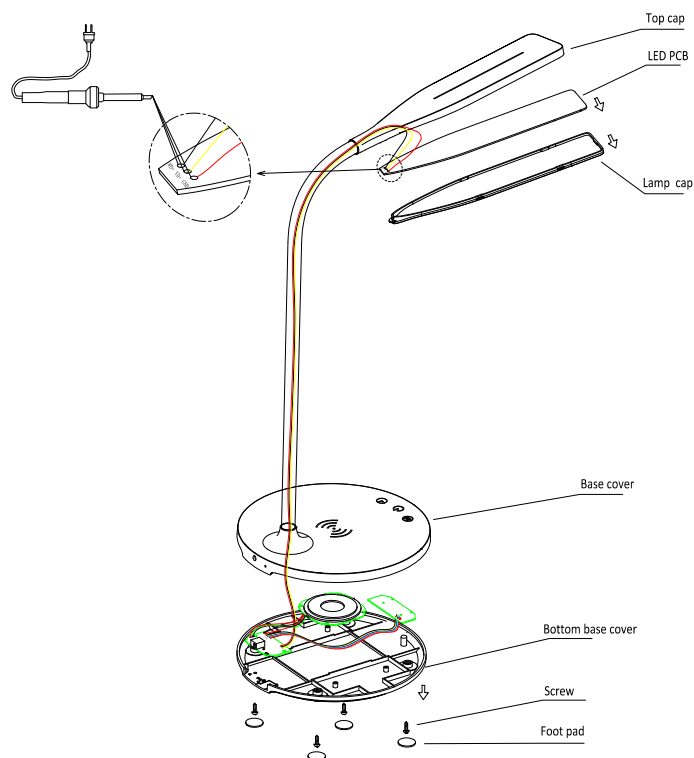

This is a publication by Conrad Electronic SE, Klaus-Conrad-Str. 1, D-92240 Hirschau (www.conrad.com).

All rights including translation reserved. Reproduction by any method (e.g. photocopying, microfilming or the capture in electronic data processing systems) requires prior written approval from the editor. Reprinting, also in part, is prohibited. This publication reflects the technical status at the time of printing.

Copyright by Conrad Electronic SE.

\*2885393\_V1\_0923\_hs\_en 1004683147 I1/O1 en