

## Glass Passivated Bridge Rectifier

### FEATURES

- Ideal for printed circuit board
- High case dielectric strength
- High surge current capability
- UL Recognized File # E-326243
- Compliant to RoHS Directive 2011/65/EU and in accordance to WEEE 2002/96/EC
- Halogen-free according to IEC 61249-2-21

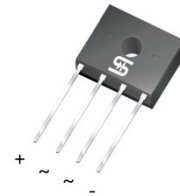
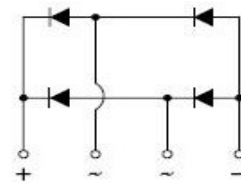
### APPLICATIONS

- Switching mode power supply (SMPS)
- Adapters
- TV
- Monitor

### MECHANICAL DATA

- Case: D3K
- Molding compound meets UL 94V-0 flammability rating
- Packing code with suffix "G" means green compound (halogen-free)
- Terminal : Matte tin plated leads, solderable per J-STD-002
- Meet JESD 201 class 1A whisker test
- Weight: 1.24 g (approximately)
- Mounting Torque: 0.8 N.M max.

KEY PARAMETERS		
PARAMETER	VALUE	UNIT
$V_{RRM}$	600 - 1000	V
$I_{FSM}$	62	A
$T_{J\ MAX}$	150	°C
Package	D3K	
Configuration	Quad	


**D3K**


### ABSOLUTE MAXIMUM RATINGS ( $T_A = 25^\circ\text{C}$ unless otherwise noted)

PARAMETER	SYMBOL	UR2KB60	UR2KB80	UR2KB100	UNIT
Marking code on the device		UR2KB60	UR2KB80	UR2KB100	
Repetitive peak reverse voltage	$V_{RRM}$	600	800	1000	V
Reverse voltage, total rms value	$V_{R(RMS)}$	420	560	700	V
Maximum DC blocking voltage	$V_{DC}$	600	800	1000	
Maximum average forward current 60Hz sine wave resistance load	Without heat sink $T_A=25^\circ\text{C}$	1.2			A
	With heat sink $T_C=143^\circ\text{C}$	2.0			
Surge peak forward current, 8.3 ms single half sine-wave superimposed on rated load	$I_{FSM}$	62			A
$I^2t$ value (of a surge on-state current) <sup>(1)</sup>	$I^2t$	15.9			$\text{A}^2\text{s}$
Junction temperature	$T_J$	-55 to +150			°C
Storage temperature	$T_{STG}$	-55 to +150			°C

#### Note:

1. Pulse test with PW=8.3 ms

<b>THERMAL PERFORMANCE</b>			
<b>PARAMETER</b>	<b>SYMBOL</b>	<b>LIMIT</b>	<b>UNIT</b>
Junction-to-lead thermal resistance	$R_{\theta JL}$	2.8	°C/W
Junction-to-ambient thermal resistance	$R_{\theta JA}$	13.4	°C/W
Junction-to-case thermal resistance	$R_{\theta JC}$	2.3	°C/W

<b>ELECTRICAL SPECIFICATIONS</b> ( $T_A = 25^\circ\text{C}$ unless otherwise noted)					
<b>PARAMETER</b>	<b>CONDITIONS</b>	<b>SYMBOL</b>	<b>TYP</b>	<b>MAX</b>	<b>UNIT</b>
Forward voltage <sup>(1)</sup>	$I_F = 1\text{A}, T_J = 25^\circ\text{C}$	$V_F$	-	1.05	V
Reverse current @ rated $V_R$ <sup>(2)</sup>	$T_J = 25^\circ\text{C}$	$I_R$	-	10	$\mu\text{A}$

**Notes:**

1. Pulse test with  $PW=0.3\text{ ms}$
2. Pulse test with  $PW=30\text{ ms}$

<b>ORDERING INFORMATION</b>				
<b>PART NO.</b>	<b>PACKING CODE</b>	<b>PACKING CODE SUFFIX</b>	<b>PACKAGE</b>	<b>PACKING</b>
UR2KBx0 (Note 1,2)	C2	G	D3K	1,500 / BOX

**Notes:**

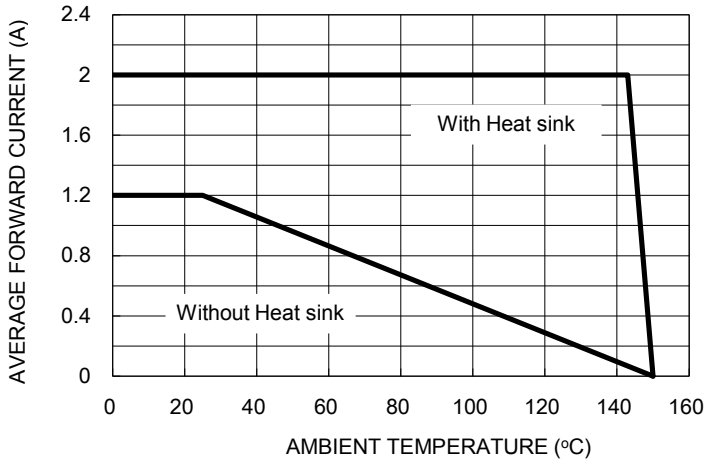
1. "x" defines voltage from 600V (UR2KB60) to 1000V (UR2KB100)
2. Whole series with green compound

<b>EXAMPLE</b>				
<b>EXAMPLE P/N</b>	<b>PART NO.</b>	<b>PACKING CODE</b>	<b>PACKING CODE SUFFIX</b>	<b>DESCRIPTION</b>
UR2KB60 C2G	UR2KB60	C2	G	Green compound

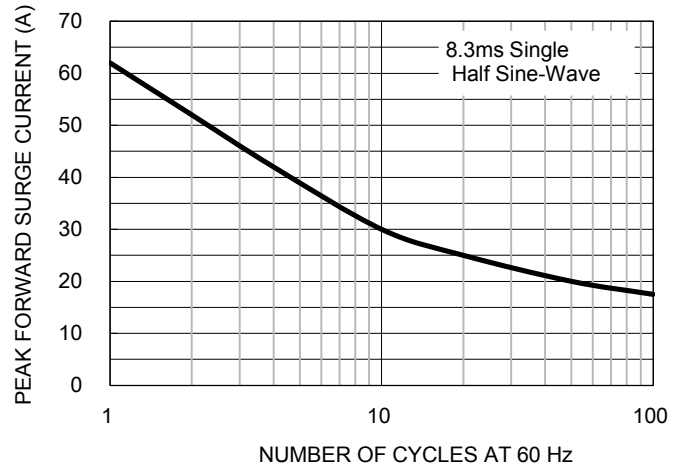
**RATINGS AND CHARACTERISTICS CURVES**

( $T_A = 25^\circ\text{C}$  unless otherwise noted)

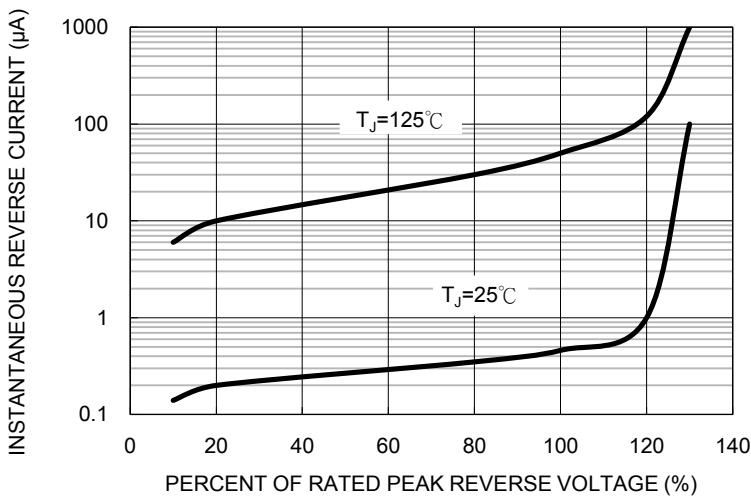
**Fig1. Maximum Derating Curve For Output current**



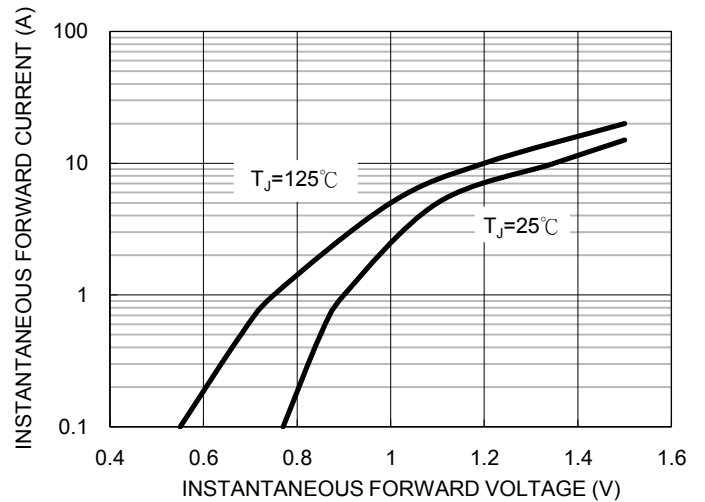
**Fig2. Maximum Forward Surge Current**



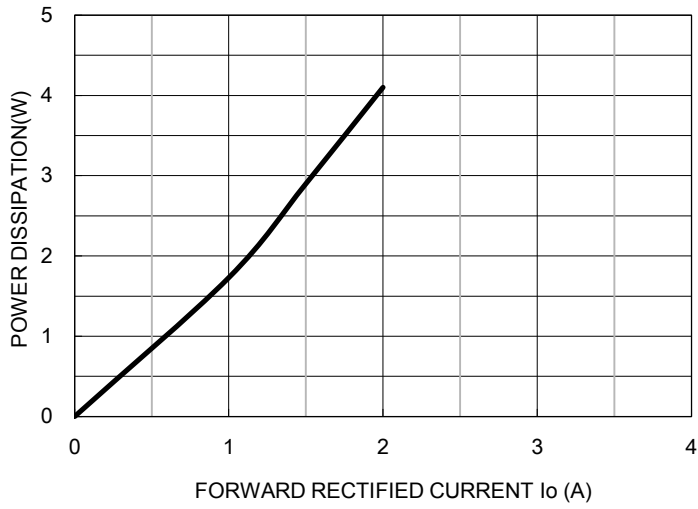
**Fig3. Typical Reverse Characteristics**



**Fig4. Typical Forward Characteristics**

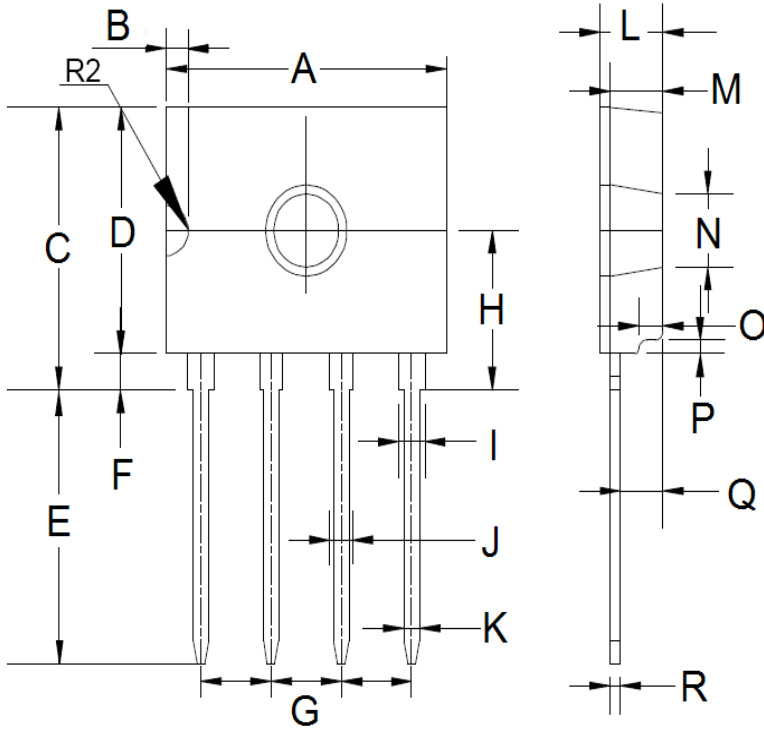


**Fig5. Forward Power Dissipation**



**PACKAGE OUTLINE DIMENSIONS**

D3K



DIM.	Unit (mm)		Unit (inch)	
	Min	Max	Min	Max
A	13.50	14.10	0.531	0.555
B	0.70	1.40	0.028	0.055
C	11.70	12.30	0.461	0.484
D	10.50	11.10	0.413	0.437
E	11.70	12.30	0.461	0.484
F	1.10	1.40	0.043	0.055
G	3.51	4.11	0.138	0.162
H	6.70	7.30	0.264	0.287
I	1.10	1.50	0.043	0.059
J	1.05	1.25	0.041	0.049
K	0.66	0.86	0.026	0.034
L	2.90	3.30	0.114	0.130
M	2.40	2.80	0.094	0.110
N	3.10	3.40	0.122	0.134
O	1.00	1.40	0.039	0.055
P	0.40	0.80	0.016	0.031
Q	1.80	2.40	0.071	0.094
R	0.40	0.60	0.016	0.024

**MARKING DIAGRAM**



- P/N = Marking Code
- G = Green Compound
- YWW = Date Code
- F = Factory Code

## Notice

Specifications of the products displayed herein are subject to change without notice. TSC or anyone on its behalf, assumes no responsibility or liability for any errors or inaccuracies.

Information contained herein is intended to provide a product description only. No license, express or implied, to any intellectual property rights is granted by this document. Except as provided in TSC's terms and conditions of sale for such products, TSC assumes no liability whatsoever, and disclaims any express or implied warranty, relating to sale and/or use of TSC products including liability or warranties relating to fitness for a particular purpose, merchantability, or infringement of any patent, copyright, or other intellectual property right.

The products shown herein are not designed for use in medical, life-saving, or life-sustaining applications. Customers using or selling these products for use in such applications do so at their own risk and agree to fully indemnify TSC for any damages resulting from such improper use or sale.