

# PARTNER C2



**1100**  
MAX LUMENS

**240**  
METERS THROW

**28**  
HOURS RUNTIME

WHITE, WARM  
LIGHT



**RECHARGEABLE**  
Magnetic USB charger  
and battery included

**DIMENSIONS**

Length 123.5 mm  
Head diameter 25.4 mm  
Weight with battery 118 g

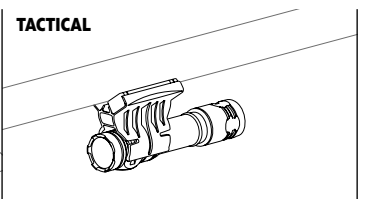
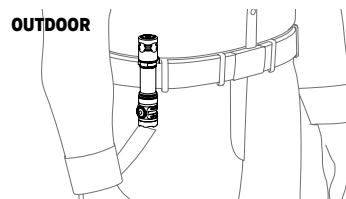
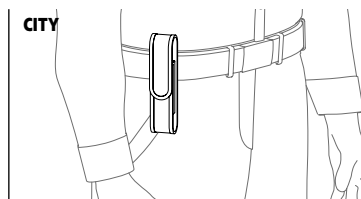
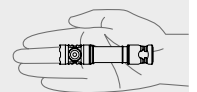

## Every Day Carry light with the possibility of tactical use

Every Day Carry light and a compact tactical flashlight. Partner C2 is the basic model of the series, developed both for everyday use and for special tasks. A universal assistant at home, on a hike or on a fishing trip, Partner C2 can replace a larger tactical model when hunting or security patrolling. The body of the classic form factor is equipped with two operation buttons: flat tactical button allows quickly turning the flashlight on and off in a tactical hold, and large side button switches the modes. Like the models of Armytek tactical lineup, Partner C2 has the possibility of constant and momentary on (by half-pressing

of the tactical button until it is released). The set configuration of the flashlight includes a nylon holster, a steel clip and a paracord lanyard, which ensures convenient fixation of the flashlight to a belt, clothing or equipment. The flashlight is compatible with optional accessories: with weapon mounts and color filters for tactical use, as well as with ABM-01 bicycle mount for cycling.

Partner C2 is a ready high-tech solution from Armytek. The flashlight is supplied with a fast magnetic charger and a 18650 Li-Ion battery 3200 mAh.

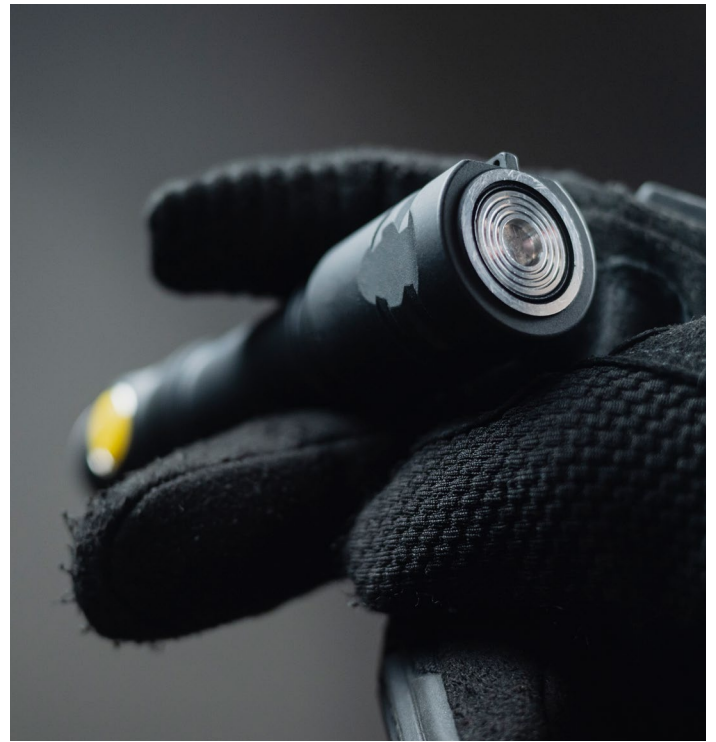

### 1 EVERY DAY CARRY LIGHT

Compact design, convenient side button, special matt anti-abrasive finish without rough knurling. Durable nylon holster, robust removable steel clip and paracord lanyard.

### 2 TACTICAL FLASHLIGHT

Flat button in the tailcap for using the flashlight in a tactical hold. Long-throw narrow beam of light. Withstands recoil, compatible with original weapon mounts and color filters.

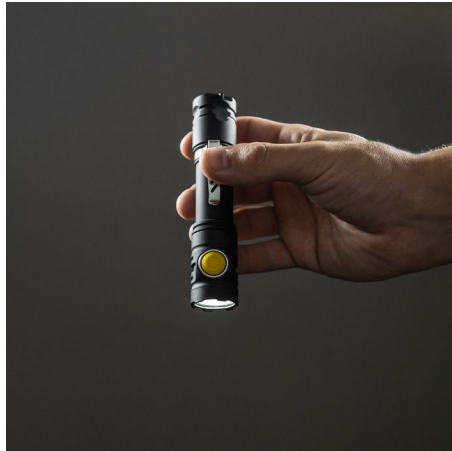

- Special precisely calculated reflector in a compact head for High Intensity LED modification, which provides 1.5 times the light range compared to a usual LED, and tempered glass with anti-reflective coating for maximum throw distance. Hotspot diameter is 12 meters at 100 meters distance
- Two buttons: tail tactical button for switching the flashlight on/off and side button for one-hand mode changing
- Two-phase electronic tail button is noiseless and 20 times more durable compared to mechanical one

- Flat tail button prevents accidental activation of the flashlight and provides the possibility of tail-stand
- Innovative technology allows using any standard 18650 Li-Ion battery. Full protection against short circuit even in case of contact between magnetic connector and metal objects
- Multicolor temperature and battery level indication with the ability to turn it off
- Two springs for better battery and driver protection

- Active real-time temperature control to prevent overheating above +58 °C and warning indication of low battery level
- Total protection from water, dirt and dust in accordance with IP68 standard – flashlight continues to work even after submersion at 5 meters depth. Withstands fallings from up to 10 meters
- 18650 Li-Ion battery in the set, also compatible with 2xCR123A batteries (not included)



# ADVANTAGES OF PARTNER C2



**MAGNETIC USB CHARGER**  
Robust and water resistant magnetic connector

**Large side button:** separate button for switching between the modes, soft and comfortable pressing

**Flat tactical button:** turns the flashlight on and off during tactical hold, with unique integrated magnetic charging port

**Simple operation:** 5 modes, convenient switching with a separate button

**Active real-time temperature control:** ensures safe and comfortable use. When the temperature becomes close to +58 °C, the brightness decreases, which allows avoiding flashlight and battery overheating, as well as LED degradation. Compliant with European safety standards

**Ready-to-use solution:** 18650 Li-ion 3200 mAh battery and fast magnetic USB charger included

**Compatibility with batteries of various types and sizes:** the flashlight works on one standard 18650 Li-Ion battery or two CR123A lithium batteries

**Intelligent charging algorithm:** safe current to extend battery life. The included 18650 Li-Ion 3200 mAh battery is charged in

 **3 h 20 min**



# WELL-THOUGHT-OUT SET OF ACCESSORIES

Nylon holster with several fixing options: on a belt of any width, on a MOLLE mount, on equipment thanks to durable ring.

Removable stainless steel clip provides reliable mounting on clothes, equipment or belt.

Size-adjustable wrist lanyard made of heavy-duty paracord and steel carabiner for quick removal and installation on the flashlight.

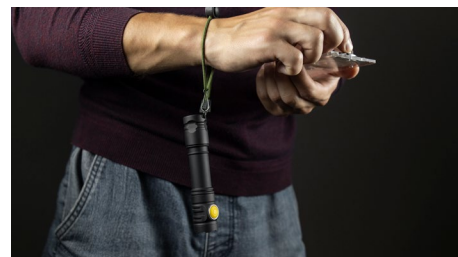

- 1 - flashlight
- 2 - 18650 Li-Ion battery 3200 mAh
- 3 - fast magnetic USB charger
- 4 - steel clip
- 5 - size-adjustable paracord wrist lanyard
- 6 - nylon holster
- 7 - two spare O-rings
- 8 - user manual in eight languages

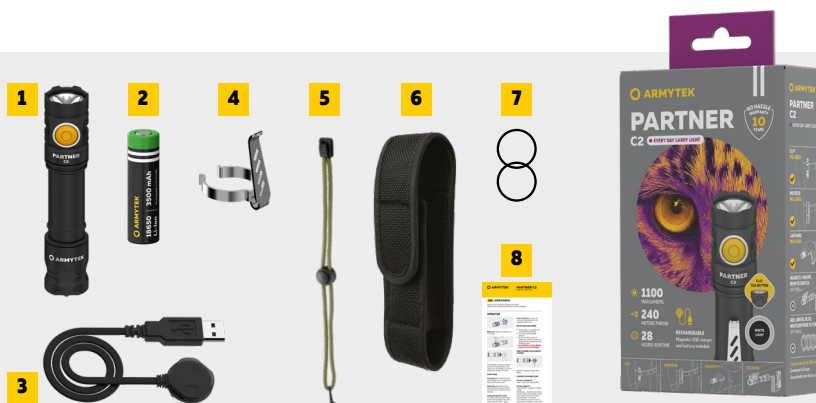

## SPECIFICATIONS

		Partner C2
<b>Optics</b>		Smooth reflector
<b>Light output</b>		1100 lm
<b>Beam distance</b>		240 m
<b>Hotspot : Spill</b>		7°:68°
<b>Brightness stabilization type</b>		Digital
<b>Number of modes</b>		5
<b>Modes / Runtimes</b>	<b>Turbo</b>	1100 lm / 2 h 10 min (500 lm after 2 min)
	<b>Main3</b>	350 lm / 3 h 30 min
	<b>Main2</b>	150 lm / 9 h 25 min
	<b>Main1</b>	50 lm / 28 h
	<b>Strobe</b>	1100 lm / 15 Hz / 3 h 45 min (500 lm after 20 min)
<b>Power source</b>		1x18650 Li-Ion, 2xCR123A
<b>Length / head diameter / body diameter</b>		123.5 mm / 25.4 mm / 21 mm
<b>Weight without / with battery</b>		68 g / 118 g
<b>Ingress protection, Submersion and Impact resistance</b>		IP68. Depth up to 5 m for 5 h. Height up to 10 m

► The model is available with White and Warm light. Light output for flashlights with Warm light is about 7% less, beam distance is about 3% less. All the above specifications are test results based on ANSI/PLATO FL 1-2019 Standard. The data may vary due to environment, heat dissipation and other factors.

# BENEFITS OF WORKING WITH ARMYTEK

Armytek is a world famous manufacturer of high-tech flashlights, chargers and accessories. All Armytek products perfectly meet the buyer's requirements. We focus on quality and reliability: smart lineup allows us to thoroughly think through every detail before launching mass production.

## **HIGH PROFIT**

Favorable conditions and flexible prices for bulk orders are ensured by own factories in China.

## **FAST SHIPPING**

Warehouses around the world: the goods are always in stock and ready for shipment. Reduced costs and time of delivery, no additional customs fees required. Lower costs on shippings directly from the factories.

## **EXCEPTIONAL RELIABILITY**

Minimum returns rate – less than 1% (competitors' rate is 5-7%). All products go through quality checking on test stands.

## **LEGENDARY SERVICE**

Full support and cooperation: from placing an order to warranty service. Professional issue management, fast repairs and exchange.

## **NO HASSLE WARRANTY**

Up to 10 years unprecedented warranty.

## **OWN FACTORIES**

Every step of the process is controlled by our European specialists at the factories.

## **DEVELOPMENT**

Head office in Europe. Team of highly qualified specialists from defence, aviation, space and other specialized industries.

## **EXPERIENCE**

Expert in the fields of mechanics, optics and electronics. We specialize in development and manufacturing of flashlights and battery chargers since 2009.

## **COMPONENTS**

Powerful Cree, Nichia and Samsung LEDs, electronics by the USA and Japan, aircraft-grade aluminium, tempered glass, etc.

## **SMART LINEUP**

Simple process of choosing a product, no bulky catalogs with a lot of similar variants. Only best models for client's needs.

## **NEW PRODUCTS**

Armytek produces innovative and the most technically advanced products in the world.

## **PRIVATE LABEL, OEM/ODM**

Creating new products, modifying our production models and personalizing them according to your needs.

## **MARKETING SUPPORT**

We provide all the necessary promotional materials: leaflets, booklets, catalogs, etc.

## **CLIENTS' NEEDS RESEARCH**

We systematically gather feedback to make sure that our products completely fit clients' needs and requirements.

**Built to exceed**