

Datasheet

Manufacturer Part No.: T24C035

Ferrule assortment 1200 pcs (DIN color code)



These ferrules are especially suitable for hobbyists, craftsmen, field service, service workshops, electronics technicians and laboratory needs.

The assortment contains a 1200-pcs. ferrule set (DIN color code) for an application range of cable cross sections from 0.5 to 10 mm². Optimal for use with suitable wire end ferrule crimping pliers.

Technical Specifications

Voltage (max.): 440 V, Material: polyamide, copper, tin plated. The ferrules comply with RoHS directives and CE.

Content

Assortment box • 25 ferrules yellow 6 mm² (10 AWG) • 25 ferrules red 10 mm² (7 AWG) • 50 ferrules grey 4 mm² (12 AWG) • 250 ferrules blue 2,5 mm² (14 AWG) • 250 ferrules black 1.5 mm² (16 AWG) • 200 ferrules gray 0.75 mm² (20 AWG) • 200 ferrules red 1 mm² (18 AWG) • 200 ferrules white 0.5 mm² (22 AWG).

Connection only by qualified electricians!

Datasheet

Manufacturer Part No.: T24C035



1020pcs Non-Insulated Cable Ferrules - assortment Set



Non-Insulated cable ferrules

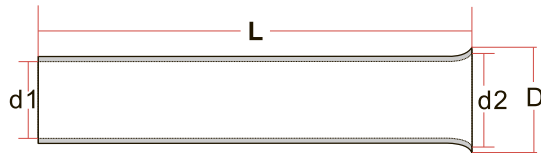

Material: Tinned Copper (EN13600)
 Operating Voltage: 600V max.
 Operating Temperature: 120°C max.

| Wire range | L | D | d1 | d2 | Contents |
|----------------------|-------|----------|----------|----------|----------|
| 0,75 mm ² | 8 mm | ø 2,3 mm | ø 1,2 mm | ø 1,5 mm | 250 pcs |
| 1,0 mm ² | 8 mm | ø 2,5 mm | ø 1,4 mm | ø 1,7 mm | 250 pcs |
| 1,5 mm ² | 8 mm | ø 2,8 mm | ø 1,7 mm | ø 2,0 mm | 200 pcs |
| 2,5 mm ² | 8 mm | ø 3,4 mm | ø 2,2 mm | ø 2,5 mm | 200 pcs |
| 4,0 mm ² | 10 mm | ø 4,0 mm | ø 2,8 mm | ø 3,2 mm | 50 pcs |
| 6,0 mm ² | 12 mm | ø 4,7 mm | ø 3,5 mm | ø 3,9 mm | 40 pcs |
| 10 mm ² | 12 mm | ø 5,8 mm | ø 4,5 mm | ø 4,9 mm | 20 pcs |
| 16 mm ² | 12 mm | ø 7,5 mm | ø 5,8 mm | ø 6,2 mm | 10 pcs |

Datasheet

Manufacturer Part No.: T24C035



300pcs Twin cable Ferrules - assortment Set

Item no.: T1903C035



Twin Cable ferrules

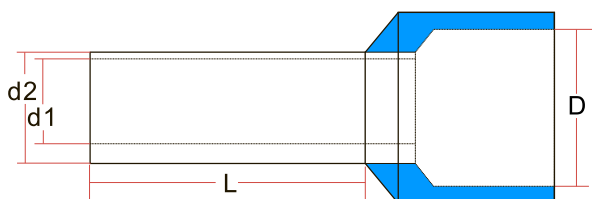

Insulation material: PVC
 Terminal material: Tinned Copper
 Operating Voltage: 300V max.
 Operating Temperature: 105°C max.

| Wire range | L | D | d1 | d2 | Contents |
|--------------------------|-------|-----------|----------|----------|----------|
| 2 x 0,75 mm ² | 8 mm | ø 5,5 mm | ø 1,8 mm | ø 2,1 mm | 70 pcs |
| 2 x 1,0 mm ² | 8 mm | ø 5,5 mm | ø 2,0 mm | ø 2,3 mm | 70 pcs |
| 2 x 1,5 mm ² | 8 mm | ø 6,4 mm | ø 2,3 mm | ø 2,6 mm | 50 pcs |
| 2 x 2,5 mm ² | 10 mm | ø 8,0 mm | ø 2,9 mm | ø 3,3 mm | 50 pcs |
| 2 x 4,0 mm ² | 12 mm | ø 8,8 mm | ø 3,8 mm | ø 4,2 mm | 20 pcs |
| 2 x 6,0 mm ² | 14 mm | ø 9,5 mm | ø 4,9 mm | ø 5,3 mm | 20 pcs |
| 2 x 10 mm ² | 14 mm | ø 12,6 mm | ø 6,5 mm | ø 6,9 mm | 10 pcs |
| 2 x 16 mm ² | 14 mm | ø 19,0 mm | ø 8,3 mm | ø 8,7 mm | 10 pcs |