

## Lampe à pétrole Vintage à LEDs

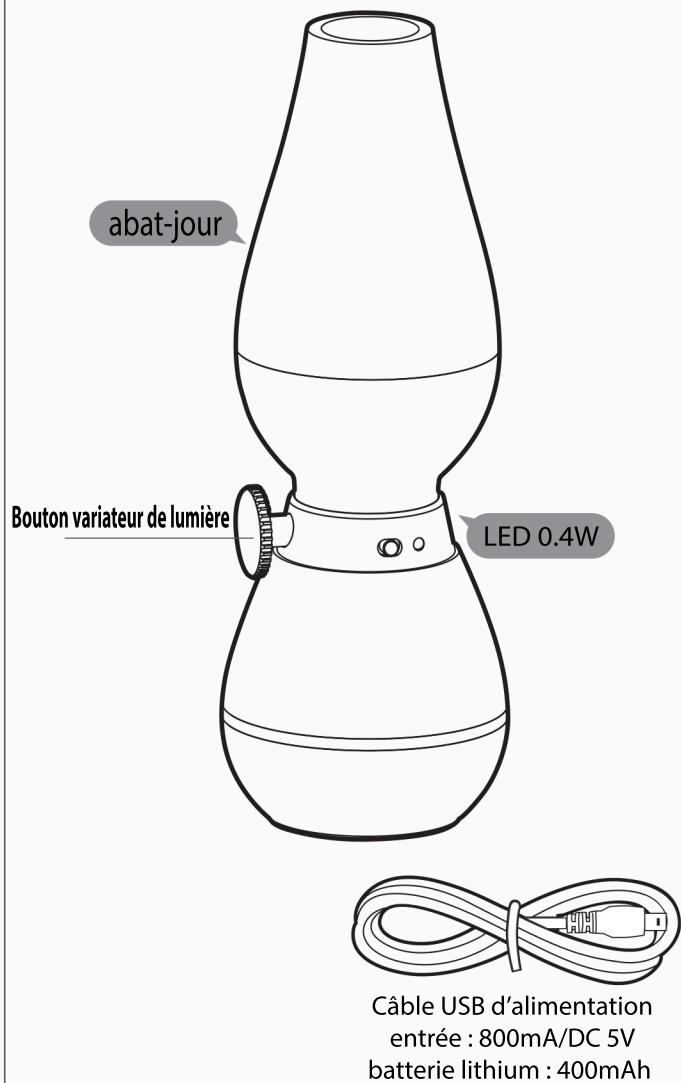

## Méthode de charge (câble USB)

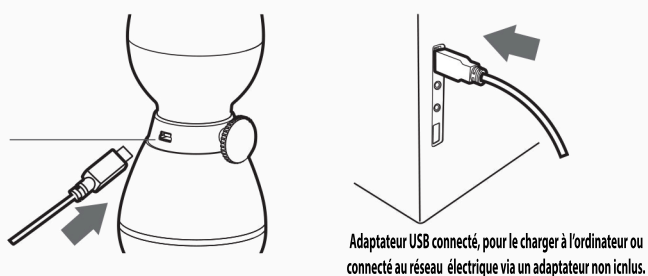

La première fois que vous mettez en charge ce produit, veuillez le charger plus de quatre heures, pour garantir un bon fonctionnement de la batterie rechargeable intégrée. Une charge normale dure deux heures.

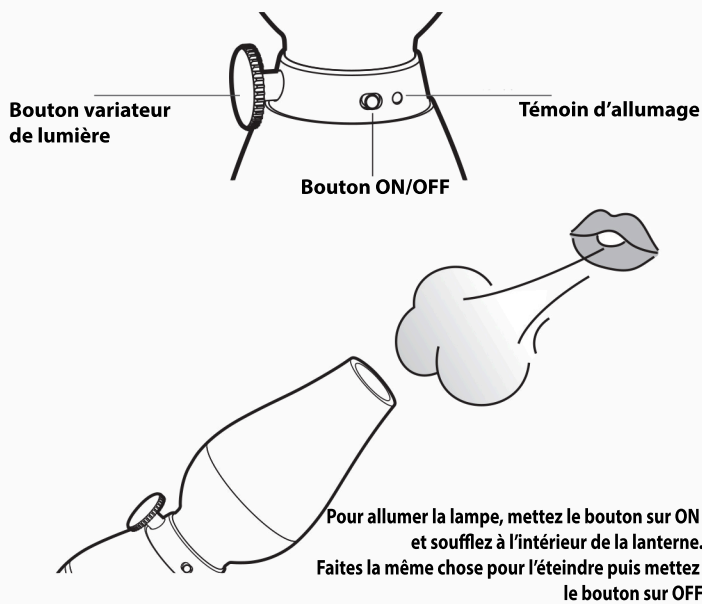

LED Vintage Kerosene Lamp Specification

## Names of the parts

Led Lamp

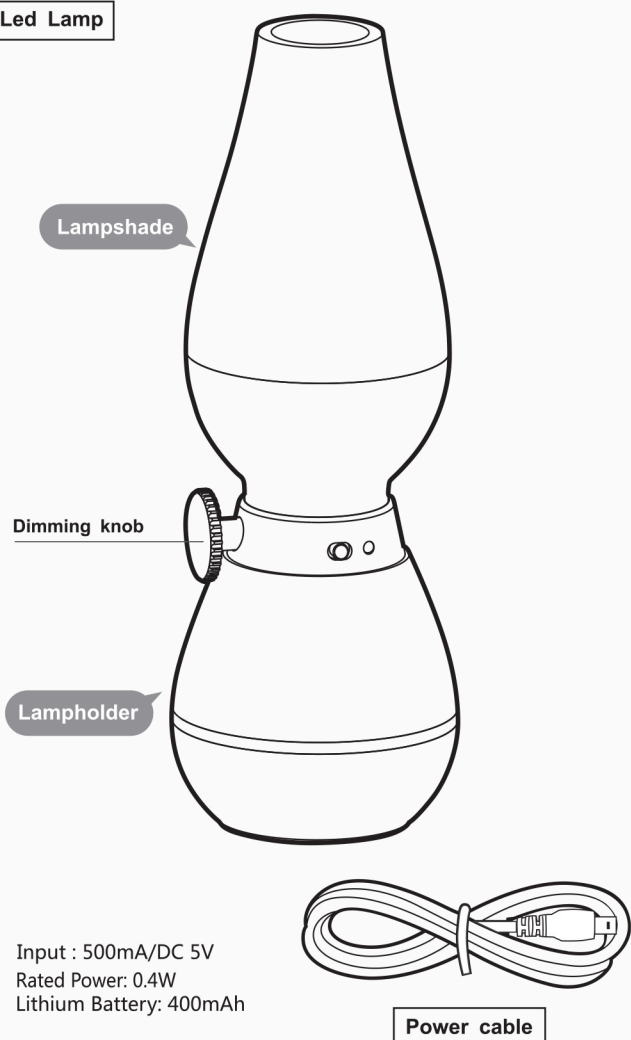

LED Vintage Kerosene Lamp Specification

## Charge method

- The first time you use this product, please charge more than four hours, in order to ensure proper functioning of the built-in rechargeable battery. Normal charging for two hours.

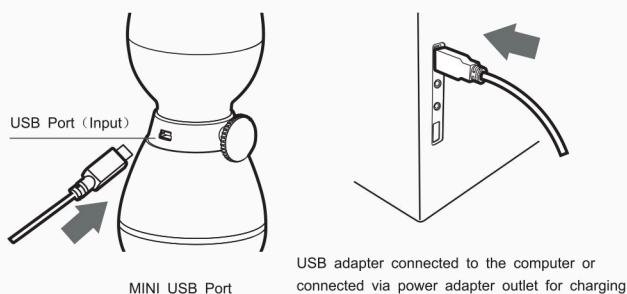

## Turn on and turn off the lights

- The switch to the "ON" position, the product features open
- Such as long-term no using, push the switch to the "OFF" position

