

MOTOR FEATURES

| REFERENCE NUMBER REFERENCIA REFERENZNUMMERN | NOMINAL VOLTAGE TENSION NOMINALE NENNSPANNUNG | NOMINAL TORQUE PAR NOMINAL DREHMOMENT NOMINAL | NOMINAL SPEED VELOCIDAD NOMINAL GESCHWINDIGKEIT NOMINAL | NOMINAL CURRENT CORRIENTE NOMINAL COURANT NOMINAL NOMINALSTROM | STARTING TORQUE PAR DE ARRANQUE COUPLE DE DEMARRAGE ANZUGSDREHMOMENT | STARTING CURRENT CORRIENTE DE ARRANQUE COUPLET DE DEMARRAGE ANZUGSTROM | SHAFT EJE ARBRE WELLE | CONNECTIONS CONEXIONES CONNECTIONS ANSCHLUSSART | WIRING DIAGRAM ESQUEMA ELECTRICO SCHEMA ELECTRIQUE SCHALTPLAN | TRANSMISSION RATIO RELACION DE REDUCCION RAPPORT DE REDUCTEUR UNTERSATZUNG | APPROXIMATE WEIGHT PESO APROXIMADO POIDS APPROXIMATIF GEWICHT (ca.) | WATER TIGHTNESS GRADO DE ESTANQUEIDAD ETANCHÉITÉ FEUCHTIGKEITSSCHUTZKLASSE | WHEEL MATERIAL MATERIAL RUEDA MATERIAU ROUE MATERIAL DES SCHNELLERENDES | DESIGN: A, B, C DISEÑO: A, B, C DRESSIN: A, B, C ABBILDUNG: A, B, C | CURVE CURVA COURBE KURVE |
|---|---|---|---|---|---|---|--------------------------------|--|--|---|--|---|--|--|-----------------------------------|
| | Un (V) | Mn (N.m./lbf.in) | Pn (r.p.m.) | In (A) | Ma (N.m./lbf.in) | Ia (A) | | | | i | P (kg/lb) | IP | | | |
| 11137112000 | 12 | 5 / 44.2 | 40 | 5 | 25 / 221.2 | 25 | E22 | C25 | EE2 | 62:1 | 1.25 / 2.76 | IP53 | PLA | A | 1 |
| 11137113000 | 24 | 5 / 44.2 | 40 | 2.5 | 25 / 221.2 | 13 | E22 | C25 | EE2 | 62:1 | 1.25 / 2.76 | IP53 | PLA | A | 1 |
| 11137612000 | 12 | 5 / 44.2 | 40 | 5 | 25 / 221.2 | 25 | E23 | C25 | EE2 | 62:1 | 1.25 / 2.76 | IP53 | PLA | A | 1 |
| 11137613000 | 24 | 5 / 44.2 | 40 | 2.5 | 25 / 221.2 | 13 | E23 | C25 | EE2 | 62:1 | 1.25 / 2.76 | IP53 | PLA | A | 1 |
| 11137612000E | 12 | 5 / 44.2 | 40 | 5 | 25 / 221.2 | 25 | E23 | C25 | F2 | 62:1 | 1.25 / 2.76 | IP53 | PLA | A | 1 |
| 11137613000E | 24 | 5 / 44.2 | 40 | 2.5 | 25 / 221.2 | 13 | E23 | C25 | F2 | 62:1 | 1.25 / 2.76 | IP53 | PLA | A | 1 |
| 11137632000 | 12 | 6 / 53.1 | 25 | 4 | 25 / 221.2 | 15 | E23 | C25 | EE2 | 62:1 | 1.25 / 2.76 | IP53 | PLA | A | 3 |
| 11137633000 | 24 | 6 / 53.1 | 25 | 2 | 25 / 221.2 | 8 | E23 | C25 | EE2 | 62:1 | 1.25 / 2.76 | IP53 | PLA | A | 3 |
| 11147613000 | 24 | 5 / 44.2 | 40 | 2.5 | 25 / 221.2 | 13 | E23 | C25 | EE2 | 62:1 | 1.25 / 2.76 | IP53 | PLA | B | 1 |
| 11190312000 | 12 | 3 / 26.5 | 70 | 6 | 25 / 221.2 | 34 | E23 | C25 | EE2 | 62:1 | 1.25 / 2.76 | IP53 | PLA | A | 2 |
| 11190313000 | 24 | 3 / 26.5 | 70 | 3 | 25 / 221.2 | 17 | E23 | C25 | EE2 | 62:1 | 1.25 / 2.76 | IP53 | PLA | A | 2 |
| 11190392000 | 12 | 1.5 / 13.2 | 240 | 8 | 10 / 88.5 | 46 | E23 | C26 | EE1 | 49:4 | 1.25 / 2.76 | IP53 | PLA | A | 4 |
| 11190393000 | 24 | 1.5 / 13.2 | 240 | 4 | 10 / 88.5 | 23 | E23 | C26 | EE1 | 49:4 | 1.25 / 2.76 | IP53 | PLA | A | 4 |
| 11190413000 | 24 | 5 / 44.2 | 40 | 2.5 | 25 / 221.2 | 13 | E24 | C25 | EE2 | 62:1 | 1.30 / 2.87 | IP53 | BRO | A | 1 |
| 11190942000 | 12 | 5 / 44.2 | 40 | 5 | 25 / 221.2 | 25 | E52 | C2 | EE2 | 62:1 | 1.25 / 2.76 | IP53 | PLA | A | 1 |
| 11191073000 | 24 | 1.5 / 13.2 | 240 | 4 | 14 / 123.9 | 23 | E24/E53 | C26 | EE1 | 49:4 | 1.25 / 2.76 | IP40 | CEL | C | 4 |
| 11191992000 | 12 | 3 / 26.5 | 100 | 6 | 20 / 177.01 | 48 | E67 | C26 | F3 | 59:2 | 1.25 / 2.76 | IP53 | PLA | A | 59 |
| 11191993000 | 24 | 3 / 26.5 | 100 | 3 | 20 / 177.01 | 24 | E67 | C26 | F3 | 59:2 | 1.25 / 2.76 | IP53 | PLA | A | 59 |

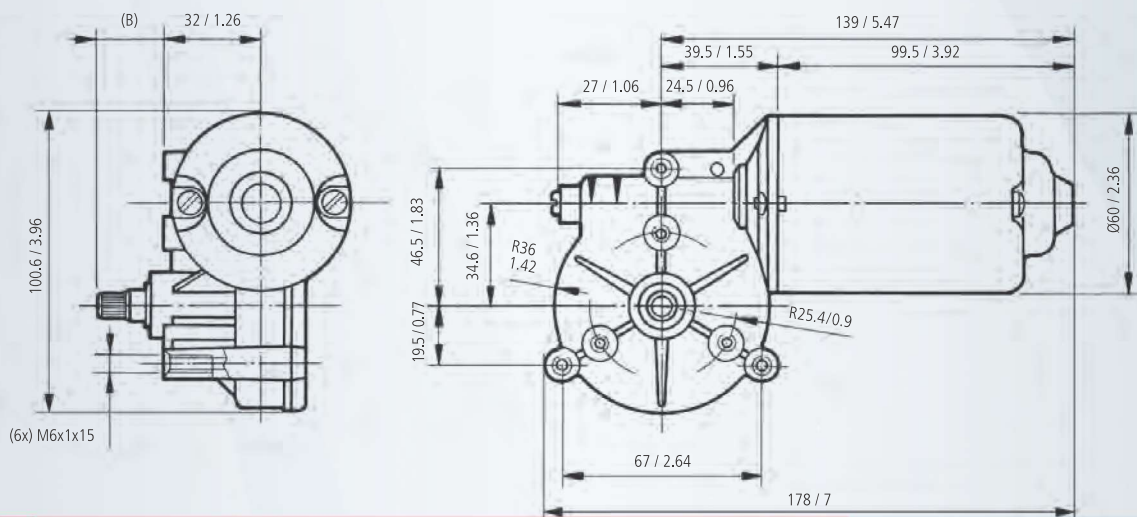

mm / inch

SHAFT EJE ARBRE WELLE

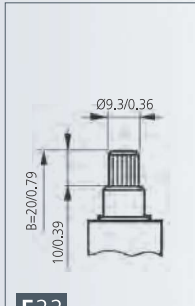

E22

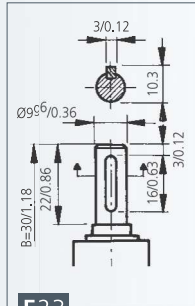

E23

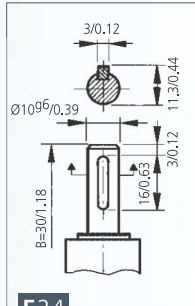

E24

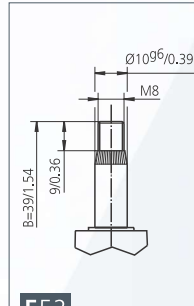

E52

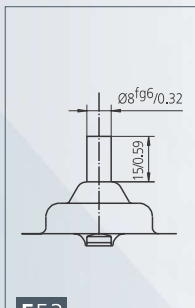

E53

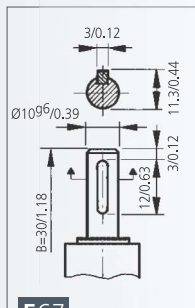

E67

CONNECTIONS CONEXIONES CONNEXIONS ANSCHLUSSART

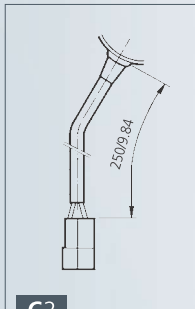

C2

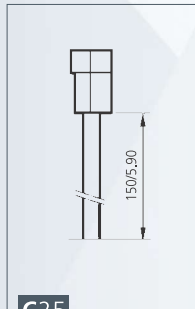

C25

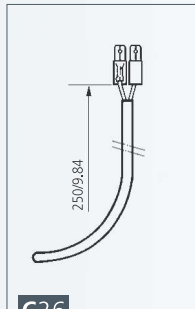

C26

WIRING DIAGRAM ESQUEMA ELÉCTRICO SCHEMA ÉLECTRIQUE SCHALTBILD

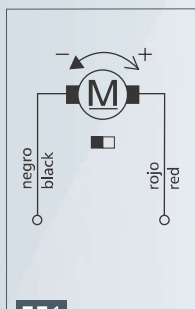

EE1

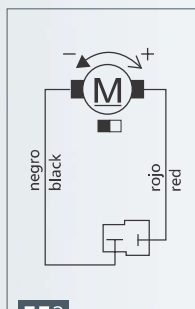

EE2

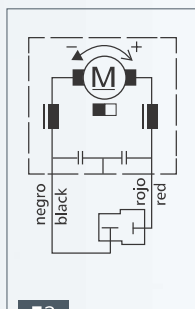

F2

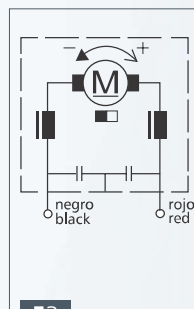

F3

CURVES CURVAS COURBES KURVEN

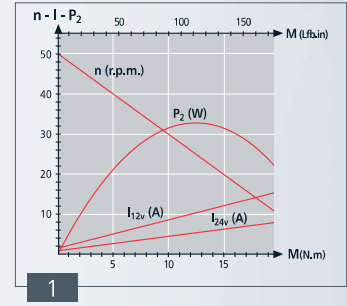

1

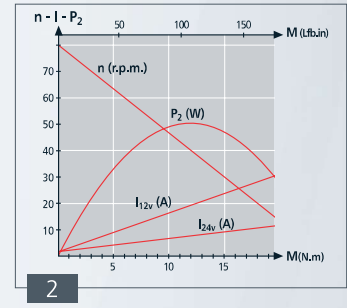

2

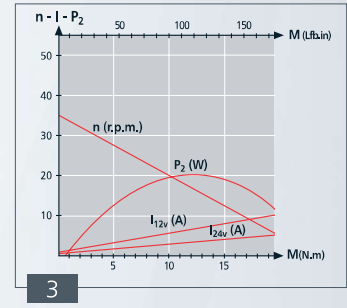

3

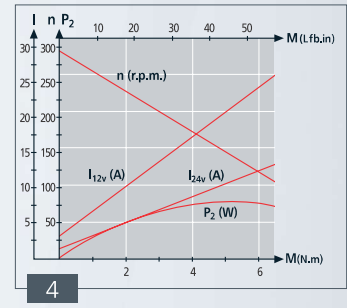

4

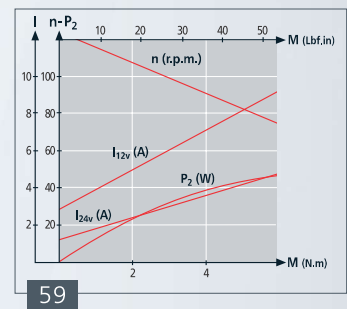

59