

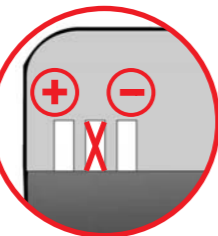

hähnel

hähnel
UniPal plus

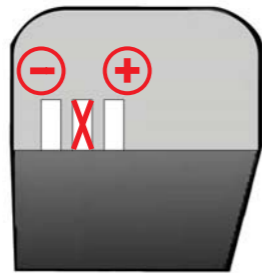

Check polarity of battery contacts
UniPal automatically detects
'+' or '-' polarity



IMPORTANT *
Contact pins must only
connect with '+' and '-'
contacts on battery.



Only 3.6/3.7V and 7.2/7.4V
Lithium Ion battery

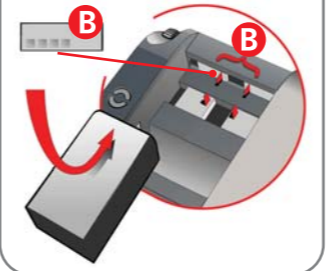
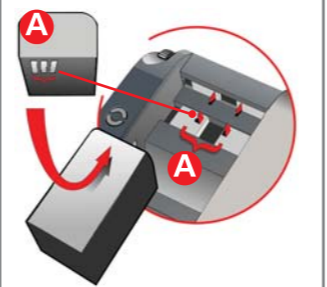
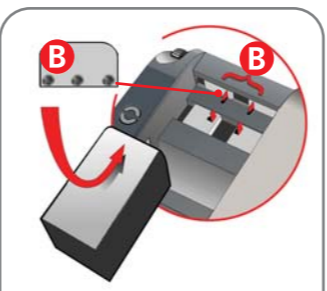

Connect Battery
to contacts



LCD Display indicates
charging status.
LCD can test battery
charge level before charging



All AA & AAA
Ni-MH batteries



LCD Display indicates
charging status.
LCD can test battery
charge level before charging



USB Port
5V / 500mA



