

Durchgangsleiste

Through-going block

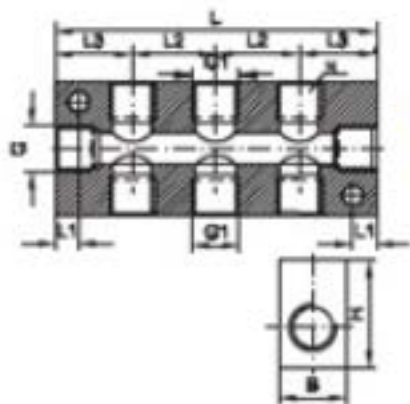

	G	G1	B	H	L1	L2	L3	L	N
61411	G ^{1/4}	G ^{1/8}	20	30	4,5	18	18	54	2+2
61412	G ^{1/4}	G ^{1/8}	20	30	4,5	18	18	72	3+3
61413	G ^{1/4}	G ^{1/8}	20	30	4,5	18	18	90	4+4
61414	G ^{1/4}	G ^{1/8}	20	30	4,5	18	18	108	5+5
61415	G ^{3/8}	G ^{1/4}	25	40	8,5	24	22	68	2+2
61416	G ^{3/8}	G ^{1/4}	25	40	8,5	24	22	92	3+3
61417	G ^{3/8}	G ^{1/4}	25	40	8,5	24	22	116	4+4
61418	G ^{3/8}	G ^{1/4}	25	40	8,5	24	22	140	5+5