



ASSEMBLY INSTRUCTION speakON System

NL2FC / NL4FC / NL8FC

NL2MP / NL4MP / NL8MPR

Kabelstecker | Cable Connector

Kabelvorbereitung Cable Preparation

NL2FC

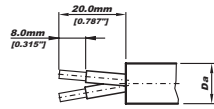

Da = 4.0 [0.157"] - 10.0 [0.394"]

NL4FC

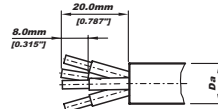

Da = 5.0 [0.197"] - 11.0 [0.433"]
... Spannzanze weiss; ... white chuck
Da = 9.5 [0.374"] - 15.0 [0.59"]
... Spannzanze schwarz

NL8FC

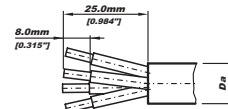

Da = 8.0 [0.315"] - 15.0 [0.591"]
... mit Reduziererring; ... with reducing sleeve
Da = 15.0 [0.591"] - 20.0 [0.787"]
... ohne Reduziererring; ... without reducing sleeve

Montage Assembling

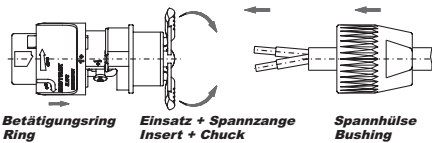

Betätigungsring Ring
Einsatz + Spannzanze Insert + Chuck
Spannhülse Bushing

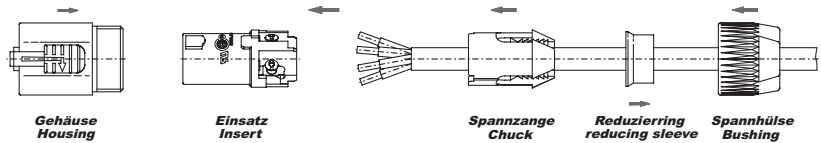

Gehäuse Housing
Einsatz Insert
Spannzanze Chuck
Reduziererring reducing sleeve (only to NL8FC)
Spannhülse Bushing

Verdrahtung Wiring

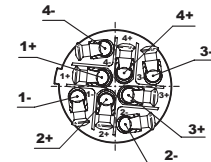
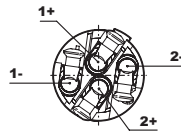
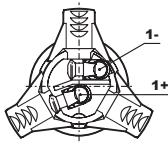

- Spannhülse auf Kabel schieben.
Put bushing onto the cable.
- Kabel lt. Anweisung vorbereiten.
Prepare cable as shown above.
- Drähte in die Klemmlöcher am Einsatz einführen und mit Schraube und Klemmblech mittels Schraubenzieher Pozidrive #1 befestigen.
Insert the wires into the terminals and fasten the clamping device with a screw driver Pozidrive #1.
- Betätigungsring in Richtung Spannzanze schieben.
Snap on locking ring into the chuck direction as shown above.
- Spannhülse mittels Gabelschlüssel SW 17mm fest anschrauben.
Fasten bushing by means of a fork wrench 11/16".

- Spannhülse u. Spannzanze auf Kabel schieben (Spannzanze kann auch nachträglich angebracht werden).
Put bushing and chuck onto the cable.
- Kabel lt. Anweisung vorbereiten.
Prepare cable as shown above.
- Drähte in die Klemmlöcher am Einsatz einführen und mit Schraube und Klemmblech mittels Schraubenzieher (Pozidrive®) befestigen.
Insert the wires into the terminals and fasten the clamping device by means screw driver (Pozidrive®).
- Einsatz und Spannzanze in das Gehäuse schieben (Führungsrippen und Führungsnut beachten!).
Push insert and chuck into housing (pay attention to the guiding keyway!).
- Spannhülse mittels Gabelschlüssel SW 19mm (NL8FC: SW 27mm) fest anschrauben.
Fasten bushing by means of a fork wrench 3/4".

Bedienung Handling

Einsteck-Vorgang Engagement

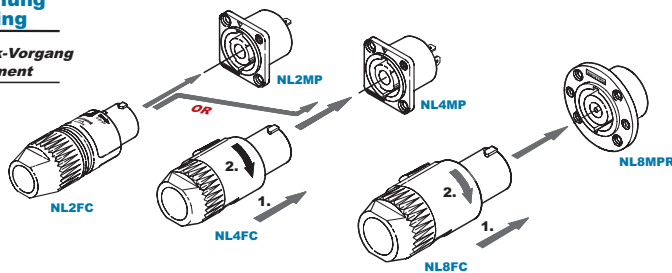

Aussteck-Vorgang Separation

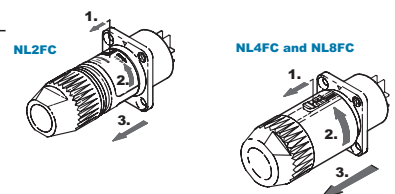

Not for use as mains (A.C.) connectors!

Gehäusestecker | Receptacle

Verdrahtung Wiring

NL2MP

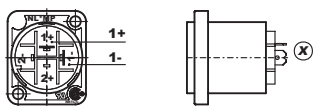

Frontplattenausschnitt (Rückseite)
Panel Cutout (Rear Side)

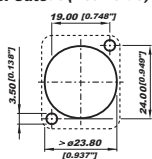

NL4MP

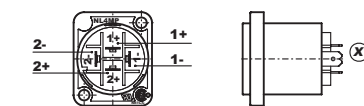

fur Flachsteckhülsen 4.8 mm x 0.5 mm
for flat quick-connect receptacles 0.187" x 0.020"

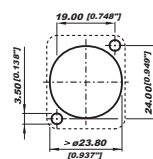

NL8MPR

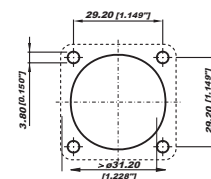
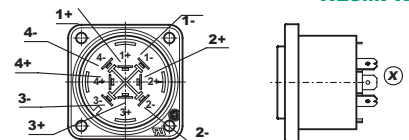

NEUTRIK AG
NEUTRIK Zürich AG
NEUTRIK USA Inc.
NEUTRIK (UK) Ltd.

LI T: +423 / 237 24 24 F: +423 / 232 53 93
CH T: +41 44 / 736 5010 F: +41 44 / 736 5011
USA T: +1 732 / 901 9488 F: +1 732 / 901 9608
UK T: +44 1983 / 811 441 F: +44 1983 / 811 439

NEUTRIK Vertriebs GmbH DE/NL/AT / DK T: +49 8131 / 280 890 F: +49 8131 / 280 830
NEUTRIK France FR T: +33 1 / 4131 6750 F: +33 1 / 4131 0511
NEUTRIK Tokyo Ltd. JP T: +81 3 / 3663 4733 F: +81 3 / 3663 4796
NEUTRIK Hong Kong Ltd. HK T: +852 / 2687 6055 F: +852 / 2687 6052

Draft. Nr.: BDA 072 / 3102M0711 | Update: 27.03.2009 | Data subject to change without prior notice. ©2009NEUTRIK®. ALL RIGHTS RESERVED.

www.neutrik.com

NEUTRIK