

C6_Amodul / C6_Amodul K

AWG 24/1 - 22/1, AWG 26/7 - 22/7

de Montagehinweis für den Installateur

en Mounting note for the installer

fr Notice d'installation pour l'installateur

Modul
130B11-E 180°



Modul
130B12-E 270°

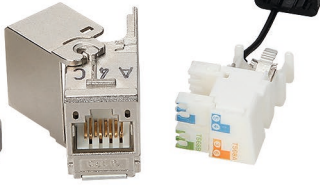

Modul
130B13-E 90°

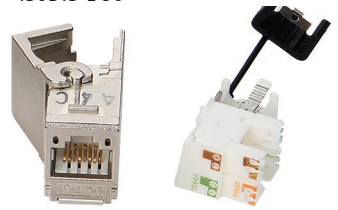

Keystone
130B21-E 180°



Keystone
130B22-E 270°



Keystone
130B23-E 90°



Anschlussbelegung / PIN assignments		
Affectation des brins		
PIN Nr. / No.	T568A	T568B
1	WH-GN	WH-OG
2	GN	OG
3	WH-OG	WH-GN
4	BU	BU
5	WH-BU	WH-BU
6	OG	GN
7	WH-BN	WH-BN
8	BN	BN



Kabel AWG 26!
Schirmgeflecht 5 mm über den Kabelmantel aufbringen.

Cable AWG 26!
Wrap the braided shield 5 mm over the cable sheath.

Câble AWG 26 !
Enrouler le blindage tressé 5 mm autour du gainage.

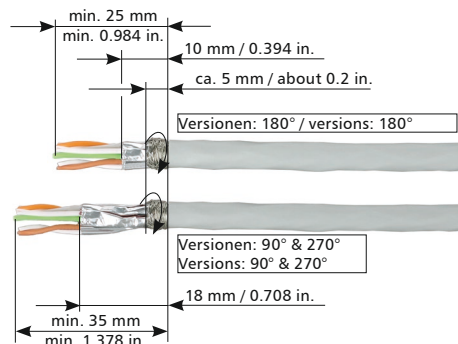

130B11-E / 130B21-E 180°	130B12-E / 130B22-E 270°	130B13-E / 130B23-E 90°
<p>1</p> <p>1-2 mm</p>	<p>a</p> <p>b</p> <p>1-2 mm</p>	<p>a</p> <p>b</p> <p>1-2 mm</p>
<p>2</p>	<p>a</p> <p>b</p>	<p>a</p> <p>b</p>
<p>3</p>	<p>3</p>	<p>3</p>
<p>4</p> <p>bündig abschneiden cut flush couper à ras</p>	<p>4</p> <p>bündig abschneiden cut flush couper à ras</p>	<p>4</p> <p>bündig abschneiden cut flush couper à ras</p>

5 ! **Nicht schräg einstecken! - Do not plug diagonally! - Ne pas insérer en diagonal !**

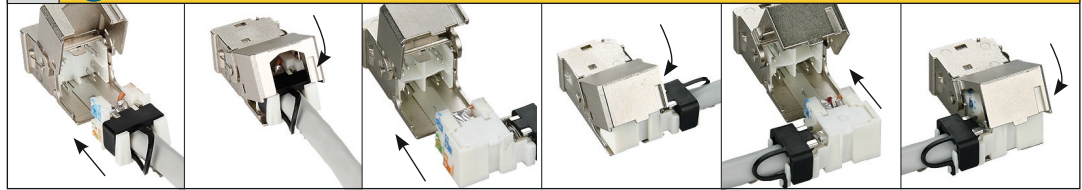

Potentialausgleich
Potential equalisation
Compensation de potentiel

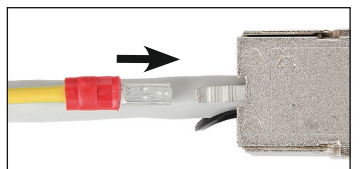

Optionaler Potentialausgleich mit 2,8 mm Flachstecker
Optional potential equalisation with 2.8 mm flat plug
Compensation de potentiel optionnelle par languette à 2,8 mm

Demontage / Disassembly / Démontage

